

0 SERIES FIXED

- Max output of 990lm at 80+ CRI
- Available with trimless and zero sightline baffles, featuring 0.5" aperture
- Available for Zero Sightline Millwork
- Available for remodel applications. See separate spec sheet

PROJECT NAME:	TYPE:
---------------	-------

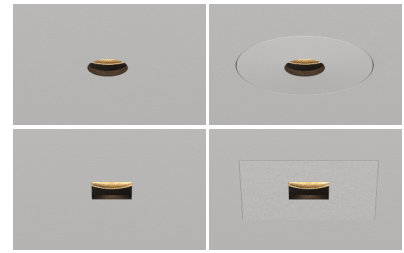

ORDERING INFORMATION - FIXTURE



JA8-2022 COMPLIANCE INDICATED BY SHADING

SHAPE	RATING	TYPE	BAFFLE & MOUNTING	EXTERIOR FINISH	INTERIOR FINISH	CRI	WATTAGE	CCT	OPTIC	MEDIA	INSTALL TYPE	CEILING THICKNESS	DRIVER
		F			BK							1	
ORM 1/2" Round Micro	1 IP20 Dry/Damp	F Fixed	T Trimless	TRIMLESS	BK Black	STATIC WHITE	TRIMLESS	24 2400K* 27 2700K 30 3000K 35 3500K 40 4000K	20 20° 30 30° 40 40°	NL No Lens 01 Clear Film* (Required for wet location)	INTEGRAL DRIVER IC IC AT IC, Airtight CP CCEA Chicago Plenum REMOTE DRIVER IR IC, Remote AR IC, Airtight, Remote CR CCEA Chicago Plenum, Remote	1 0.50" -1.50"	INTEGRAL / REMOTE PH1 Forward / Reverse Phase, 2%, 120V SG3 eldoLED, ECOdrive 1%, 0-10V, LOG, 120V-277V SN3 eldoLED, ECOdrive 1%, 0-10V, LIN, 120V-277V EG1 eldoLED, SOLOdrive 0.1% 0-10V, LOG, 120V-277V EN1 eldoLED, SOLOdrive 0.1% 0-10V, LIN, 120V-277V ED1 eldoLED, SOLOdrive 0.1% DALI-2, LOG, 120V-277V AS1 / ASR Athena Control eldoLED, SOLOdrive 0.1%, 120V-277V* CS1 / CSR Casambi Control eldoLED, SOLOdrive 0.1%, 120V-277V* REMOTE LP1 Lutron, Hi-Lume Premier Ecosystem 0.1% Fade to Black, 120V or 277V
OSM 1/2" Square Micro	2 IP64 Wet			TG Trimless Gypsum* (Required for trimless gypsum) ZERO SIGHTLINE POWDERCOAT WH White AG Satin Silver AU Cashmere Gold AB Architectural Bronze BB Burnt Bronze BK Black SB Specular Black PR Primer CF Custom Finish* (Consult Factory) ALUMINA 01 Brushed Obsidian 02 Matte Obsidian 03 Brushed Dark Patinated Bronze 04 Matte Dark Patinated Bronze 05 Brushed Aged Aluminum 06 Matte Aged Aluminum 07 Brushed Cast Brass 08 Matte Cast Brass 09 Brushed Light Patinated Bronze 10 Matte Light Patinated Bronze									

PART NUMBER NOTES

- Fixture ships as e.g., ORM1FTTGAUBK90S15C3540NLIC1SG3
- Housing, driver, trim, and applique ship as one unit



LUCIFER
LIGHTING COMPANY

luciferlighting.com

©2025 Lucifer® Lighting Company

As part of its policy of continuous research and product development, the company reserves the right to change or withdraw specifications without prior notice.

[PH] +1-210-227-7329
[FAX] +1-210-227-4967

pg. 1

[DATE OF REV: 02142025]

0 SERIES FIXED

ACCESSORIES

REPLACEMENT OPTICS

Interchangeable optics accessible through fixture aperture.

- ☐ **RO-17-20** 20° optic
- ☐ **RO-17-30** 30° optic
- ☐ **RO-17-40** 40° optic

REPLACEMENT BAFFLE ASSEMBLY (INCLUDES MEDIA)

ASSEMBLY	SHAPE	RATING	TYPE	BAFFLE	EXTERIOR FINISH	INTERIOR FINISH	MEDIA
RBA			F			BK	
REPLACEMENT BAFFLE ASSEMBLY	ORM Round OSM Round	1 IP20 Dry/Damp 2 IP64 Wet* * (Suction cup provided for aim and focus)	F Fixed	T Trimless G Zero Sightline M Trimless Millwork	TG Trimless Gypsum TM Trimless Millwork WH White AG Satin Silver AU Cashmere Gold AB Arch. Bronze BB Burnt Bronze BK Black PR Primer CF Custom Finish * * (Consult Factory) *See page 1 for Alumina finish options	BK Black	NL No Lens 01 Clear Glass Lens

REPLACEMENT INSTALLATION TOOLS

One included with every six fixtures designated Wet location.

- ☐ **01S-TOOL-BAFFLE-REMOVAL** Allows for removal of baffle with Wet location
- ☐ **01S-TOOL-ENGINE-INST-REMOVAL** Allows for installation of LED module
- ☐ **01S-TOOL-ENGINE-BAFFLE-COMBO** Includes both baffle removal tool and LED module installation tool.

HANGER BAR EXTENDER KIT

Extends hanger bars from 24.0" to 46.0" maximum.

- ☐ **FRX-HBE-46** Extender, Hanger Bar

EMERGENCY LIGHTING - REMOTE MOUNT ONLY

During disruption of main power, emergency battery inverter provides temporary 120V or 277V to fixture.

- ☐ **EMB-S-25-120/277-LEDX** 25 watt max capacity, 120 or 277 VAC 60Hz, Non-Dimmable
- ☐ **EMB-S-100-120-LEDX** 100 watt max capacity, 120 VAC 60Hz, 0-10V Dimmable
- ☐ **EMB-S-100-277-LEDX** 100 watt max capacity, 277 VAC 60Hz, 0-10V Dimmable
- ☐ **EMB-S-250-120/277-LEDX** 250 watt max capacity, 120 or 277 VAC 60Hz, 0-10V Dimmable

***SHUNT REQUIRED FOR USE WITH ATHENA AND CASAMBI CONTROLS, CONSULT FACTORY FOR DETAILS.**

POWDERCOAT FINISHES

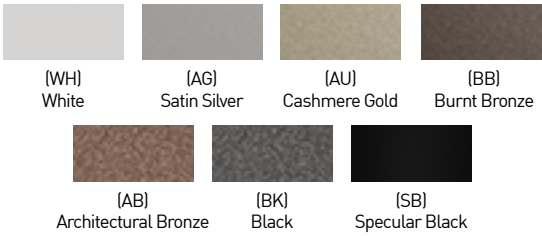

ALUMINA FINISHES BY LUCIFER LIGHTING™



PERFORMANCE -TRIMLESS - 3000K - NO LENS

LUMEN PACKAGE	WATTS	20° OPTIC		30° OPTIC		40° OPTIC	
		DLVD	LPW	DLVD	LPW	DLVD	LPW
80S06C	6	215	36	389	65	481	80
80S11C	11	327	30	592	54	733	67
80S15C	15	435	29	787	52	974	65
90S06C	6	186	31	336	56	416	69
90S11C	11	283	26	512	47	634	58
90S15C	15	376	25	680	45	845	56
95S06C	6	134	22	242	40	299	50
95S11C	11	203	18	368	33	455	41
95S15C	15	270	18	489	33	605	40

OUTPUT MULTIPLIER	
CCT	CCT SCALE
2400K	0.89
2700K	0.98
3000K	1.00
3500K	1.09
4000K	1.14

MEDIA LIGHT LOSS MULTIPLIER	
MEDIA	LIGHT LOSS FACTOR
NO LENS	1.00
LENS	0.93

PERFORMANCE -ZERO SIGHTLINE - 3000K - NO LENS

LUMEN PACKAGE	WATTS	20° OPTIC		30° OPTIC		40° OPTIC	
		DLVD	LPW	DLVD	LPW	DLVD	LPW
80S06C	6	234	39	407	68	490	82
80S11C	11	357	32	620	56	745	68
80S15C	15	474	32	824	55	990	66
90S06C	6	203	34	352	59	423	71
90S11C	11	309	28	536	49	644	59
90S15C	15	410	27	712	47	856	57
95S06C	6	146	24	253	42	304	51
95S11C	11	222	20	385	35	463	42
95S15C	15	295	20	512	34	615	41

FINISH MULTIPLIER	
CCT	CCT SCALE
WHITE	1.00
BLACK	0.98
SPECULAR BLACK	0.98

 JA8-2022 INDICATED BY SHADING

0 SERIES FIXED

DOWNLIGHT / HOUSING

A IC HOUSING

- For IC ceilings, also suitable for NC applications.
- No setback from polycell spray foam insulation having max R-Value of 60 on all sides and top of housing.
- Pre-installed collar accommodates ceiling thicknesses up to 1.50". Requires 3.125" ceiling cutout.

B LIGHT ENGINE

Robust light engine with optimized optic pairing integrates Reflection, Refraction, and TIR offering 20°, 30°, and 40° beams.

C TRIMLESS MILLWORK / ZERO SIGHTLINE MILLWORK SPACERS & MOUNTING ADAPTOR

Provided for Trimless Millwork (Type "M") installations; includes (1) 1/16" spacer and (5) 1/8" spacers.

D ZERO-SIGHTLINE / TRIMLESS DRYWALL PROFILE

Installs totally flush with the ceiling with no visible trim. Appliqué includes screws for mounting and has 0.06" plaster stop. Not recommended for stucco applications.

E ZERO-SIGHTLINE FACEPLATE / BAFFLE

CNC-Milled removable baffle provides 64° glare cutoff. Minimizes aperture glare and conceals view into housing; includes gasket. Exterior faceplate available in powdercoat finishes; interior finish is black powdercoat.

F TRIMLESS BAFFLE

CNC-Milled baffle provides 61° glare cutoff. Minimizes aperture glare and conceals view into housing; includes gasket. Baffle shape is square for both round and square apertures. Only 0.5" inner aperture is visible after mud-in. **1.7" square ceiling break required for LED/driver servicing.**

G APPLIQUÉ DETAIL

Appliqué for plaster floating directly to baffle.

DIMENSIONS / DRAWINGS

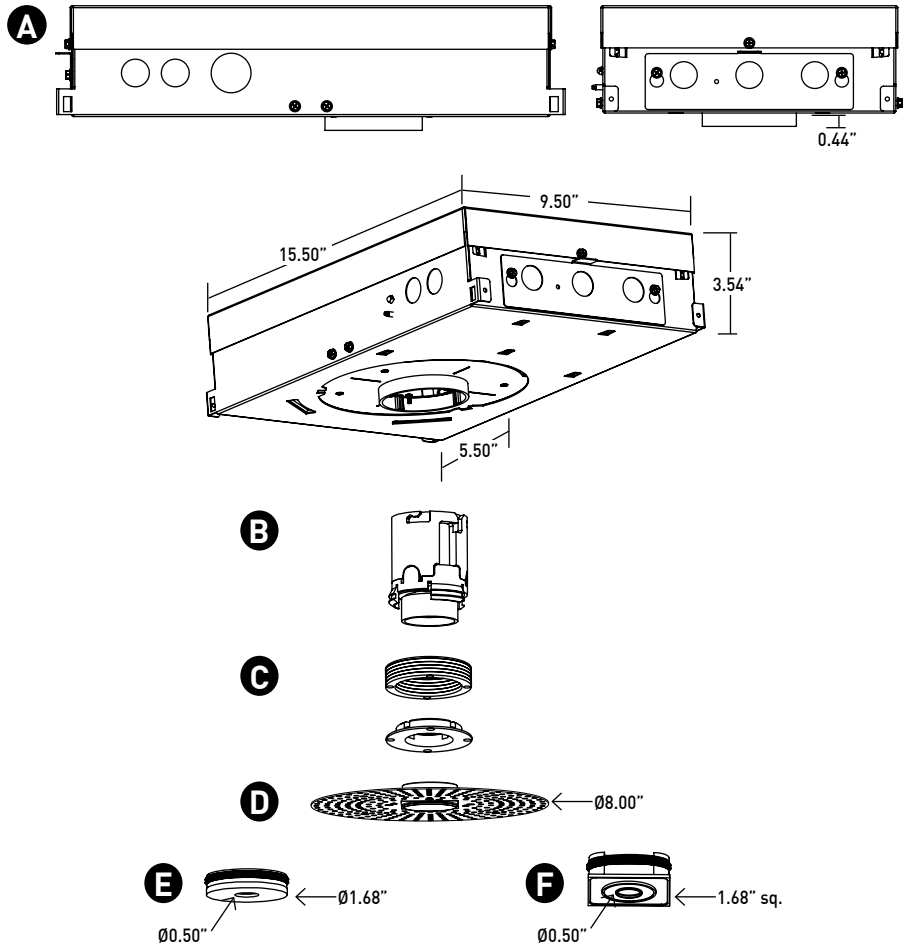

HOUSING NOTES

- Power supply compartment and all splice connections may be serviced from room side.
- Consult factory for spacing requirements for any installations exceeding R-Value 60.
- Hanger bars extend from 14.0" to 24.0", but may be field cut to accommodate narrow stud spacing. Can be extended up to 46" maximum with FRX-HBE-46 kit.
- Hanger bars and brackets add 4.00" max to the overall dimension, but are exclusive of the setback requirements.
- Housings for round and square trims feature a round aperture housing collar that rotates up to 90 degrees for square fixture alignment. Housing collars accommodate ceiling thicknesses between 0.50" and 1.50".

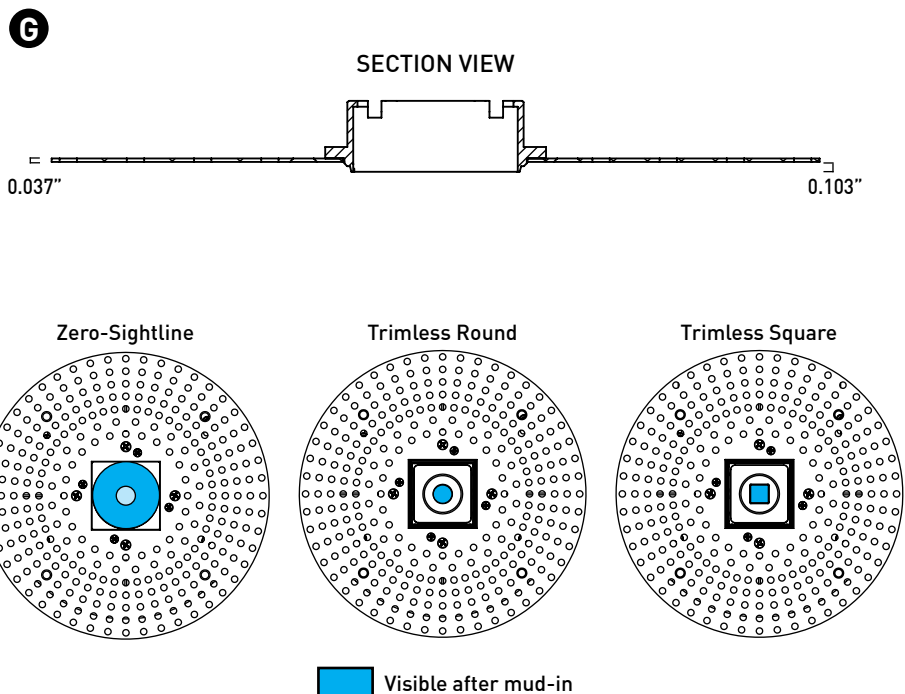

0 SERIES FIXED

DOWNLIGHT / HOUSING

- H

TRIMLESS MILLWORK

Installs totally flush with the ceiling with no visible trim. Requires the spacers and adaptor specified with "M" installation type.
- I

REMOTE POWER SUPPLY

Provided with install Types "IR", "NR", "AR" and "CR". Remote power supply provides additional driver options. See page 6 for maximum allowable secondary run lengths between PS-RMT and fixture. Must be installed in an accessible location.
- J

ATHENA / CASAMBI CONTROL

Controls integrated Remote driver assembly. All equipment is serviceable.

Athena Model Numbers: A-WN-D01-RF-BL & DFC-OEM-DBI

Casambi Model Number: BT-S1E1-5400
- K

ATHENA / CASAMBI EM SHUNT

Inlcuded with drivers specified as ASR, ADR, CSR, or CDR. One required for each wireless EM fixture, requires class 2 control wiring between fixture and shunt. Features integrated test switch.

Model Number: PS-RMT-SHUNT

DIMENSIONS / DRAWINGS

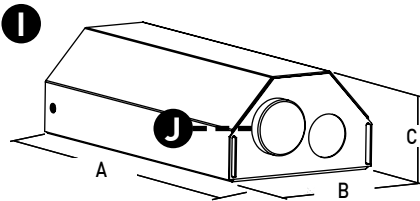
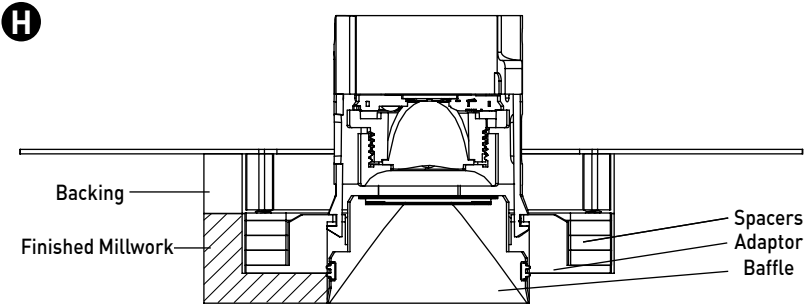

	A	B	C
PHASE / 0-10V / DALI / ECOSYSTEM	6.94"	3.35"	2.00"
ATHENA / CASAMBI	8.10"	5.00"	2.00"

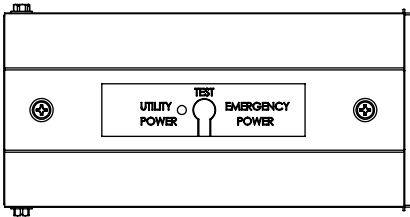
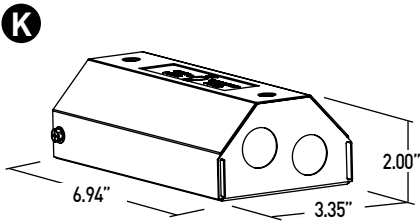

0 SERIES FIXED

TECHNICAL

CONSTRUCTION

Downlight: Painted finishes are granulated powder coat; Alumina finishes are anodized aluminum. Plated finishes are plated.

Housing: Aluminum and 22 Gauge galvanized steel. Forged aluminum heat-sink.

Remote Power Supply: 22 Gauge galvanized steel.

Appliqué: Aluminum base with 22 Gauge galvanized steel flange.

STATIC WHITE LED

2-step MacAdam ellipse LED module available in 80+, 90+, and 95+ CRI configurations in color temperatures of 2700K, 3000K, 3500K and 4000K. 3-step MacAdam ellipse LED module available in 90+ CRI configuration in color temperature of 2400K. Average rated lamp life of 50,000 hours. LED and driver assemblies are field-replaceable.

POWER SUPPLY PERFORMANCE AND DIMMING INFORMATION

	PHASE	0-10V				ECO	DALI-2	ATHENA		CASAMBI	
Power Supply	PH1	SG3	SN3	EG1	EN1	LP1	ED1	AS1	AD1	CS1	CD1
Minimum °C	-20 °C	-20 °C	-20 °C	-20 °C	-20 °C	0 °C	-20 °C	0 °C	0 °C	-20 °C	-20 °C
Maximum °C	40 °C	40 °C	40 °C	40 °C	40 °C	40 °C	40 °C	40 °C	40 °C	40 °C	40 °C
Dimming %	2.0%	1.0%	1.0%	0.1%	0.1%	0.1%	0.1%	0.1%	0.1%	0.1%	0.1%

Note: For LP1, EG1 and EN1 drivers consult chart on page 7 to confirm appropriate dimming curve for compatibility with selected control.

MAXIMUM ALLOWABLE REMOTE DRIVER WIRING DISTANCES

DRIVER	WIRE AWG				
	12	14	16	18	20
PH1	285'	180'	113'	71'	45'
LP1	60'	40'	25'	15'	-
EG1, EN1, ED1, SG3, SN3, AS1, CS1, AD1, CD1	-	-	118'	72'	46'

LISTING

Pending listing to UL1598 standard for Dry / Damp IP20 and IP64 Wet locations. CCEA, Airtight, and Title 24 JA8-2022 Listing. NEMA 410 Compliant.

DECLARE

LBC Red List Approved.

BUY AMERICAN ACT

Buy American Act compliant.

WEIGHT

Housing with Integral Driver - 7 lbs max

Remote Driver - 1.4 lbs

LIMITED WARRANTY

Manufacturer's Limited Warranty guarantees product(s) listed to be free from defects in material and workmanship under normal use and service for 1-year. LED and power supplies are warranted to operate with 70% of original flux and remain within a range of 3 duv for a period of 5-years. 10-year Lutron Advantage limited warranty available on Lutron equipped systems. Warranty period begins from the date of shipment by Seller. [Consult website for full warranty terms and conditions.](#)

DIMMING COMPATIBILITY

LUTRON DRIVER COMPATIBILITY

Power supply LP1 Lutron Product Family	Part No.
PowPak Dimming Modules	RMJ-EC032-DV-B
PowPak Dimming Modules	FCJ/FCJS-ECO
Energi Savr Nodes	QSN-1ECO-S
GRAFIK Eye QS control unit	QSN-2ECO-S
Homeworks QS control unit	QSGRJ- _E (wireless) QSGR- _E
Quantum Hub	QP2- _ _ 2C
Quantum Hub	QP2- _ _ 4C
Quantum Hub	QP2- _ _ 6C
Quantum Hub	QP2- _ _ 8C
Homeworks QS power module	LQSE-2ECO-D
myRoom Plus power module	



elidoLED DRIVER COMPATIBILITY

Power supply EG1/SG3 Manufacturer	Family/Model #
Busch-Jaeger	2112U-101
Jung	240-10
Leviton Lighting Controls	IP710-DLX
Lightolier Controls	ZP600FAM120
Merten	5729
Pass & Seymour	CD4FB-W
The Watt Stopper	DCLV1
Synergy	ISD BC
Crestron®	GLX-DIMFLV8
Crestron®	GLXP-DIMFLV8
Crestron®	GLPAC-DIMFLV4-*
Crestron®	GLPAC-DIMFLV8-*
Crestron®	GLPP-DIMFLVEX-PM
Crestron®	GLPP-1DIMFLV2EX-PM
Crestron®	GLPP-1DIMFLV3EX-PM
Crestron®	DIN-A08
Crestron®	DIN-4DIMFLV4
Crestron®	CLS-EXP-DIMFLV
Crestron®	CLCI-1DIMFLV2EX
Power supply EN1/SN3 Manufacturer	Family/Model #
Lutron Electronics	Nova T® - NTFTV
Lutron Electronics	Diva® - DVTV
Lutron Electronics	Nova® - NFTV
Lutron Electronics	GrafixEye® GRX-TVI w GRX3503
Lutron Electronics	Energy Savr Node™ - QSN-4T16-S
Lutron Electronics	TVM2 Module
Sensor Switch	nIO EZ
ABB	SD/S 2.16.1

ANALOG DRIVERS AND DIMMERS

