

0 SERIES INT
FIXED

PROJECT NAME:

TYPE:

- Max output of 990Lm at 80+ CRI
- Available with trimless and zero sightline baffles, featuring 0.5" (13mm) aperture

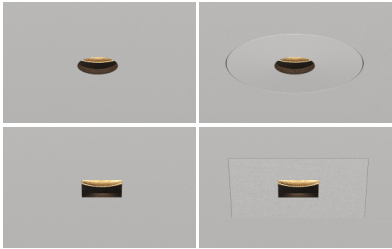

ORDERING INFORMATION - FIXTURE

TRIM	RATING	TYPE	BAFFLE & MOUNTING	EXTERIOR FINISH	INTERIOR FINISH	CRI	WATTAGE	CCT	OPTIC	MEDIA	INSTALL TYPE	CEILING THICKNESS	DRIVER
		F			BK							1	
ORM 1/2" (13mm) Round Micro	1 IP20 Dry/Damp	Fixed	T Trimless	TRIMLESS TG Trimless Gypsum* *(Required for trim-less gypsum)	BK Black	80S 80+ CRI 90S 90+ CRI 95S 95+ CRI	STATIC WHITE			NL No Lens 01 Clear Film* *(Required for wet location)	EXPORT (REMOTE DRIVER) EX Export Remote EN Export NOM EB Export BIS HOUSING (TETHERED DRIVER) HX Housing Export HN Export NOM HB Housing BIS	1 13mm - 38mm	IG1 eldoLED, SOLOdrive 0.1% 0-10V, LOG, 120V-277V IN1 eldoLED, SOLOdrive 0.1% 0-10V, LIN, 120V-277V ID1 eldoLED, SOLOdrive 0.1% DALI-2, LOG, 120V-277V HUB Distributed Power System, Powers up to 6 Fixtures* *(Requires further specification on page 2)
OSM 1/2" (13mm) Square Micro	2 IP64 Wet		G Zero Sightline Gypsum	POWDERCOAT WH White AG Satin Silver AU Cashmere Gold AB Architectural Bronze BB Burnt Bronze BK Black SB Specular Black PR Primer CF Custom Finish * *(Consult Factory) ALUMINA 01 Brushed Obsidian 02 Matte Obsidian 03 Brushed Dark Patinated Bronze 04 Matte Dark Patinated Bronze 05 Brushed Aged Aluminum 06 Matte Aged Aluminum 07 Brushed Cast Brass 08 Matte Cast Brass 09 Brushed Light Patinated Bronze 10 Matte Light Patinated Bronze	FINISH IMAGES ON PAGE 2		90L 90+ CRI						
							TRIMLESS			40 40°			
							11D 11W 15D 15W Incandescent Profile 11W - 373 Lm 15W - 493 Lm			WL 2700K-1800K			
							Halogen Profile 11W - 395 Lm 15W - 525 Lm			WD 3000K-1800K			
							ZERO SIGHTLINE						
							11D 11W 15D 15W Incandescent Profile 11W - 384 Lm 15W - 508 Lm			WL 2700K-1800K			
							Halogen Profile 11W - 406 Lm 15W - 540 Lm			WD 3000K-1800K			
							DELIVERED LUMEN OUTPUTS REFLECT 80CRI OR WARM DIM, 3000K, 40° OPTIC, AND NO LENS.						

PART NUMBER NOTES

- Fixture ships as e.g., 0RM1FTTGAUBK90S15C3540NLEX1IG1
- Housing, driver, trim, and applique ship as one unit

0 SERIES INT FIXED

ACCESSORIES

CONFIGURATION - REQUIRED FOR 'HUB' DRIVER SPECIFICATION

ASSEMBLY	QTY	WATTAGE	REMOTE DRIVER
HUB			
DISTRIBUTED POWER HUB	2X 2 Fixtures	06W 6 Watts	IG1 eldoLED, SOLOdrive 0.1%, 0-10V, LOG, 120V-277V
	3X 3 Fixtures	11W 11 Watts	IN1 eldoLED, SOLOdrive 0.1%, 0-10V, LIN, 120V-277V
	4X 4 Fixtures	15W 15 Watts	ID1 eldoLED, SOLOdrive 0.1%, DALI-2, LOG, 120V-277V
	5X 5 Fixtures		
	6X 6 Fixtures		

PART NUMBER NOTES

- Configuration e.g.HUB2X15W-IG1, ordered as separate line item

ACCESSORIES

REPLACEMENT OPTICS

Interchangeable optics accessible through fixture aperture.

- STATIC WHITE
- WARM DIM
- ☐ RO-17-20 20° optic
- ☐ RO-17-30 30° optic
- ☐ RO-17-40 40° optic
- ☐ RO-17-40-W 40° optic

REPLACEMENT BAFFLE ASSEMBLY (INCLUDES MEDIA)

ASSEMBLY	SHAPE	RATING	TYPE	BAFFLE	EXTERIOR FINISH	INTERIOR FINISH	MEDIA
RBA			F			BK	
REPLACEMENT BAFFLE ASSEMBLY	ORM Round OSM Round	1 IP20 Dry/Damp 2 IP64 Wet* * (Baffle removal tool provided for aim and focus)	F Fixed	T Trimless G Zero Sightline Gypsum M Zero Sightline Millwork	TG Trimless Gypsum WH White AG Satin Silver AU Cashmere Gold AB Arch. Bronze BB Burnt Bronze BK Black PR Primer CF Custom Finish* * (Consult Factory) **See page 1 for Alumina finish options	BK Black	NL No Lens 01 Clear Glass Lens

REPLACEMENT INSTALLATION TOOLS

One included with every six fixtures designated Wet location.

- ☐ 01S-TOOL-BAFFLE-REMOVAL
- Allows for baffle removal with Wet location
- ☐ 01S-TOOL-ENGINE-INST-REMOVAL
- Allows for installation of LED module
- ☐ 01S-TOOL-ENGINE-BAFFLE-COMBO
- Includes both baffle removal tool and LED installation tool

HANGER BAR EXTENDER KIT

Extends hanger bars from 24.0" to 46.0" maximum.

- ☐ FRX-HBE-46
- Extender, Hanger Bar

COMPATIBILITY BY DRIVER TYPE AND QUANTITY

DRIVER	HUB2X			HUB3X			HUB4X			HUB5X			HUB6X		
	06W	11W	15W	06W	11W	15W	06W	11W	15W	06W	11W	15W	06W	11W	15W
IG/IN/ID	✓	✓	✓	✓	✓	✓	✓	✓		✓			✓		

POWDERCOAT FINISHES

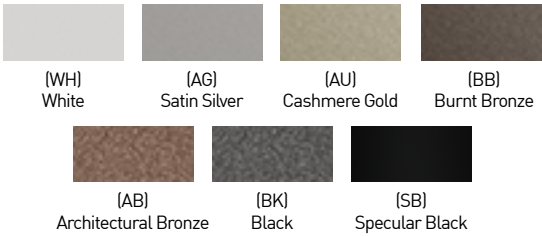

ALUMINA FINISHES BY LUCIFER LIGHTING™



0 SERIES INT FIXED

PERFORMANCE - TRIMLESS - 3000K - NO LENS

LUMEN PACKAGE	WATTS	20° OPTIC		30° OPTIC		40° OPTIC	
		DLVD	LPW	DLVD	LPW	DLVD	LPW
80S06C	6	215	36	389	65	481	80
80S11C	11	327	30	592	54	733	67
80S15C	15	435	29	787	52	974	65
90S06C	6	186	31	336	56	416	69
90S11C	11	283	26	512	47	634	58
90S15C	15	376	25	680	45	845	56
95S06C	6	134	22	242	40	299	50
95S11C	11	203	18	368	33	455	41
95S15C	15	270	18	489	33	605	40
90L11DL (27K-18K)	11	-	-	-	-	373	34
90L11DD (30K-18K)	11	-	-	-	-	493	33
90L15DL (27K-18K)	15	-	-	-	-	395	36
90L15DD (30K-18K)	15	-	-	-	-	525	35

OUTPUT MULTIPLIER

CCT	CCT SCALE
2400K	0.89
2700K	0.98
3000K	1.00
3500K	1.09
4000K	1.14

MEDIA LIGHT LOSS MULTIPLIER

MEDIA	LIGHT LOSS FACTOR
NO LENS	1.00
LENS	0.93

FINISH MULTIPLIER

CCT	CCT SCALE
WHITE	1.00
BLACK	0.98
SPECULAR BLACK	0.98

WARM DIM PERFORMANCE - NO LENS - 40° OPTIC

INCANDESCENT PROFILE - TRIMLESS

90L11DL 2700K - 1800K	Full on 100%	Dimmed to 80%	Dimmed to 70%	Dimmed to 50%	Dimmed to 20%	Dimmed to 10%	Dimmed to 2%
CCT (K)	2700K	2700K	2700K	2700K	2500K	1900K	1800K
Light Output (Lm)	373	298	261	187	75	37	7
Power (W)	11	8.8	7.7	5.5	2.2	1.1	0.2
Efficacy (LPW)	34	34	34	34	34	34	34
90L15DL 2700K - 1800K	Full on 100%	Dimmed to 80%	Dimmed to 70%	Dimmed to 50%	Dimmed to 20%	Dimmed to 10%	Dimmed to 2%
CCT (K)	2700K	2700K	2700K	2700K	2500K	1900K	1800K
Light Output (Lm)	395	316	277	198	79	40	8
Power (W)	15	12	10.5	7.5	3	1.5	0.3
Efficacy (LPW)	36	36	36	36	36	36	36

HALOGEN PROFILE - TRIMLESS

90L11DD 3000K - 1800K	Full on 100%	Dimmed to 80%	Dimmed to 70%	Dimmed to 50%	Dimmed to 20%	Dimmed to 10%	Dimmed to 2%
CCT (K)	3000K	3000K	3000K	3000K	3000K	2000K	1800K
Light Output (Lm)	493	394	345	247	99	49	10
Power (W)	11	8.8	7.7	5.5	2.2	1.1	0.2
Efficacy (LPW)	33	33	33	33	33	33	33
90L15DD 3000K - 1800K	Full on 100%	Dimmed to 80%	Dimmed to 70%	Dimmed to 50%	Dimmed to 20%	Dimmed to 10%	Dimmed to 2%
CCT (K)	3000K	3000K	3000K	3000K	3000K	2000K	1800K
Light Output (Lm)	525	420	368	263	105	53	11
Power (W)	15	12	10.5	7.5	3	1.5	0.3
Efficacy (LPW)	35	35	35	35	35	35	35

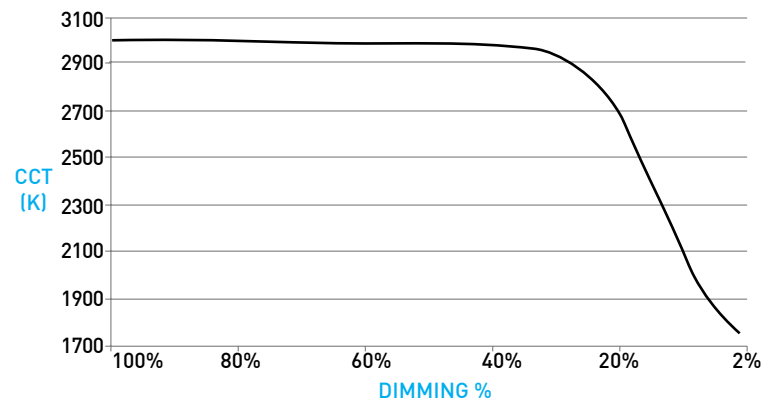
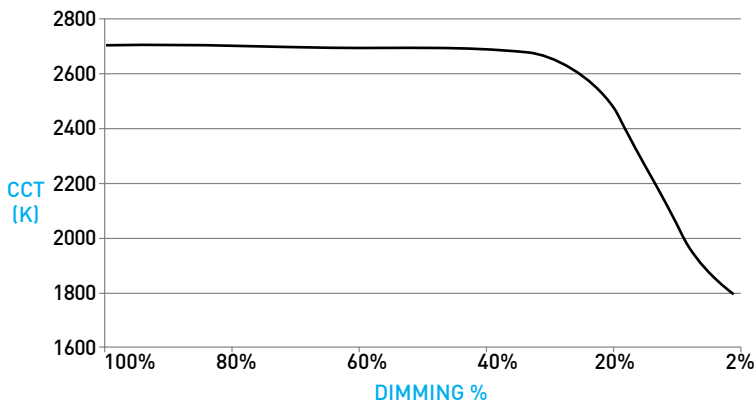

NOTE: LIN-TO-LIN 0-10V PAIRING NOT COMPATIBLE WITH WARM DIM.

0 SERIES INT FIXED

PERFORMANCE -ZERO SIGHTLINE - 3000K - NO LENS

LUMEN PACKAGE	WATTS	20° OPTIC		30° OPTIC		40° OPTIC	
		DLVD	LPW	DLVD	LPW	DLVD	LPW
80S06C	6	234	39	407	68	490	82
80S11C	11	357	32	620	56	745	68
80S15C	15	474	32	824	55	990	66
90S06C	6	203	34	352	59	423	71
90S11C	11	309	28	536	49	644	59
90S15C	15	410	27	712	47	856	57
95S06C	6	146	24	253	42	304	51
95S11C	11	222	20	385	35	463	42
95S15C	15	295	20	512	34	615	41
90L11DL (27K-18K)	11	-	-	-	-	384	37
90L11DD (30K-18K)	11	-	-	-	-	406	37
90L15DL (27K-18K)	15	-	-	-	-	508	34
90L15DD (30K-18K)	15	-	-	-	-	540	36

OUTPUT MULTIPLIER	
CCT	CCT SCALE
2400K	0.89
2700K	0.98
3000K	1.00
3500K	1.09
4000K	1.14

MEDIA LIGHT LOSS MULTIPLIER	
MEDIA	LIGHT LOSS FACTOR
NO LENS	1.00
LENS	0.93

FINISH MULTIPLIER	
CCT	CCT SCALE
WHITE	1.00
BLACK	0.98
SPECULAR BLACK	0.98

WARM DIM PERFORMANCE - NO LENS - 40° OPTIC

INCANDESCENT PROFILE - ZERO SIGHTLINE

90L11DL 2700K - 1800K	Full on 100%	Dimmed to 80%	Dimmed to 70%	Dimmed to 50%	Dimmed to 20%	Dimmed to 10%	Dimmed to 2%
CCT (K)	2700K	2700K	2700K	2700K	2200K	1900K	1800K
Light Output (Lm)	384	307	269	192	77	38	8
Power (W)	11	8.8	7.7	5.5	2.2	1.1	0.2
Efficacy (LPW)	37	37	37	37	37	37	37
90L15DL 3000K - 1800K	Full on 100%	Dimmed to 80%	Dimmed to 70%	Dimmed to 50%	Dimmed to 20%	Dimmed to 10%	Dimmed to 2%
CCT (K)	2700K	2700K	2700K	2700K	2450K	1900K	1800K
Light Output (Lm)	508	406	356	254	102	51	10
Power (W)	15	12	10.5	7.5	3	1.5	0.3
Efficacy (LPW)	37	37	37	37	37	37	37

HALOGEN PROFILE - ZERO SIGHTLINE

90L11DD 3000K - 1800K	Full on 100%	Dimmed to 80%	Dimmed to 70%	Dimmed to 50%	Dimmed to 20%	Dimmed to 10%	Dimmed to 2%
CCT (K)	3000K	3000K	3000K	3000K	2300K	1850K	1800K
Light Output (Lm)	406	325	284	203	81	41	8
Power (W)	11	8.8	7.7	5.5	2.2	1.1	0.2
Efficacy (LPW)	36	36	36	36	36	36	36
90L15DD 3000K - 1800K	Full on 100%	Dimmed to 80%	Dimmed to 70%	Dimmed to 50%	Dimmed to 20%	Dimmed to 10%	Dimmed to 2%
CCT (K)	3000K	3000K	3000K	3000K	2700K	1900K	1800K
Light Output (Lm)	540	432	378	270	108	54	11
Power (W)	15	12	10.5	7.5	3	1.5	0.3
Efficacy (LPW)	36	36	36	36	36	36	36

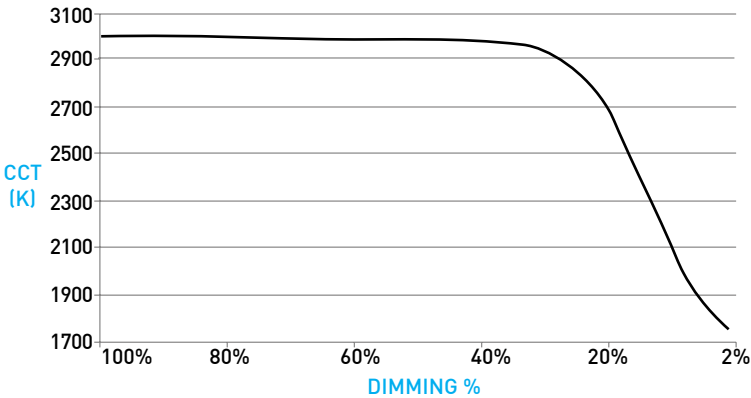
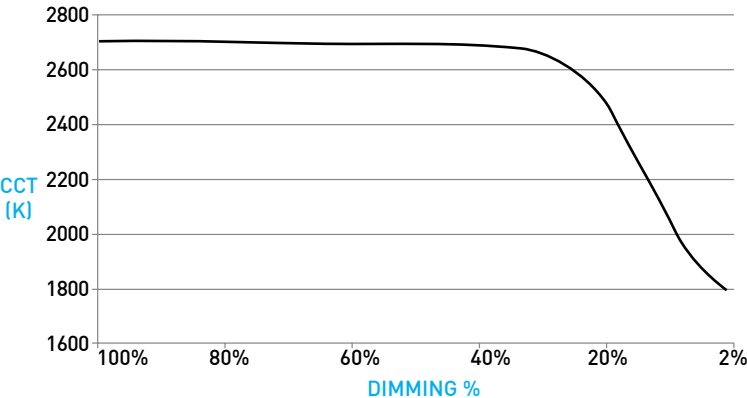

NOTE: LIN-TO-LIN 0-10V PAIRING NOT COMPATIBLE WITH WARM DIM.

0 SERIES INT FIXED

DOWNLIGHT / HOUSING

A HIGH/LOW WATTAGE REMODEL HOUSING

- For remote installation types.
- IC-rated heatsink, does not have any setback requirements from combustible and non-combustible materials.
- High wattage housing features 54mm tall heat sink and is available for 15W packages.
- Low wattage housing features 35mm tall heat sink and is available for 6W and 11W packages only.

B LIGHT ENGINE

Robust light engine with optimized optic pairing integrates Reflection, Refraction, and TIR offering 20°, 30°, and 40° beams.

C REMODEL MOUNTING PLATE / ROUGH-IN TRAY

Tray is supplied with optional hanger bars (uninstalled). Mounting holes align with applique, ensuring secure fixture mounting via factory supplied screws.

- Remodel:** Installs above ceiling without hanger bars, requiring Ø168mm cutout. Rectangular design (157mm x 191mm) allows for installation above ceiling after cutout
- Rough-In:** Install hanger bars using factory supplied screws, using tray opening as cutout guide after ceiling installation. Hanger bars extend to 24".

D ZERO-SIGHTLINE / TRIMLESS DRYWALL PROFILE

Installs totally flush with the ceiling with no visible trim. Applique includes screws for mounting and has 1.5mm plaster stop. Not recommended for stucco applications. See page 5 for applique section view and visible baffle profiles after mud-in.

E ZERO-SIGHTLINE FACEPLATE / BAFFLE

CNC-Milled removable baffle provides 64° glare cutoff. Minimizes aperture glare and conceals view into housing; includes gasket. Exterior faceplate available in powdercoat finishes; interior finish is black powdercoat.

F TRIMLESS BAFFLE

CNC-Milled baffle provides 61° glare cutoff. Minimizes aperture glare and conceals view into housing; includes gasket. Baffle shape is square for both round and square apertures. Only 13mm inner aperture is visible after mud-in. **43mm square ceiling break required for LED/driver servicing.**

G FITTING WITH REMOTE POWER SUPPLY

- Requires 168mm cutout.
- Protected wiring and connecting hardware between fitting and power supply.
- Do not install in environments where ambient temperatures exceed 40°C (104°F).
- Fixtures accommodate ceiling thicknesses between 13mm and 38mm
- Hanger bars provided in assembly for rough-in installation to structural framing; hanger bars to be removed for use as **C** Remodel Mounting Plate.

DIMENSIONS / DRAWINGS

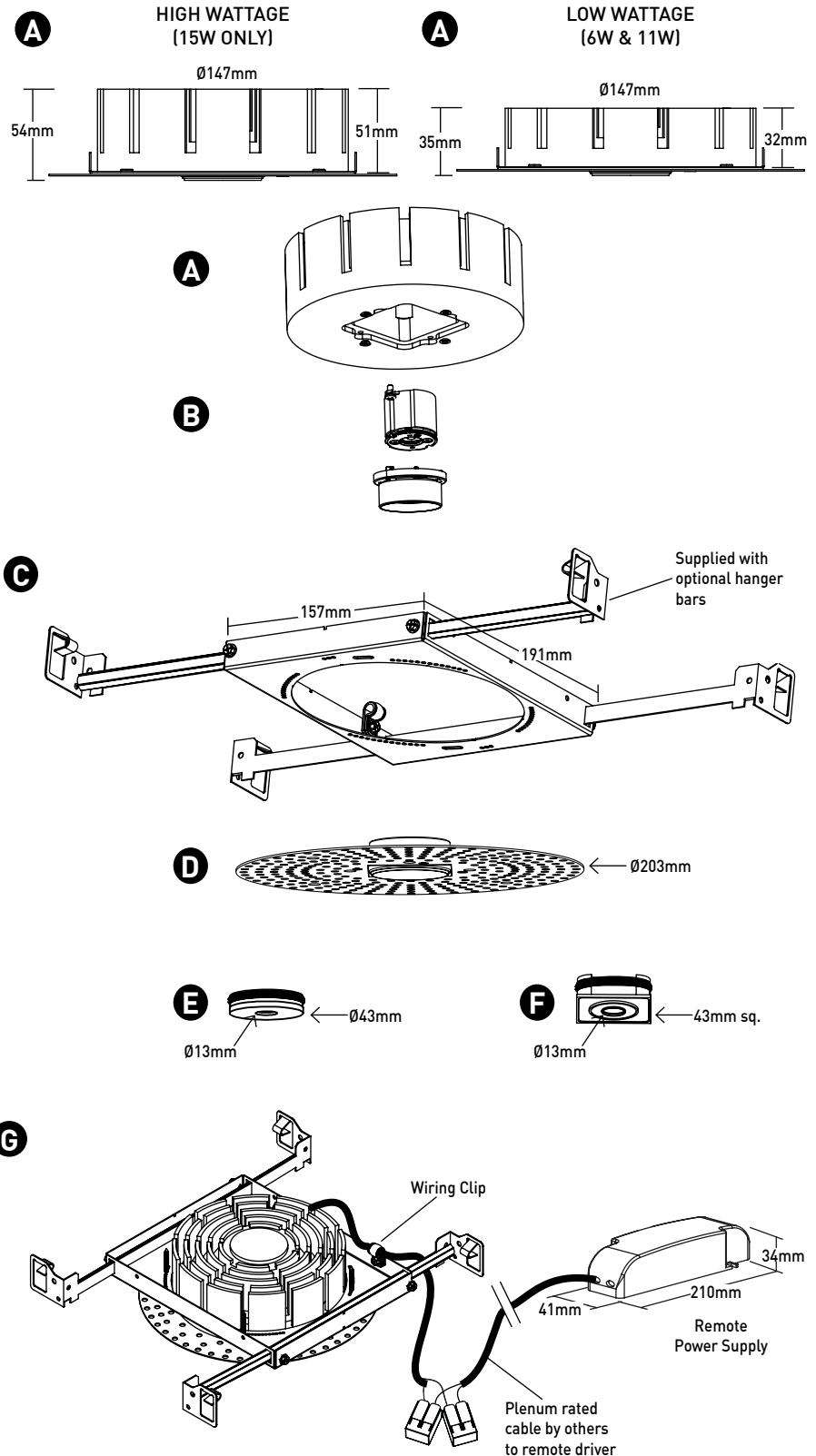

0 SERIES INT FIXED

DOWNLIGHT / HOUSING

H HOUSING-BASED FIXTURE WITH TETHERED DRIVER

- For “HX”, “HB”, and “HN” installation types.
- Power supply attached to LED and housing, allowing for roomside driver servicing.
- Factory supplied terminal block utilized for line voltage connections.
- Requires 121mm x 146mm rectangular cut-out.

I LIGHT ENGINE

Robust light engine with optimized optic pairing integrates Reflection, Refraction, and TIR offering 20°, 30°, and 40° beams.

J ZERO-SIGHTLINE / TRIMLESS DRYWALL PROFILE

Installs totally flush with the ceiling with no visible trim. Appliqué includes screws for mounting and has 1.5mm plaster stop. Not recommended for stucco applications.

K ZERO-SIGHTLINE FACEPLATE / BAFFLE

CNC-Milled removable baffle provides 64° glare cutoff. Minimizes aperture glare and conceals view into housing; includes gasket. Exterior faceplate available in powdercoat finishes; interior finish is black powdercoat.

L TRIMLESS BAFFLE

CNC-Milled baffle provides 61° glare cutoff. Minimizes aperture glare and conceals view into housing; includes gasket. Baffle shape is square for both round and square apertures. Only 13mm inner aperture is visible after mud-in. 43mm square ceiling break required for LED/driver servicing.

DIMENSIONS / DRAWINGS

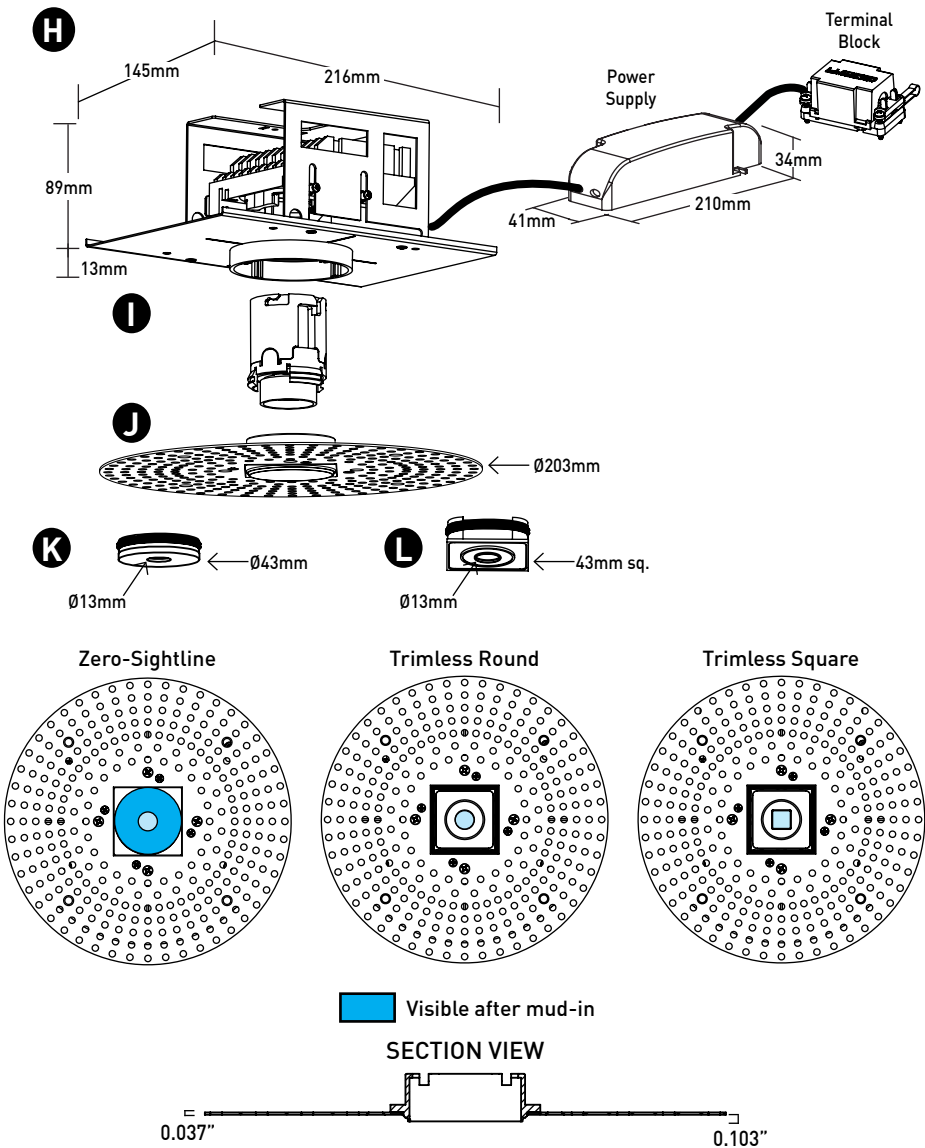

DISTRIBUTED POWER ACCESSORY

M HUB

Included with “HUB” driver selection. Allows for multi-fixture power distribution from one remote power supply to a maximum of 6 fixtures. Connectable fixture quantity is specified in fixture part number on page 2. Hub base plate allows for structural mounting and wiring during rough-in. Wiring distances for HUB based on quantity featured in figure K.

Model Number e.g.: HUB2X15W-IG1

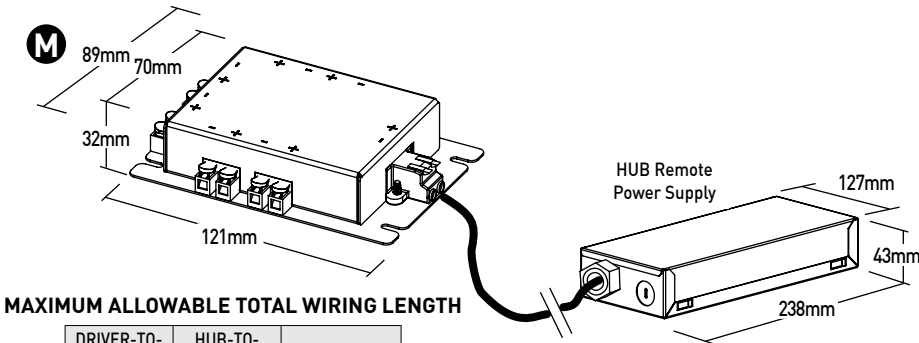

MAXIMUM ALLOWABLE TOTAL WIRING LENGTH

DRIVER-TO-HUB AWG	HUB-TO-FIXTURE AWG	TOTAL LENGTH
18	18	46m
16	16	61m
14	14	76m
12	18	122m*
12	16	137m*
12	14	152m*
*Total length requires 76m 12AWG Driver-to-Hub wiring		

0 SERIES INT FIXED

TECHNICAL

CONSTRUCTION

Downlight: Painted finishes are granulated powder coat; Alumina finishes are anodized aluminum.

Housing: Forged aluminum heat-sink.

Appliqué: Aluminum base with 22 Gauge galvanized steel flange.

STATIC WHITE LED



2-step MacAdam ellipse LED module available in 80+, 90+ and 95+ CRI configurations in color temperatures of 2700K, 3000K, 3500K and 4000K. 3-step MacAdam ellipse LED module available in 90+ CRI configuration in color temperature of 2400K. Average rated lamp life: 50,000 hours. LED and driver assemblies are field-replaceable.

WARM DIM LED



3-step MacAdam ellipse warm dim LED module available in 90+ CRI configuration 3000K or 2700K at full brightness, warming to 1800K at full dim. Average rated lamp life of 50,000 hours. LED and driver assemblies are field-replaceable.

POWER SUPPLY PERFORMANCE AND DIMMING INFORMATION

	0-10V		DALI-2
Power Supply	IG1	IN1	ID1
Minimum °C	-20 °C	-20 °C	-20 °C
Maximum °C	40 °C	40 °C	40 °C
Dimming %	0.1%	0.1%	0.1%

Note: For IG1 and IN1 drivers consult chart on page 8 to confirm appropriate dimming curve for compatibility with selected control

MAXIMUM ALLOWABLE REMOTE DRIVER WIRING DISTANCES (SINGLE FIXTURE, SINGLE DRIVER)

DRIVER	WIRE AWG				
	12	14	16	18	20
IG1, IN1, ID1	-	-	36m	22m	14m

LISTING

CE Listed for IP20 Dry / Damp and IP64 Wet locations.

WEIGHT

32mm Remodel Housing - 1.36kg

51mm Remodel Housing - 1.81kg

Remote Driver - .64kg

LIMITED WARRANTY

Manufacturer's Limited Warranty guarantees product(s) listed to be free from defects in material and workmanship under normal use and service for 1-year. LED and power supplies are warranted to operate with 70% of original flux and remain within a range of 3 duv for a period of 5-years.

10-year Lutron Advantage limited warranty available on Lutron equipped systems. Warranty period begins from the date of shipment by Seller.

CHANGE LOG

1. 05/06/2025: ADDED WARM DIM AND DISTRIBUTED POWER PRODUCT OFFERINGS

eldoLED DRIVER COMPATIBILITY

Power supply IG1 Manufacturer	Family/Model #
Busch-Jaeger	2112U-101
Jung	240-10
Leviton Lighting Controls	IP710-DLX
Lightolier Controls	ZP600FAM120
Merten	5729
Pass & Seymour	CD4FB-W
The Watt Stopper	DCLV1
Synergy	ISD BC
Crestron®	GLX-DIMFLV8
Crestron®	GLXP-DIMFLV8
Crestron®	GLPAC-DIMFLV4-*
Crestron®	GLPAC-DIMFLV8-*
Crestron®	GLPP-DIMFLVEX-PM
Crestron®	GLPP-1DIMFLV2EX-PM
Crestron®	GLPP-1DIMFLV3EX-PM
Crestron®	DIN-A08
Crestron®	DIN-4DIMFLV4
Crestron®	CLS-EXP-DIMFLV
Crestron®	CLCI-1DIMFLV2EX
Power supply IN1	Family/Model #
Lutron Electronics	Nova T® - NTFTV
Lutron Electronics	Diva® - DDTV
Lutron Electronics	Nova® - NFTV
Lutron Electronics	GrafixEye® GRX-TVI w GRX3503
Lutron Electronics	Energy Savr Node™ - QSN-4T16-S
Lutron Electronics	TVM2 Module
Sensor Switch	nI0 EZ
ABB	SD/S 2.16.1

ANALOG DRIVERS AND DIMMERS

