

TRACK HEAD STANDARD STEM CT2 WALLWASH

Give the most special art, objects, places, and spaces an elegant wash of soft light, with this classic, easy-to-adjust wallwash track head with an integrated kick reflector.

PROJECT NAME:

TYPE:

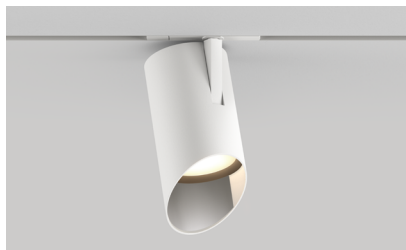

ORDERING INFORMATION - TRACK HEAD

JA8-2022 COMPLIANCE INDICATED BY SHADING

| CYLINDER | FIXTURE | RATING | CYLINDER FINISH | BAFFLE FINISH | ADAPTER FINISH | CRI / WATTAGE PACKAGE | CCT | OPTIC (UGR) | DRIVER | MEDIA |
|-----------|----------------------------|------------|-----------------------------------|---------------|----------------|--|-------------------------------|-------------------------|----------|-----------------|
| CT2 | AW | 1 | | BK | | | | WW | CE3 | W |
| CT2 3.25" | AW 90° Adjustable Wallwash | 1 Dry/Damp | POWDERCOAT | POWDERCOAT | WH White | <div>STATIC WHITE</div> <div>80S11A 80+ CRI, 11 Watts Lumens Delivered - 819</div> <div>80S17A 80+ CRI, 17 Watts Lumens Delivered - 1240</div> <div>90S11A 90+ CRI, 11 Watts Lumens Delivered - 704</div> <div>90S17A 90+ CRI, 17 Watts Lumens Delivered - 1065</div> <div>97S11A 97+ CRI, 11 Watts Lumens Delivered - 618</div> <div>97S17A 97+ CRI, 17 Watts Lumens Delivered - 935</div> <div>WARM DIM</div> <div>90W18A 90+ CRI, 18 Watts Incandescent Profile Lumens Delivered - 787</div> <div>Halogen Profile Lumens Delivered - 809</div> <div>SEE PAGE 3 FOR DETAILED WARM DIM PROFILE COMPARISON.</div> <div>ALL DELIVERED LUMEN OUTPUTS AND T24 COMPLIANCE REFLECT 3000K.</div> | 24 2400K* * (90+ CRI only) | WW Wallwash Optic (<19) | INTEGRAL | W Wallwash Lens |
| | | | WH White | BK Black | BK Black | | | | | |
| | | | BK Black | | | | | | | |
| | | | AB Architectural Bronze | | | | | | | |
| | | | AG Satin Silver | | | | | | | |
| | | | AU Cashmere Gold | | | | | | | |
| | | | BB Burnt Bronze | | | | | | | |
| | | | ALUMINA | | | | | | | |
| | | | 01 Brushed Obsidian | | | | | | | |
| | | | 02 Matte Obsidian | | | | | | | |
| | | | 03 Brushed Dark Patinated Bronze | | | | | | | |
| | | | 04 Matte Dark Patinated Bronze | | | | | | | |
| | | | 05 Brushed Aged Aluminum | | | | | | | |
| | | | 06 Matte Aged Aluminum | | | | | | | |
| | | | 07 Brushed Cast Brass | | | | | | | |
| | | | 08 Matte Cast Brass | | | | | | | |
| | | | 09 Brushed Light Patinated Bronze | | | | | | | |
| | | | 10 Matte Light Patinated Bronze | | | | | | | |

ALUMINA FINISHES BY LUCIFER LIGHTING™



POWDERCOAT FINISHES

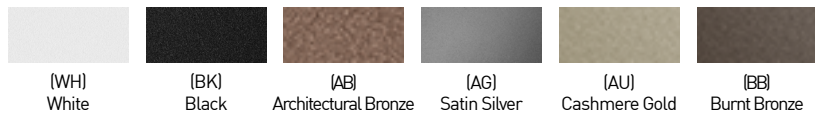

TRACK HEAD STANDARD STEM CT2 WALLWASH

WALLWASH DESIGN GUIDE

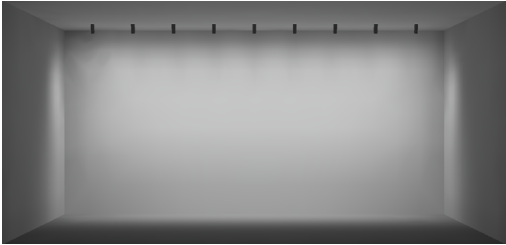
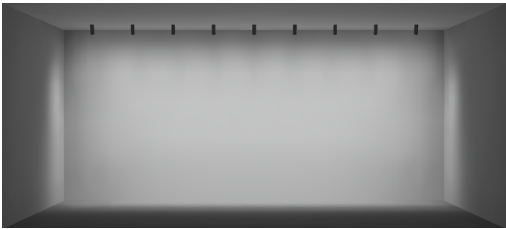
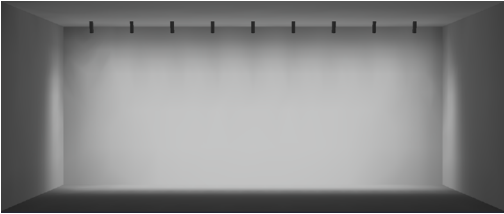

8FT CEILING

10FT CEILING

12FT CEILING

36" SETBACK / 36" ON CENTER SPACING / 15° TILT

36" SETBACK / 36" ON CENTER SPACING / 15° TILT

36" SETBACK / 36" ON CENTER SPACING / 15° TILT

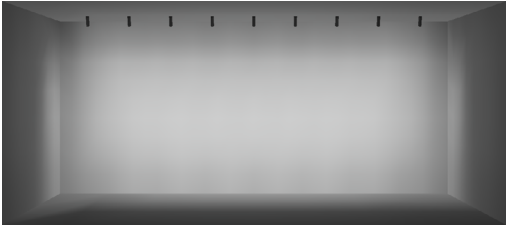
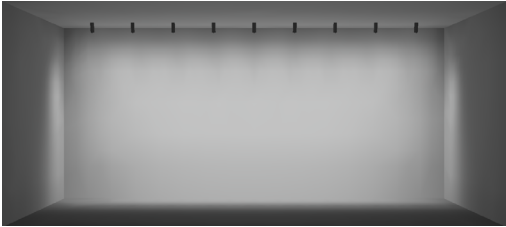
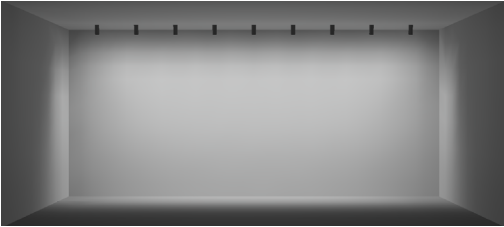

RECOMMENDED

30" SETBACK / 30" ON CENTER SPACING / 10° TILT

36" SETBACK / 36" ON CENTER SPACING / 15° TILT

42" SETBACK / 42" ON CENTER SPACING / 20° TILT

- AVERAGE FC: 21.92
- MAX / MIN: 4.65
- 10FT CEILING SHOWN / 8-12FT IDEAL
- 9 FIXTURES / 25FT WALL SHOWN

- AVERAGE FC: 20.85
- MAX / MIN: 4.12
- 10FT CEILING SHOWN / 8-12FT IDEAL
- 9 FIXTURES / 30FT WALL SHOWN

- AVERAGE FC: 19.23
- MAX / MIN: 5.53
- 10FT CEILING SHOWN / 8-12FT IDEAL
- 9 FIXTURES / 35FT WALL SHOWN

ADDITIONAL SETBACKS AND SPACINGS

| ON CENTER SPACING | SETBACK / TILT | | |
|-------------------|--------------------------------------|--------------------------------------|--------------------------------------|
| | 30" / 10° TILT | 36" / 15° TILT | 42" / 20° TILT |
| 30" | SHOWN ABOVE | AVERAGE FC: 23.92 MAX / MIN: 4.51 | AVERAGE FC: 25.96 MAX / MIN: 4.54 |
| 36" | AVERAGE FC: 19.19 MAX / MIN: 4.37 | SHOWN ABOVE | AVERAGE FC: 22.64 MAX / MIN: 4.03 |
| 42" | AVERAGE FC: 16.19 MAX / MIN: 5.87 | AVERAGE FC: 17.67 MAX / MIN: 5.74 | SHOWN ABOVE |

TRACK HEAD STANDARD STEM CT2 WALLWASH

STATIC WHITE PERFORMANCE - 3000K

TRUE 24 HOURS
JA8-2022 INDICATED BY SHADING

| LUMEN PACKAGE | WATTAGE | WW OPTIC WALLWASH LENS | |
|---------------------|---------|------------------------|-----|
| | | DELIVERED | LPW |
| 80S11A | 11 | 819 | 74 |
| 80S17A | 17 | 1240 | 73 |
| 90S11A | 11 | 704 | 64 |
| 90S17A | 17 | 1065 | 63 |
| 97S11A | 11 | 618 | 56 |
| 97S17A | 17 | 935 | 55 |
| 90W18AL 2700K-1800K | 18 | 787 | 49 |
| 90W18AD 3000K-1800K | 18 | 809 | 50 |

| OUTPUT MULTIPLIER | |
|-------------------|-----------|
| CCT | CCT SCALE |
| 2400K | 0.85 |
| 2700K | 0.97 |
| 3000K | 1.00 |
| 3500K | 1.03 |
| 4000K | 1.08 |

| UNIFIED GLARE RATING | |
|----------------------|--|
| WALLWASH OPTIC | |
| >19 | |

WARM DIM PERFORMANCE

INCANDESCENT DIMMING PROFILE

| 90W18AL 2700K - 1800K | Full on 100% | Dimmed to 80% | Dimmed to 70% | Dimmed to 50% | Dimmed to 20% | Dimmed to 10% | Dimmed to 2% |
|-----------------------|--------------|---------------|---------------|---------------|---------------|---------------|--------------|
| CCT (K) | 2700 | 2650 | 2620 | 2520 | 2180 | 1950 | 1800 |
| Light Output (Lm) | 787 | 630 | 551 | 394 | 157 | 78.7 | 16 |
| Power (W) | 18 | 14.4 | 12.6 | 9 | 3.6 | 1.8 | 0.36 |
| Efficacy (LPW) | 44 | 44 | 44 | 44 | 44 | 44 | 44 |

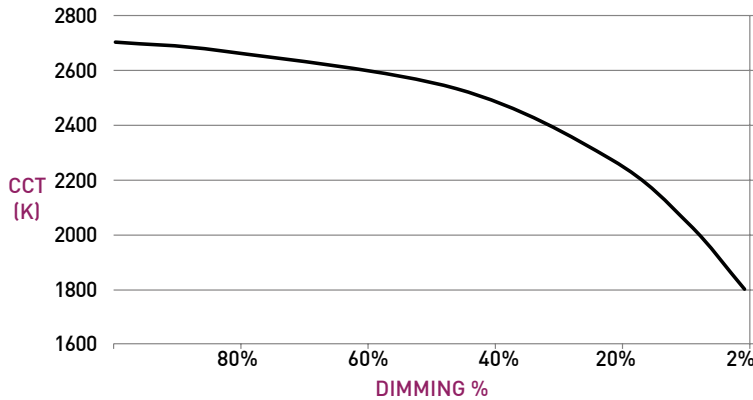

HALOGEN WARM DIM PROFILE

| 90W18AD 3000K - 1800K | Full on 100% | Dimmed to 80% | Dimmed to 70% | Dimmed to 50% | Dimmed to 20% | Dimmed to 10% | Dimmed to 2% |
|-----------------------|--------------|---------------|---------------|---------------|---------------|---------------|--------------|
| CCT (K) | 3000 | 2950 | 2920 | 2775 | 2375 | 2000 | 1800 |
| Light Output (Lm) | 809 | 647 | 566 | 405 | 162 | 81 | 16 |
| Power (W) | 18 | 14.4 | 12.6 | 9 | 3.6 | 1.8 | 0.36 |
| Efficacy (LPW) | 43 | 43 | 43 | 43 | 43 | 43 | 43 |

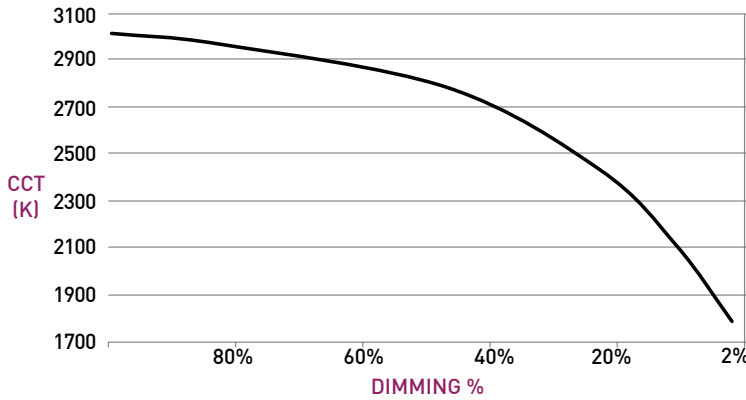

TRACK HEAD STANDARD STEM CT2 WALLWASH

TRACK HEAD

- A ADJUSTABILITY**
Up to 90° tilt and 370° lockable rotation.
- B TRACK ADAPTER**
Proprietary asymmetric track adapter; compatible with Lucifer Lighting track only. Available in Black and White finishes to match track systems.
- C BODY**
Power supply integrated into fixture body. Available in powdercoat and Alumina finishes. Body interior **C1** matches exterior finish; interior and exterior finishes cannot be specified differently.
- D OPTIC**
Proprietary optic for optimal wallwashing.
- E MEDIA**
Asymmetrical spread lens, included and sealed in place.
- F BAFFLE**
Baffle minimizes aperture glare and conceals view into fixture. Available in black powdercoat finish.
- G KICK REFLECTOR**
Miro® Kick reflector uniformly spreads light projected to wall plane.

DIMENSIONS / DRAWINGS

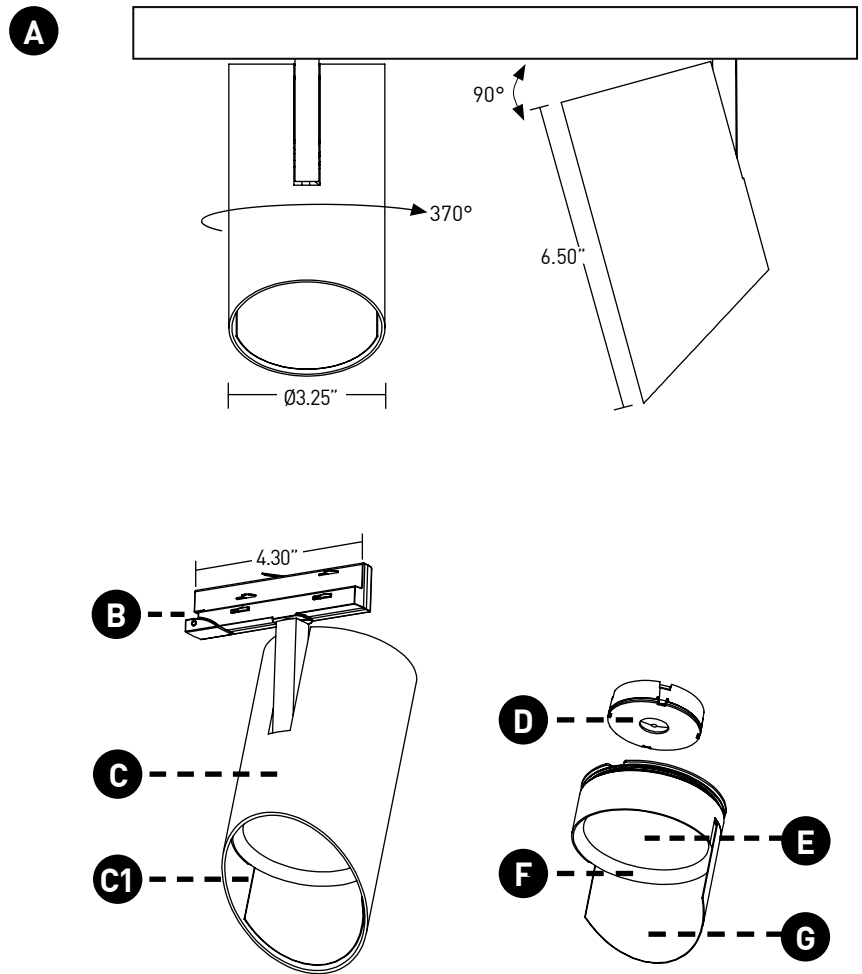

TRACK HEAD STANDARD STEM CT2 WALLWASH

TECHNICAL

CONSTRUCTION

Track Head: Machined aluminum body; painted finishes are granulated powder coat; Alumina finishes are anodized aluminum.

STATIC WHITE LED

2-step MacAdam ellipse LED module available in 80+, 90+ and 97+ CRI configurations in color temperatures of 2700K, 3000K, 3500K and 4000K. 3-step MacAdam ellipse LED module available in 90+ CRI configuration in color temperature of 2400K. Average rated lamp life of 50,000 hours.

WARM DIM LED

3-step MacAdam ellipse warm dim LED module available in 90+ CRI configuration. 3000K or 2700K at full brightness, warming to 1800K at full dim. Average rated lamp life of 50,000 hours.

POWER SUPPLY PERFORMANCE AND DIMMING INFORMATION

| | |
|--------------|--------|
| Power Supply | CE3 |
| Minimum °C | -20 °C |
| Maximum °C | 40 °C |
| Dimming % | 2.0% |

MOUNTING

Cylinder track head mounts to recessed, surface or pendant mount track assemblies, specified separately.

SPACING AND TILT

Trackhead must be tilted to achieve wallwashing effect. Recommended fixture spacing is 36" on center with 36" setback from wall plane with 15° tilt.

LISTING

Listed to UL1574 standard for Dry locations. JA8-2022 Title 24 listed. NEMA 410 compliant.

DECLARE

LBC Red List Approved.

LIMITED WARRANTY

Manufacturer's Limited Warranty guarantees product(s) listed to be free from defects in material and workmanship under normal use and service for 1-year. LED and power supplies are warranted to operate with 70% of original flux and remain within a range of 3 duv for a period of 5-years. Warranty period begins from the date of shipment by Seller. [Consult website for full warranty terms and conditions.](#)

CHANGE LOG

1. 10/17/2022: REMOVED CE2 DRIVER AND ADDED CE3 DRIVER.
2. 05/12/2023: ADDED LBC RED LIST APPROVED.
3. 08/08/2023: ADDED NEW LED AND OPTIC SYSTEM.
4. 02/08/2024: ADDED 2400K OFFERING.
5. 11/14/2024: ADDED ADDITIONAL POWDERCOAT FINISHES.