

# TRACK HEAD MONOPOINT INSPIRED CTM2 WALLWASH

Give the most special art, objects, places, and spaces an elegant wash of soft light, with this classic, easy-to-adjust wallwash track head with an integrated kick reflector.

PROJECT NAME:

TYPE:



ORDERING INFORMATION - TRACK HEAD

TITLE 24 COMPLIANT

JA8-2022 COMPLIANCE INDICATED BY SHADING

CYLINDER	FIXTURE	STEM LENGTH	RATING	BODY FINISH	BAFFLE FINISH	STEM FINISH	ADAPTER FINISH	CRI / WATTAGE PACKAGE	CCT	OPTIC(UGR)	DRIVER	MEDIA	
CTM2	W		1		BK					WW	CE3	W	
CTM2 3.25"	W Wallwash	LENGTHS	1 Dry	POWDERCOAT	POWDERCOAT	POWDERCOAT	WH White BK Black	 STATIC WHITE 80S11A 80+ CRI, 11 Watts Lumens Delivered - 819 80S17A 80+ CRI, 17 Watts Lumens Delivered - 1240 90S11A 90+ CRI, 11 Watts Lumens Delivered - 704 90S17A 90+ CRI, 17 Watts Lumens Delivered - 1065 97S11A 97+ CRI, 11 Watts Lumens Delivered - 618 97S17A 97+ CRI, 17 Watts Lumens Delivered - 935	24 2400K* *(90+ CRI only) 27 2700K 30 3000K 35 3500K 40 4000K	WW Wallwash Optic (<19)	INTEGRAL CE3 Electronic 2% ELV / TRIAC 120V	W Wallwash Lens	
		SL 1.4" Standard		WH White		WH White							
		04 4"		BK Black		BK Black							
		06 6"		AB Architectural Bronze		AB Architectural Bronze							
		08 8"		AG Satin Silver		AG Satin Silver							
		CUSTOM LENGTHS XX Specify in 1" increments between 2"-7" (Ex. 2" = 02)* *(Increased lead time)		AU Cashmere Gold		AU Cashmere Gold							
				BB Burnt Bronze		BB Burnt Bronze							
				ALUMINA		ALUMINA							
				01 Brushed Obsidian		CONSULT FACTORY FOR ALUMINA FINISHES							
				02 Matte Obsidian									
				03 Brushed Dark Patinated Bronze									
				04 Matte Dark Patinated Bronze									
				05 Brushed Aged Aluminum									
				06 Matte Aged Aluminum									
				07 Brushed Cast Brass									
				08 Matte Cast Brass									
				09 Brushed Light Patinated Bronze									
				10 Matte Light Patinated Bronze									
ALL DELIVERED LUMEN OUTPUTS AND T24 COMPLIANCE REFLECT 3000K.													

ALUMINA FINISHES BY LUCIFER LIGHTING™

[01] Brushed Obsidian

[03] Brushed Dark Patinated Bronze

[05] Brushed Aged Aluminum

[07] Brushed Cast Brass

[09] Brushed Light Patinated Bronze

[02] Matte Obsidian

[04] Matte Dark Patinated Bronze

[06] Matte Aged Aluminum

[08] Matte Cast Brass

[10] Matte Light Patinated Bronze

POWDERCOAT FINISHES

[WH] White

[BK] Black

[AB] Architectural Bronze

[AG] Satin Silver

[AU] Cashmere Gold

[BB] Burnt Bronze

# TRACK HEAD MONOPOINT INSPIRED CTM2 WALLWASH

## WALLWASH DESIGN GUIDE

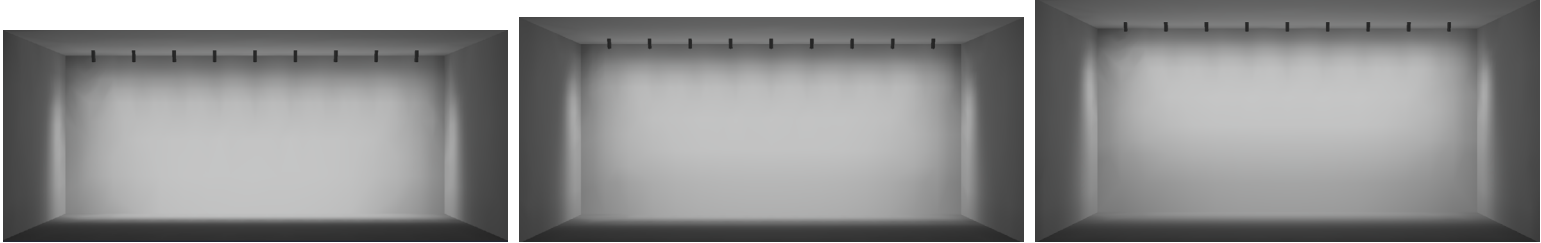

8FT CEILING  
36" SETBACK / 36" ON CENTER SPACING / 15° TILT

10FT CEILING  
36" SETBACK / 36" ON CENTER SPACING / 15° TILT

12FT CEILING  
36" SETBACK / 36" ON CENTER SPACING / 15° TILT

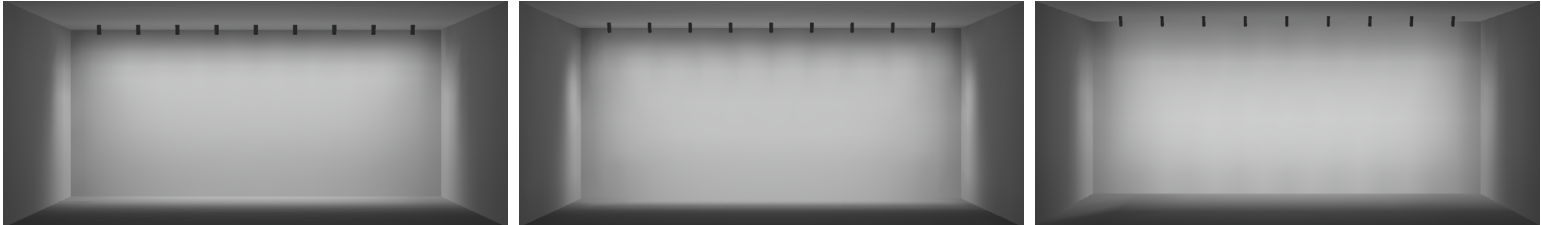

30" SETBACK / 30" ON CENTER SPACING / 10° TILT  
• AVERAGE FC: 21.92  
• MAX / MIN: 4.65  
• 10FT CEILING SHOWN / 8-12FT IDEAL  
• 9 FIXTURES / 25FT WALL SHOWN

RECOMMENDED  
36" SETBACK / 36" ON CENTER SPACING / 15° TILT  
• AVERAGE FC: 20.85  
• MAX / MIN: 4.12  
• 10FT CEILING SHOWN / 8-12FT IDEAL  
• 9 FIXTURES / 30FT WALL SHOWN

42" SETBACK / 42" ON CENTER SPACING / 20° TILT  
• AVERAGE FC: 19.23  
• MAX / MIN: 5.53  
• 10FT CEILING SHOWN / 8-12FT IDEAL  
• 9 FIXTURES / 35FT WALL SHOWN

### ADDITIONAL SETBACKS AND SPACINGS

ON CENTER SPACING	SETBACK / TILT		
	30" / 10° TILT	36" / 15° TILT	42" / 20° TILT
30"	SHOWN ABOVE	AVERAGE FC: 23.92 MAX / MIN: 4.51	AVERAGE FC: 25.96 MAX / MIN: 4.54
36"	AVERAGE FC: 19.19 MAX / MIN: 4.37	SHOWN ABOVE	AVERAGE FC: 22.64 MAX / MIN: 4.03
42"	AVERAGE FC: 16.19 MAX / MIN: 5.87	AVERAGE FC: 17.67 MAX / MIN: 5.74	SHOWN ABOVE

TRACK HEAD MONOPOINT INSPIREDCTM2 WALLWASH

STATIC WHITE PERFORMANCE - 3000K



JA8-2022 INDICATED BY SHADING

LUMEN PACKAGE	WATTAGE	WW OPTIC WALLWASH LENS	
		DELIVERED	LPW
80S11A	11	819	74
80S17A	17	1240	73
90S11A	11	704	64
90S17A	17	1065	63
97S11A	11	618	56
97S17A	17	935	55
90W18AL 2700K-1800K	18	787	49
90W18AD 3000K-1800K	18	809	50

OUTPUT MULTIPLIER	
CCT	CCT SCALE
2400K	0.85
2700K	0.97
3000K	1.00
3500K	1.03
4000K	1.08

UNIFIED GLARE RATING	
WALLWASH OPTIC	
>19	

WARM DIM PERFORMANCE

INCANDESCENT DIMMING PROFILE

90W18AL 2700K - 1800K	Full on 100%	Dimmed to 80%	Dimmed to 70%	Dimmed to 50%	Dimmed to 20%	Dimmed to 10%	Dimmed to 2%
CCT (K)	2700	2650	2620	2520	2180	1950	1800
Light Output (Lm)	787	630	551	394	157	78.7	16
Power (W)	18	14.4	12.6	9	3.6	1.8	0.36
Efficacy (LPW)	44	44	44	44	44	44	44

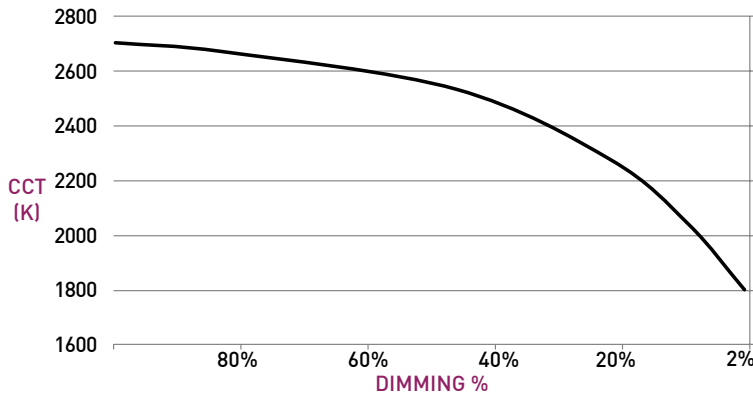

HALOGEN WARM DIM PROFILE

90W18AD 3000K - 1800K	Full on 100%	Dimmed to 80%	Dimmed to 70%	Dimmed to 50%	Dimmed to 20%	Dimmed to 10%	Dimmed to 2%
CCT (K)	3000	2950	2920	2775	2375	2000	1800
Light Output (Lm)	809	647	566	405	162	81	16
Power (W)	18	14.4	12.6	9	3.6	1.8	0.36
Efficacy (LPW)	43	43	43	43	43	43	43

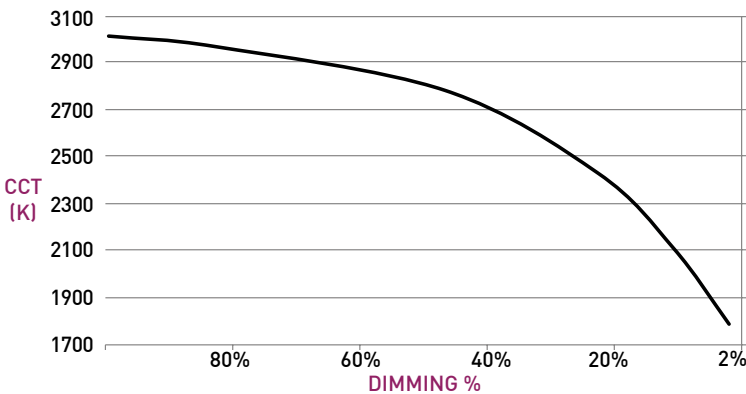

# TRACK HEAD MONOPOINT INSPIRED CTM2 WALLWASH

## TRACK HEAD

- A ADJUSTABILITY**  
Up to 90° lockable tilt and 370° lockable rotation.
- B TRACK ADAPTER**  
Proprietary asymmetric track adapter; compatible with Lucifer Lighting track only. Available in Black and White finishes to match track systems.
- C STEM**  
Standard length is 1.4", available in even-inch increments from 2" - 8". Stem is not field cuttable. Powdercoat finishes standard, consult factory for Alumina finishes.
- D BODY**  
Power supply integrated into fixture body. Available in powdercoat and Alumina finishes. Body interior **D1** matches exterior finish; interior and exterior finishes cannot be specified differently.
- E OPTIC**  
Proprietary optic for optimal wallwashing.
- F MEDIA**  
Asymmetrical spread lens, included and sealed in place.
- G BAFFLE**  
Baffle minimizes aperture glare and conceals view into fixture. Available in black powdercoat finish.
- H KICK REFLECTOR**  
Miro® Kick reflector uniformly spreads light projected to wall plane. Kick reflector not available with painted or Alumina finishes.

## DIMENSIONS / DRAWINGS

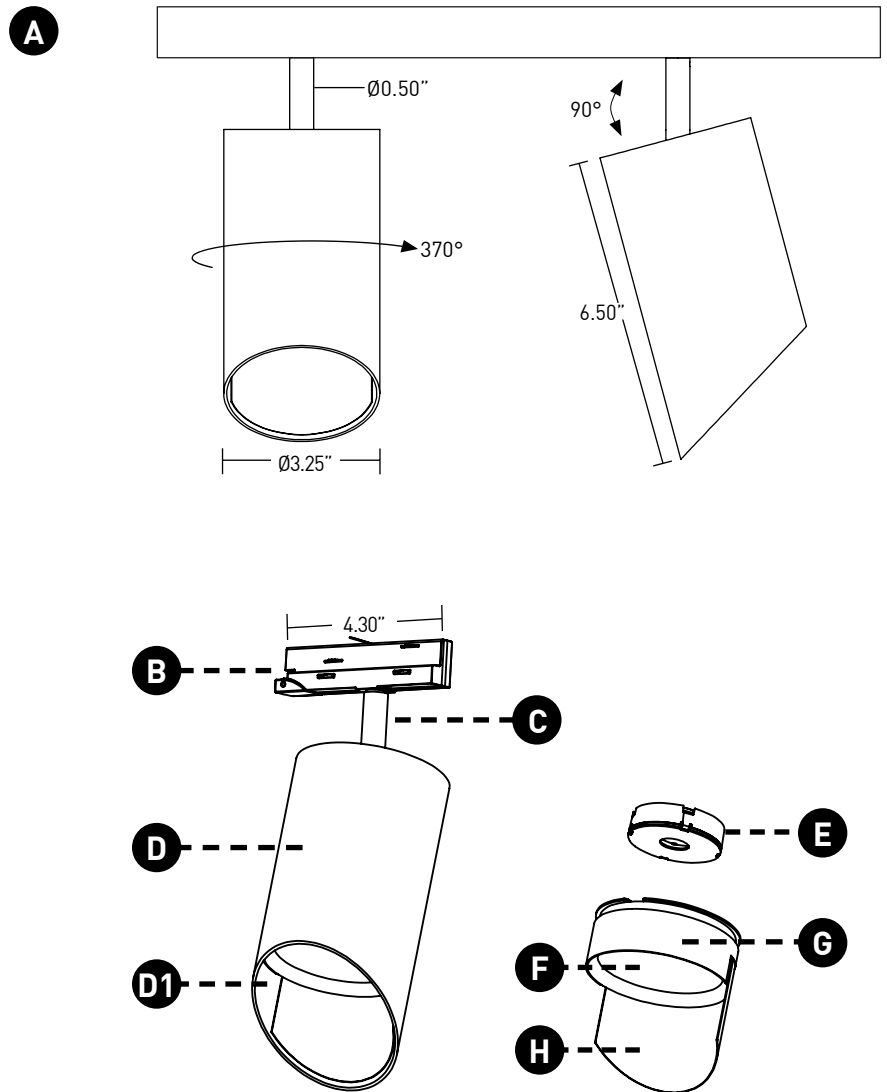

# TRACK HEAD MONOPOINT INSPIRED CTM2 WALLWASH

## TECHNICAL

### CONSTRUCTION

**Track Head:** Machined aluminum body; painted finishes are granulated powder coat; Alumina finishes are anodized aluminum.

### STATIC WHITE LED

2-step MacAdam ellipse LED module available in 80+, 90+ and 97+ CRI configurations in color temperatures of 2700K, 3000K, 3500K and 4000K. 3-step MacAdam ellipse LED module available in 90+ CRI configuration in color temperature of 2400K. Average rated lamp life of 50,000 hours.

### WARM DIM LED

3-step MacAdam ellipse warm dim LED module available in 90+ CRI configuration. 3000K or 2700K at full brightness, warming to 1800K at full dim. Average rated lamp life of 50,000 hours.

### POWER SUPPLY PERFORMANCE AND DIMMING INFORMATION

Power Supply	CE3
Minimum °C	-20 °C
Maximum °C	40 °C
Dimming %	2.0%

### MOUNTING

Cylinder track head mounts to recessed, surface or pendant mount track assemblies, specified separately.

### SPACING AND TILT

Trackhead must be tilted to achieve wallwashing effect. Recommended fixture spacing is 36" on center with 36" setback from wall plane with 15° tilt.

### LISTING

Listed to UL1574 standard for Dry locations. JA8-2022 Title 24 listed. NEMA 410 compliant.

### DECLARE

LBC Red List Approved.

### LIMITED WARRANTY

Manufacturer's Limited Warranty guarantees product(s) listed to be free from defects in material and workmanship under normal use and service for 1-year. LED and power supplies are warranted to operate with 70% of original flux and remain within a range of 3 duv for a period of 5-years. Warranty period begins from the date of shipment by Seller. [Consult website for full warranty terms and conditions.](#)

### CHANGE LOG

- 1.03/16/2023: REMOVED ALL STEM LENGTH OFFERINGS EXCEPT STANDARD 1.4" LENGTH.
- 2.05/12/2023: ADDED LBC RED LIST APPROVED.
- 3.08/08/2023: ADDED NEW LED AND OPTIC SYSTEM.
- 4.02/08/2024: ADDED 2400K OFFERING.
- 5.09/30/2024: ADDED ADDITIONAL STEM LENGTHS UP TO 8" MAX.
- 6.11/14/2024: ADDED ADDITIONAL POWDERCOAT FINISHES.

