

MONOPOINT INTERNATIONAL CM2 SURFACE MOUNT

Elegant design means this monopoint does more. An inventive elbow built into the fixture body that allows a full 90 degree tilt and drop lengths of up to 1' extend adjustability.

PROJECT NAME:	TYPE:
---------------	-------

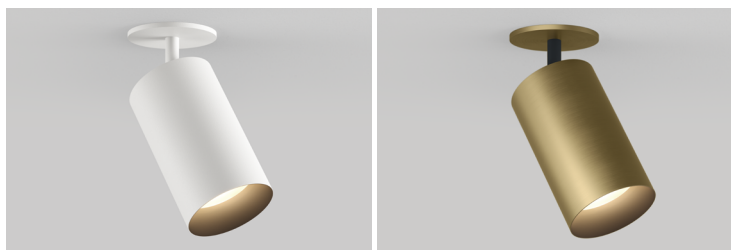

ORDERING INFORMATION - MONOPOINT

CYLINDER	LENGTH	FIXTURE	BODY FINISH	BAFFLE FINISH	STEM FINISH	CRI / WATTAGE PACKAGE	CCT	OPTIC (UGR)	DRIVER	MEDIA	MOUNTING
CM2											E
CM2 83mm	LENGTHS SL 1.4" Standard 06 6" 12 12" CUSTOM LENGTHS XX Specify in 1" increments between 2"-11" (Ex. 4" = 04)* *(Increased lead time) STEMS ARE NOT FIELD CUTTABLE	ADJUSTABLE DRY / DAMP AD1 Adjustable 90° Tilt FIXED TILT WET (IP65) F02 Fixed 0° No Tilt* F12 Fixed 15° Tilt* F32 Fixed 30° Tilt* F42 Fixed 45° Tilt* *FIXED TILT IS SET AS SPECIFIED, CANNOT BE CHANGED IN THE FIELD	POWDERCOAT WH White BK Black AB Architectural Bronze AG Satin Silver AU Cashmere Gold BB Burnt Bronze CF Custom Finish* *(Consult Factory) ALUMINA INTERIOR APPLICATIONS ONLY 01 Brushed Obsidian 02 Matte Obsidian 03 Brushed Dark Patinated Bronze 04 Matte Dark Patinated Bronze 05 Brushed Aged Aluminum 06 Matte Aged Aluminum 07 Brushed Cast Brass 08 Matte Cast Brass 09 Brushed Light Patinated Bronze 10 Matte Light Patinated Bronze ALUMINA NOT RECOMMENDED FOR EXTERIOR APPLICATIONS, FINISHES ARE NOT UPDATED	POWDERCOAT WH White BK Black AB Architectural Bronze AG Satin Silver AU Cashmere Gold BB Burnt Bronze CF Custom Finish* *(Consult Factory) ALUMINA CONSULT FACTORY FOR ALUMINA FINISHES	POWDERCOAT WH White BK Black AB Architectural Bronze AG Satin Silver AU Cashmere Gold BB Burnt Bronze CF Custom Finish* *(Consult Factory) ALUMINA CONSULT FACTORY FOR ALUMINA FINISHES	STATIC WHITE 80S11A 80+ CRI, 11 Watts Lumens Delivered - 1216 80S17A 80+ CRI, 17 Watts Lumens Delivered - 1843 90S11A 90+ CRI, 11 Watts Lumens Delivered - 1045 90S17A 90+ CRI, 17 Watts Lumens Delivered - 1583 97S11A 97+ CRI, 11 Watts Lumens Delivered - 918 97S17A 97+ CRI, 17 Watts Lumens Delivered - 1390 REMOTE STATIC WHITE 80S28B 80+ CRI, 28 Watts Lumens Delivered - 2756 90S28B 90+ CRI, 28 Watts Lumens Delivered - 2368 97S28B 97+ CRI, 28 Watts Lumens Delivered - 2079 WARM DIM 90L17A 90+ CRI, 17 Watts Incandescent Profile lm Delivered - 1244 Halogen Profile lm Delivered - 1309 SEE PAGE 3 FOR WARM DIM PROFILE COMPARISON. REMOTE TUNABLE WHITE 90T28B 90+ CRI, 28W Cool Profile: 5000K - 2700K Lumens Delivered - 1977 Warm Profile: 4000K - 1800K Lumens Delivered. - 1995 LUMENS DELIVERED REFLECT 3000K PAIRED WITH 20° OPTIC AND SOFT FOCUS LENS.	24 2400K* *(90+ CRI only) 27 2700K 30 3000K 35 3500K 40 4000K 27 2700K 30 3000K 35 3500K* *(Not available for 97+ CRI) 40 4000K WL 2700K - 1800K WD 3000K - 1800K TH 5000K - 2700K TR 4000K - 1800K	10 10° (>19) 15 15° (<13) 20 20° (<10) 25 25° (<10) 40 40° (<10) 60 60° (<16) 15 15° (<13) 20 20° (<10) 25 25° (<10) 40 40° (<10) 60 60° (<16) 15 15° (<13) 20 20° (<10) 25 25° (<10) 40 40° (<10) 60 60° (<13) 15 15° (<13) 20 20° (<13) 25 25° (<13) 40 40° (<13) 60 60° (<16)	INTEGRAL IE Electronic ELV / TRIAC 220V-240V REMOTE IG eldoLED, SOLdrive 0.1% 0-10V, LOG 120V-277V IN eldoLED, SOLdrive 0.1% 0-10V, LIN 120V-277V ID eldoLED, SOLdrive 0.1% DALI-2, LOG 120V-277V REMOTE TUNABLE WHITE DD eldoLED, DUALdrive 0.1% DALI-2, LOG 120V-277V	STANDARD MEDIA 4 Soft Focus Lens* *(Required for 10° optic) ALTERNATE MEDIA 2 Honeycomb Louver* *(Not available for IP65 Wet Location) 3 Clear Glass Lens 5 Frosted Glass Lens 6 Frosted Soft Focus Lens 7 Frosted Linear Spread Lens S Soft Focus Lens w/ Honeycomb Louver F Frosted Glass Lens w/ Honeycomb Louver N No Lens* *(Not available for IP65 Wet Location)	E EXMP Export Mounting Plate. Features 83mm diameter canopy

PART NUMBER NOTES

- CM2 ships as e.g., CM202AD1WHBKWH90S11*3040IE*4E
- Remote driver ships as e.g., PS-RMT-90S-28B-IG*

MONOPOINT INTERNATIONAL CM2 SURFACE MOUNT

FINISHES

POWDERCOAT FINISHES

					
(WH) White	(BK) Black	(AB) Architectural Bronze	(AG) Satin Silver	(AU) Cashmere Gold	(BB) Burnt Bronze

ALUMINA FINISHES BY LUCIFER LIGHTING™

				
(01) Brushed Obsidian	(03) Brushed Dark Patinated Bronze	(05) Brushed Aged Aluminum	(07) Brushed Cast Brass	(09) Brushed Light Patinated Bronze
				
(02) Matte Obsidian	(04) Matte Dark Patinated Bronze	(06) Matte Aged Aluminum	(08) Matte Cast Brass	(10) Matte Light Patinated Bronze

ACCESSORIES

REPLACEMENT MEDIA

- ☐ **HCL-CT2** Honeycomb Louver
- ☐ **CGL-CT2** Clear Glass Lens
- ☐ **SFL-CT2** Soft Focus Lens
- ☐ **FGL-CT2** Frosted Glass Lens
- ☐ **FSFL-CT2** Frosted Soft Focus Lens
- ☐ **FLSL-CT2** Frosted Linear Spread Lens

REPLACEMENT OPTICS

Interchangeable optics accessible by removing baffle.

- | Static White | | Warm Dim | | Tunable White | |
|--|-----------|--|-----------|--|-----------|
| <input type="checkbox"/> RO-70-15-S | 15° optic | <input type="checkbox"/> RO-70-15-W | 15° optic | <input type="checkbox"/> RO-70-15-S | 15° optic |
| <input type="checkbox"/> RO-70-20-S | 20° optic | <input type="checkbox"/> RO-70-20-W | 20° optic | <input type="checkbox"/> RO-70-20-S | 20° optic |
| <input type="checkbox"/> RO-70-25-S | 25° optic | <input type="checkbox"/> RO-70-25-W | 25° optic | <input type="checkbox"/> RO-70-25-S | 25° optic |
| <input type="checkbox"/> RO-70-40-S | 40° optic | <input type="checkbox"/> RO-70-40-W | 40° optic | <input type="checkbox"/> RO-70-40-S | 40° optic |
| <input type="checkbox"/> RO-70-60-S | 60° optic | <input type="checkbox"/> RO-70-60-W | 60° optic | <input type="checkbox"/> RO-70-60-S | 60° optic |

REPLACEMENT BAFFLE ASSEMBLY (INCLUDES MEDIA)

ASSEMBLY	SHAPE	RATING	FINISH	MEDIA
RBA	CM2			
REPLACEMENT BAFFLE ASSEMBLY	CM2 83mm	1 IP20 Dry/Damp 2 IP65 Wet* *(Requires provided suction cup to service)	WH White BK Black AB Architectural Bronze AG Satin Silver AU Cashmere Gold BB Burnt Bronze PR Primer CF Custom Finish * *(Consult Factory)	LEAVE BLANK FOR SOFT FOCUS LENS (SFL) HCL Honeycomb Louver* *(Not available for Wet Location) CGL Clear Glass Lens FGL Frosted Glass Lens FSFL Frosted Soft Focus Lens FLSL Frosted Linear Spread Lens NL No Lens * *(Not available for Wet Location)

MONOPOINT INTERNATIONAL CM2 SURFACE MOUNT

PERFORMANCE - 3000K

LUMEN PACKAGE	WATTAGE	10° OPTIC FIELD REDUCER		15° OPTIC SOFT FOCUS LENS		20° OPTIC SOFT FOCUS LENS		25° OPTIC SOFT FOCUS LENS		40° OPTIC SOFT FOCUS LENS		60° OPTIC SOFT FOCUS LENS	
		DELIVERED	LPW	DELIVERED	LPW	DELIVERED	LPW	DELIVERED	LPW	DELIVERED	LPW	DELIVERED	LPW
80S11A	11	613	55	1143	104	1216	111	1202	109	1124	102	949	86
80S17A	17	828	49	1750	103	1843	108	1823	107	1690	99	1440	85
80S28B	28	-	-	2571	92	2756	98	2694	96	2529	90	2072	74
90S11A	11	528	48	982	89	1045	95	1033	94	966	88	815	74
90S17A	17	714	42	1503	88	1583	91	1566	92	1452	85	1237	73
90S28B	28	-	-	2209	79	2368	85	2314	83	2193	78	1780	64
97S11A	11	456	41	862	78	918	83	907	82	848	77	716	65
97S17A	17	616	36	1320	78	1390	82	1375	81	1275	75	1086	64
97S28B	28	-	-	1939	69	2079	74	2032	73	1908	68	1563	56
90L17A (2700K-1800K)	17	-	-	1249	73	1244	73	1229	72	1177	69	1046	62
90L17A (3000K-1800K)	17	-	-	1314	77	1309	77	1293	76	1238	73	1100	65
90T28B (4000K-1800K)	28	-	-	1972	70	1995	71	1971	70	1837	66	1655	59
90T28B (5000K-2700K)	28	-	-	1954	70	1977	71	1953	70	1820	65	1640	59

Part L 75+ LPW configurations comply with residential Part L
95+ LPW configurations comply with commercial Part L

UNIFIED GLARE RATING

10° OPTIC FIELD REDUCER	15° OPTIC SOFT FOCUS LENS	20° OPTIC SOFT FOCUS LENS	25° OPTIC SOFT FOCUS LENS	40° OPTIC SOFT FOCUS LENS	60° OPTIC SOFT FOCUS LENS
>19	<13	<13	<13	<13	<16

MEDIA LIGHT LOSS MULTIPLIER

MEDIA	LIGHT LOSS FACTOR
No Lens	1.05
CGL	0.97
SFL	1.00
FGL	0.85
FSFL	0.82
FLSL	0.78
HCL	0.75
SFL W/ HCL	0.68
FGL W/ HCL	0.47

OUTPUT MULTIPLIER

CCT	CCT SCALE
2400K	0.85
2700K	0.97
3000K	1.000
3500K	1.03
4000K	1.08

TUNABLE WHITE MULTIPLIER

CCT	5000K- 2700K	4000K- 1800K
5000K	1.16	-
4000K	1.08	1.14
3500K	1.04	1.07
3000K	1.00	1.00
2700K	0.96	0.92
2400K	-	0.84
1800K	-	0.69

WARM DIM PERFORMANCE - SOFT FOCUS LENS - 20° OPTIC

INCANDESCENT PROFILE

90L17AWL 2700K - 1800K	Full on 100%	Dimmed to 80%	Dimmed to 70%	Dimmed to 50%	Dimmed to 20%	Dimmed to 10%	Dimmed to 2%
CCT (K)	2700	2700	2700	2700	2500	1950	1800
Light Output (Lm)	1244	995	871	622	249	124	25
Power (W)	17	8.8	7.7	5.5	2.2	1.1	0.2
Efficacy (LPW)	73	73	73	73	73	73	73

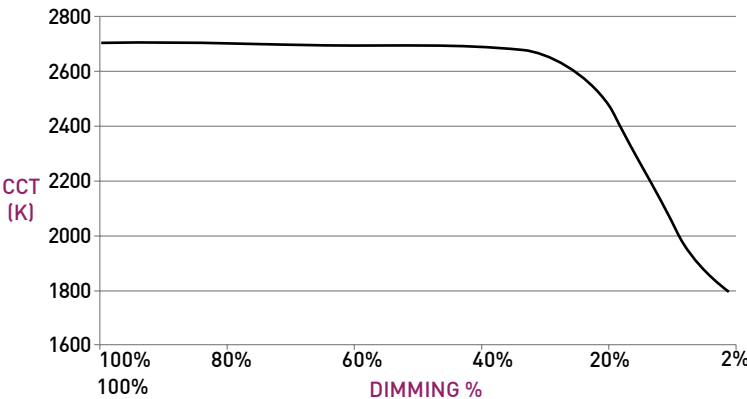

HALOGEN PROFILE

90L17AWD 3000K - 1800K	Full on 100%	Dimmed to 80%	Dimmed to 70%	Dimmed to 50%	Dimmed to 20%	Dimmed to 10%	Dimmed to 2%
CCT (K)	3000	3000	3000	3000	3000	2150	1800
Light Output (Lm)	1309	1047	916	655	262	131	26
Power (W)	17	8.8	7.7	5.5	2.2	1.1	0.2
Efficacy (LPW)	77	77	77	77	77	77	77

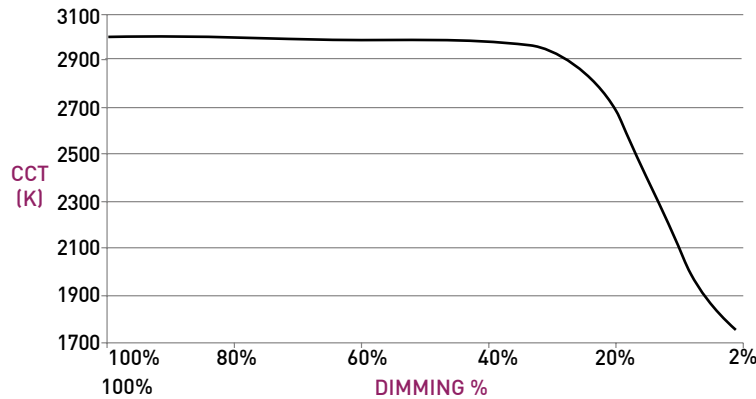

NOTE: LIN-TO-LIN 0-10V PAIRING NOT COMPATIBLE WITH WARM DIM.

MONOPOINT INTERNATIONAL CM2 SURFACE MOUNT

MONOPOINT

- A EXPORT MOUNTING PLATE**
Export mounting plate (concealed) to be installed above ceiling substrate. Features minimalist 83mm diameter canopy.
- B STEM**
Standard length is 1.4", available in even-inch increments between 2"-12". Stem is not field cuttable. Powdercoat finishes standard, consult factory for Alumina finishes.
- C BODY**
Available in powdercoat and Alumina finishes. Power supply integrated into fixture body.
- D OPTICS**
Robust light engine with optimized optic pairing integrates Reflection, Refraction, and TIR offering 10°, 15°, 20°, 25°, 40° & 60° beams.
- E 10° FIELD REDUCER**
Soft Focus Lens, Honeycomb Louver, and Field Reducer provided with 10° optic. Reduces field angle by 30%.
- F MEDIA**
Soft Focus Lens standard. Wet location media sealed in place.
- G BAFFLE**
Accepts 2 media devices. Baffle minimizes aperture glare and conceals view into fixture. Powdercoat finishes standard, consult factory for Alumina finishes.
- H CANOPY**
Adjustable Dry/Damp fixture features 0.175" and Fixed Wet fixture features 0.3" tall canopy.
- I ADJUSTABLE FIXTURE**
Features 90° tilt and 365° rotation. Only available for Dry / Damp locations.
- J FIXED FIXTURE**
Available with pre-set tilts of 0°, 15°, 30°, or 45°, and features 365° rotation. Wet rated, may be used in Dry / Damp locations.

IMPORTANT: FIXED FIXTURE TILT CANNOT BE ADJUSTED OR CHANGED IN THE FIELD, FIXTURES MUST BE RETURNED TO FACTORY FOR TILT CHANGES AT ADDITIONAL COST.

REMOTE POWER SUPPLY

- K Remote power supply** provides additional driver options. See page 4 for maximum allowable wiring distance. Must be installed in an accessible location.

DIMENSIONS / DRAWINGS

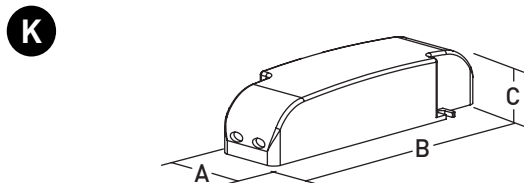
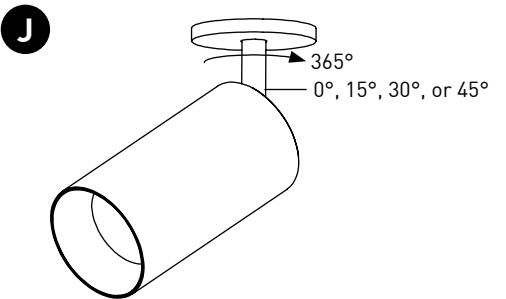
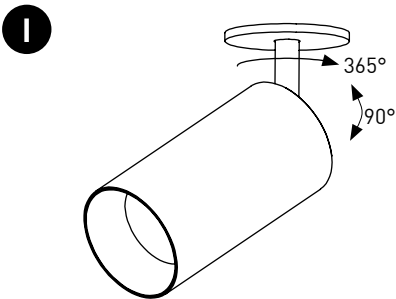
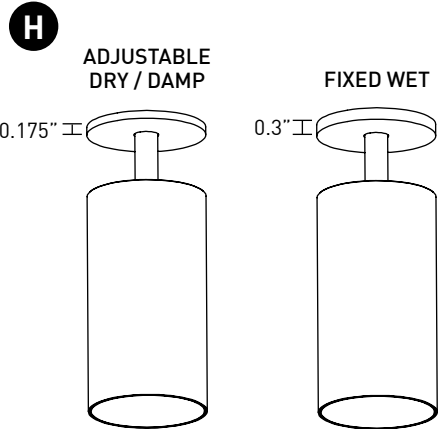
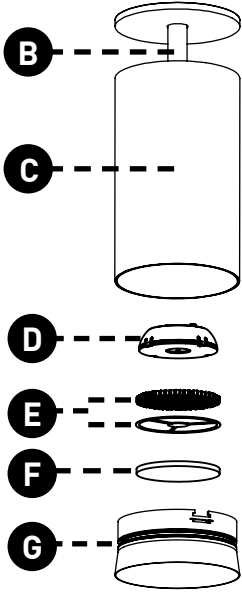
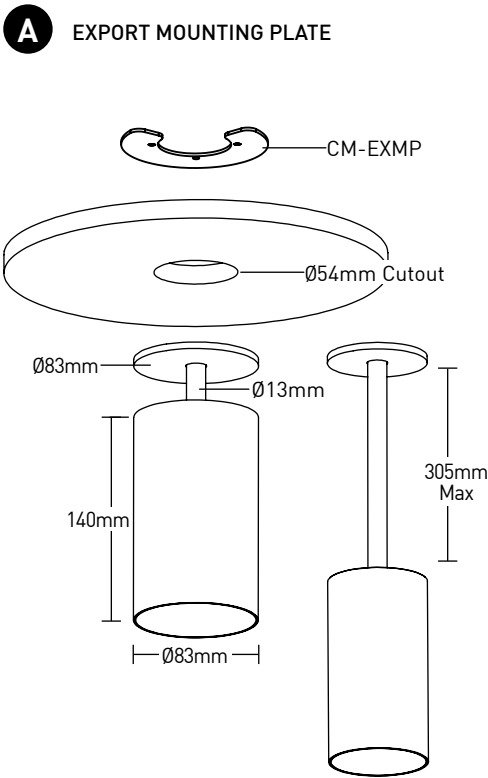

POWER SUPPLY DIMENSIONS			
Model	A	B	C
IG			
IN	41mm	210mm	34mm
ID			
DD	76mm	130mm	30mm

MONOPOINT INTERNATIONAL CM2 SURFACE MOUNT

TECHNICAL

CONSTRUCTION

Monopoint: Machined aluminum body; painted finishes are granulated powder coat; Alumina finishes are anodized aluminum.

STATIC WHITE LED

2-step MacAdam ellipse LED module available in 80+, 90+ and 97+ CRI configurations in color temperatures of 2700K, 3000K, 3500K and 4000K.
3-step MacAdam ellipse LED module available in 90+ CRI configurations in color temperature of 2400K. Average rated lamp life of 50,000 hours.

WARM DIM LED

3-step MacAdam ellipse warm dim LED module available in 90+ CRI configuration. 3000K or 2700K at full brightness, warming to 1800K at full dim. Average rated lamp life of 50,000 hours.

TUNABLE WHITE LED

3-step MacAdam ellipse tunable white LED module available in 90+ CRI configuration. Features tuning ranges of 1800K to 4000K and 2700K to 5000K. Average rated lamp life of 50,000 hours.

POWER SUPPLY PERFORMANCE AND DIMMING INFORMATION

	PHASE		0-10V		DALI	
Power Supply	IE	IG	IN	ID	DD	
Minimum °C	-20 °C	-20 °C	-20 °C	-20 °C	-20 °C	
Maximum °C	40 °C	40 °C	40 °C	40 °C	40 °C	
Dimming %	2.0%	0.1%	0.1%	0.1%	0.1%	

Note: For IG and IN drivers consult chart on page 6 to confirm appropriate dimming curve for compatibility with selected control.

MAXIMUM ALLOWABLE REMOTE DRIVER WIRING DISTANCES

	WIRE AWG				
DRIVER	12	14	16	18	20
IG, IN, ID, DD	-	-	118'	72'	46'

LISTING

Monopoints and drivers CE Listed for Dry / Damp and IP65 Wet locations. Integral drivers ENEC and CB Listed. NOM Certified.

DECLARE

LBC Red List Approved.

PART L

Part L compliant for all 75+ LPW residential and 95+ LPW commercial configurations.

LIMITED WARRANTY

Manufacturer's Limited Warranty guarantees product(s) listed to be free from defects in material and workmanship under normal use and service for 1-year. LED and power supplies are warranted to operate with 70% of original flux and remain within a range of 3 duv for a period of 5-years. Warranty period begins from the date of shipment by Seller. [Consult website for full warranty terms and conditions.](#)

CHANGE LOG

1. 04/27/2023: ADDED AU AND BB FINISHES OPTIONS FOR BODY AND STEM.
2. 08/07/2023: ADDED NEW LED AND OPTIC OFFERINGS. REMOVED 2400K OFFERING.
3. 01/17/2024: ADDED IP65 WET RATED FIXED FIXTURE, 2400K, AND INTEGRAL WARM DIM OFFERINGS.
4. 02/13/2024: ADDED TUNABLE WHITE OFFERING.
5. 2/15/2024: PART L COMPLIANCE ADDED
6. 03/18/2024: UPDATED 10 DEGREE NARROW BEAM TO UTILIZE FILED REDUCER.
7. 09/19/2024: UPDATED WITH NEW BAFFLE DESIGN.
8. 05/07/2025: UPDATED WARM DIM OFFERING.



MONOPOINT INTERNATIONAL CM2 SURFACE MOUNT

DIMMING COMPATABILITY

eldoLED DRIVER COMPATIBILITY

Power supply IG Manufacturer	Family/Model #
Busch-Jaeger	2112U-101
Jung	240-10
Leviton Lighting Controls	IP710-DLX
Lightolier Controls	ZP600FAM120
Merten	5729
Pass & Seymour	CD4FB-W
The Watt Stopper	DCLV1
Synergy	ISD BC
Crestron®	GLX-DIMFLV8
Crestron®	GLXP-DIMFLV8
Crestron®	GLPAC-DIMFLV4-*
Crestron®	GLPAC-DIMFLV8-*
Crestron®	GLPP-DIMFLVEX-PM
Crestron®	GLPP-1DIMFLV2EX-PM
Crestron®	GLPP-1DIMFLV3EX-PM
Crestron®	DIN-A08
Crestron®	DIN-4DIMFLV4
Crestron®	CLS-EXP-DIMFLV
Crestron®	CLCI-1DIMFLV2EX
Power supply IN Manufacturer	Family/Model #
Lutron Electronics	Nova T® - NTFTV
Lutron Electronics	Diva® - DDTV
Lutron Electronics	Nova® - NFTV
Lutron Electronics	GrafixEye® GRX-TVI w GRX3503
Lutron Electronics	Energy Savr Node™ - QSN-4T16-S
Lutron Electronics	TVM2 Module
Sensor Switch	nIO EZ
ABB	SD/S 2.16.1