

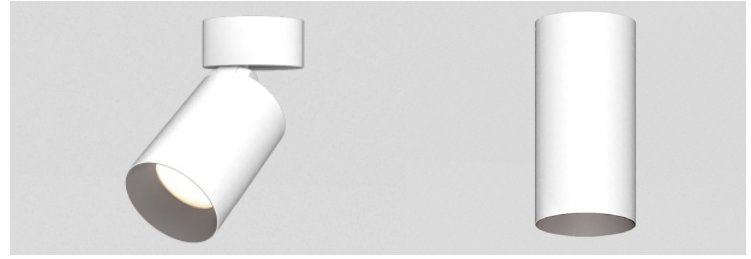



CYLINDER CY4  
INTERNATIONAL  
SURFACE MOUNT

Highlight art, objects, places, spaces, seating areas, and architectural details with a classic profile that offers easy-to-adjust, in-field versatility.

PROJECT NAME:	TYPE:
---------------	-------



## ORDERING INFORMATION

CYLINDER	FIXTURE	RATING	CYLINDER FINISH	BAFFLE FINISH		CRI / WATTAGE PACK-AGE	CCT	OPTIC(UGR)	DRIVER	MEDIA	MOUNTING		
CY4X													
CY4X 4.90"	AD Standard 90° FB Fixed Body WW Wallwash	1 Dry/Damp (IP30) 2 Wet (IP55)	WH White	WH White	STATIC WHITE	 STATIC WHITE	24 2400K* *[90 CRI only]	15 15° (<10)	INTEGRAL (220-240V)	STANDARD MEDIA	EXMP Export Mounting Plate  CMJB 1/2" and 3/4" Conduit Ceiling Mount Junction Box*  *(Not available for IP55 Wet locations)		
			AG Satin Silver	AG Satin Silver			27 2700K	25 25° (<10)				2IG 1% 0-10V Analog, LOG	
			AU Cashmere Gold	AU Cashmere Gold			30 3000K	40 40° (<10)				2IN 1% 0-10V Analog, LIN	
			AB Architectural Bronze	AB Architectural Bronze			35 3500K	60 60° (<16)				REMOTE (220-240V)	
			BB Burnt Bronze	BB Burnt Bronze			40 4000K	WW Wallwash Optic* (<16) *(Required for Wallwash fixtures)					2EG eldoLED, 0.1% 0-10V, LOG
			BK Black	BK Black				2EN eldoLED, 0.1% 0-10V, LIN					
			CF Custom Finish* *(Consult Factory)	CF Custom Finish* *(Consult Factory)	WARM DIM	 WARM DIM	WL 2700K - 1800K	15 15° (<10)	TUNABLE WHITE REMOTE (220-240V)	OPTIONAL MEDIA			
			90L	30B 30W				25 25° (<10)				0 No Lens* *(Not available for IP55 Wet locations)	
				39B 39W Incandescent Profile 30B - 2201 Lm 39B - 2733 Lm				40 40° (<10)				2 Honeycomb Louver* *(Not available for IP55 Wet locations)	
				Halogen Profile 30B - 2336 Lm 39B - 2845 Lm				60 60° (<16)				3 Clear Glass Lens	
			*SEE PAGE 3 FOR DETAILED PERFORMANCE CONFIGURATIONS AND WARM DIM PROFILE COMPARISON.	WD 3000K - 1800K	*(Required for Wallwash fixtures)		5 Frosted Glass Lens						
90T	TUNABLE WHITE	 TUNABLE WHITE	30B 30W	TH 5000K - 2700K	15 15° (<10)	2DD eldoLED, DUALdrive 0.1% DALI, LOG	6 Frosted Soft Focus Lens						
			39B 39W Cool Profile 30B - 2231 Lm 39B - 2720 Lm		25 25° (<10)			7 Frosted Linear Spread Lens					
			Warm Profile 30B - 2084 Lm 39B - 2587 Lm		40 40° (<10)								
			*ALL DELIVERED LUMEN OUTPUTS REFLECT 3000K PAIRED WITH 40° AND STANDARD MEDIA.	TR 4000K - 1800K	60 60° (<16)	WW Wallwash Optic* (<16) *(Required for Wallwash fixtures)							
						*SEE PAGE 3 FOR UGR RATINGS							

## POWDERCOAT FINISHES



## PART NUMBER NOTES

- CY4X-AD ships as e.g., CY4XAD1WHBK90C29B342IG\*4
- CY4X-FB ships as e.g., CY4XFB1WHBK80C34B4421G\*4
- CY4X-WW ships as e.g., CY4XWW1WHBK90C29B352IG\*W
- Remote driver ships as e.g., PSCY4X-INT-90C-29B-EG\*
- CMJB ships as CY4X-CMJB-[finish]

# CYLINDER 4 INTERNATIONAL SURFACE MOUNT

## ACCESSORIES

### ALTERNATE EFFECTS DEVICES - INCLUDES LENS RETAINER

- ☐ **HCL-CY4X-01** Honeycomb Louver \*  
\*(Not available for IP55 Wet location)
- ☐ **CGL-CY4X-01** Clear Glass Lens
- ☐ **SFL-CY4X-01** Soft Focus Lens
- ☐ **FGL-CY4X-01** Frosted Glass Lens
- ☐ **FSFL-CY4X-01** Frosted Soft Focus Lens
- ☐ **FLSL-CY4X-01** Frosted Linear Spread Lens

### REPLACEMENT OPTIC ASSEMBLIES

- ☐ **RO-90-15** 15° optic
- ☐ **RO-90-20** 20° optic
- ☐ **RO-90-25** 25° optic
- ☐ **RO-90-40** 40° optic
- ☐ **RO-90-60** 60° optic
- ☐ **RO-90-WW** Wallwash optic

CYLINDER 4 INTERNATIONAL SURFACE MOUNT

PERFORMANCE - 3000K - STANDARD EFFECTS DEVICE

LUMEN PACKAGE	WATTAGE	15° OPTIC		25° OPTIC		40° OPTIC		60° OPTIC		WALLWASH OPTIC	
		DELIVERED	LPW	DELIVERED	LPW	DELIVERED	LPW	DELIVERED	LPW	DELIVERED	LPW
80S30E	30	3193	106	3030	101	3104	103	2930	98	3068	102
80S41E	41	4272	104	3930	96	4056	99	3825	93	4042	99
80S51E	51	5073	99	4717	92	4851	95	4590	90	4852	95
90S30E	30	2743	91	2603	87	2667	89	2517	84	2636	88
90S41E	41	3670	90	3376	82	3484	85	3286	80	3472	85
90S51E	51	4358	85	4052	79	4167	82	3943	77	4168	82
97S30E	30	2408	80	2285	76	2342	78	2210	74	2314	77
97S41E	41	3222	79	2964	72	3059	75	2885	70	3048	74
97S51E	51	3826	75	3558	70	3659	72	3462	68	3659	72
90L30BL (2700K-1800K)	30	2245	75	2153	72	2201	73	2123	71	2190	73
90L30BD (3000K-1800K)	30	2383	79	2285	76	2336	78	2254	75	2325	78
90L39BL (2700K-1800K)	39	2788	71	2673	69	2733	70	2637	68	2720	70
90L39BD (3000K-1800K)	39	2902	74	2783	71	2845	73	2745	70	2831	73
90T30BH (5000K-2700K)	30	2313	77	2197	73	2331	74	2110	70	2205	74
90T39BH (5000K-2700K)	39	2827	72	2720	70	2770	71	2628	67	2778	71
90T30BR (4000K-1800K)	30	2160	72	2052	68	2084	69	1971	66	2059	69
90T39BR (4000K-1800K)	39	2640	68	2540	65	2587	66	2454	63	2594	67

OUTPUT MULTIPLIER	
CCT	CCT SCALE
2400K	0.76
2700K	0.97
3000K	1.00
3500K	1.03
4000K	1.08

MEDIA LIGHT LOSS FACTOR	
MEDIA	LIGHT LOSS FACTOR
NO LENS	1.05
CGL	1.00
SFL	1.00
FGL	0.89
FSFL	0.87
FLSL	0.82
HCL	0.65

TUNABLE WHITE MULTIPLIER		
CCT	5000K-2700K	4000K-1800K
5000K	1.16	-
4000K	1.08	1.14
3500K	1.04	1.07
3000K	1.00	1.00
2700K	0.96	0.92
2400K	-	0.84
1800K	-	0.69

UNIFIED GLARE RATING

15° OPTIC SOFT FOCUS LENS	25° OPTIC SOFT FOCUS LENS	40° OPTIC SOFT FOCUS LENS	60° OPTIC SOFT FOCUS LENS	WALLWASH OPTIC
<10	<10	<10	<16	<16

WARM DIM PERFORMANCE - SOFT FOCUS LENS - 40° OPTIC

INCANDESCENT PROFILE

90L30BL 2700K - 1800K	Full on 100%	Dimmed to 80%	Dimmed to 70%	Dimmed to 50%	Dimmed to 20%	Dimmed to 10%	Dimmed to 2%
CCT (K)	2700K	2700K	2700K	2700K	2400K	1900K	1800K
Light Output (Lm)	2201	1761	1541	1101	440	220	44
Power (W)	30	24	21	15	6	3	0.6
Efficacy (LPW)	73	73	73	73	73	73	73
90L39BL 2700K - 1800K	Full on 100%	Dimmed to 80%	Dimmed to 70%	Dimmed to 50%	Dimmed to 20%	Dimmed to 10%	Dimmed to 2%
CCT (K)	2700K	2700K	2700K	2700K	2500K	2000K	1800K
Light Output (Lm)	2733	2186	1913	1367	547	273	55
Power (W)	24	31.2	27.3	19.5	7.8	2.4	0.5
Efficacy (LPW)	70	70	70	70	70	70	70

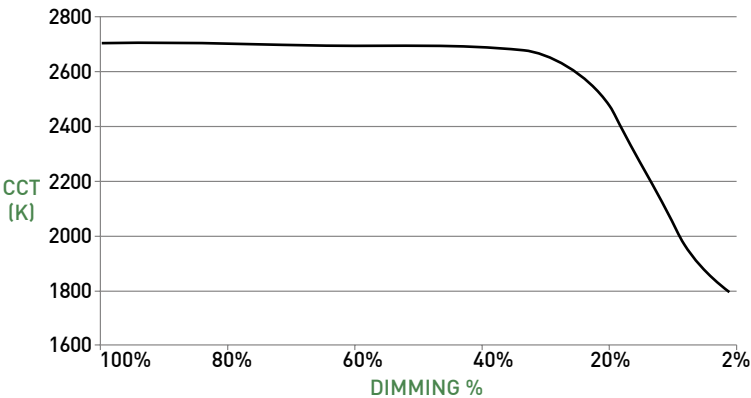

HALOGEN PROFILE

90L30BD 3000K - 1800K	Full on 100%	Dimmed to 80%	Dimmed to 70%	Dimmed to 50%	Dimmed to 20%	Dimmed to 10%	Dimmed to 2%
CCT (K)	3000K	3000K	3000K	3000K	2550K	1850K	1800K
Light Output (Lm)	2336	1869	1635	1168	467	234	47
Power (W)	30	24	21	15	6	3	0.3
Efficacy (LPW)	78	78	78	78	78	78	78
90L39BD 3000K - 1800K	Full on 100%	Dimmed to 80%	Dimmed to 70%	Dimmed to 50%	Dimmed to 20%	Dimmed to 10%	Dimmed to 2%
CCT (K)	3000K	3000K	3000K	3000K	2700K	2000K	1800K
Light Output (Lm)	2845	2276	1992	1423	569	285	57
Power (W)	24	31.2	27.3	19.5	7.8	2.4	0.5
Efficacy (LPW)	78	78	78	78	78	78	78

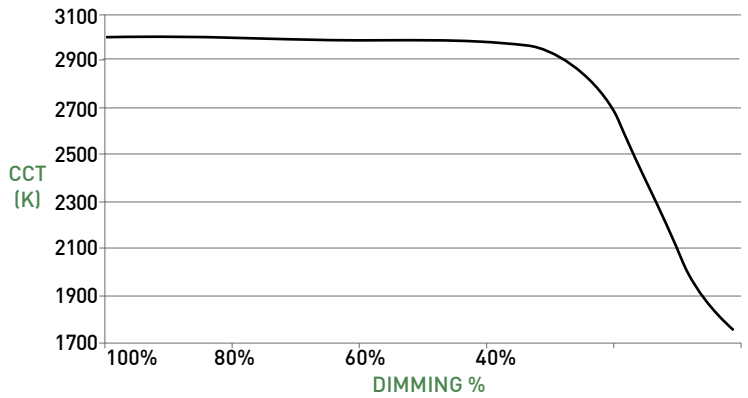

NOTE: LIN-TO-LIN 0-10V PAIRING NOT COMPATIBLE WITH WARM DIM.

# CYLINDER 4 INTERNATIONAL SURFACE MOUNT

## FIXTURE

- A LUMINAIRE**  
Body with integrated heat sink and LED. Conceals hidden twist-on mounting hardware. Power supply may be integral or remote mount.
- B ADJUSTABLE CANOPY**  
Die-cast canopy accommodates flat and sloped ceiling conditions. Conceals hidden twist-on mounting hardware. Features 90° tilt and 58mm tall canopy. Available with integral or remote driver.
- C ADJUSTABLE AND FIXED BODY OPTIC**  
Robust light engine with optimized optic pairing integrates Reflection, Refraction and TIR offering 15°, 25°, 40° & 60° beams.
- WALLWASH OPTIC**  
Robust light engine with precision tuned kick reflector and optic provide uniform wallwashing effect.
- D ADJUSTABLE AND FIXED BODY LENS RETAINER**  
Threaded lens retainer attaches to baffle and accommodates up to two media.
- E ADJUSTABLE AND FIXED BODY MEDIA**  
Soft focus lens standard. Media is field-changeable in Dry/Damp and Wet locations.
- WALLWASH MEDIA**  
Wallwash lens is fixed to baffle and not field changeable.
- F BAFFLE**  
Die-cast baffle minimizes aperture glare and conceals view into fixture.

## DIMENSIONS / DRAWINGS

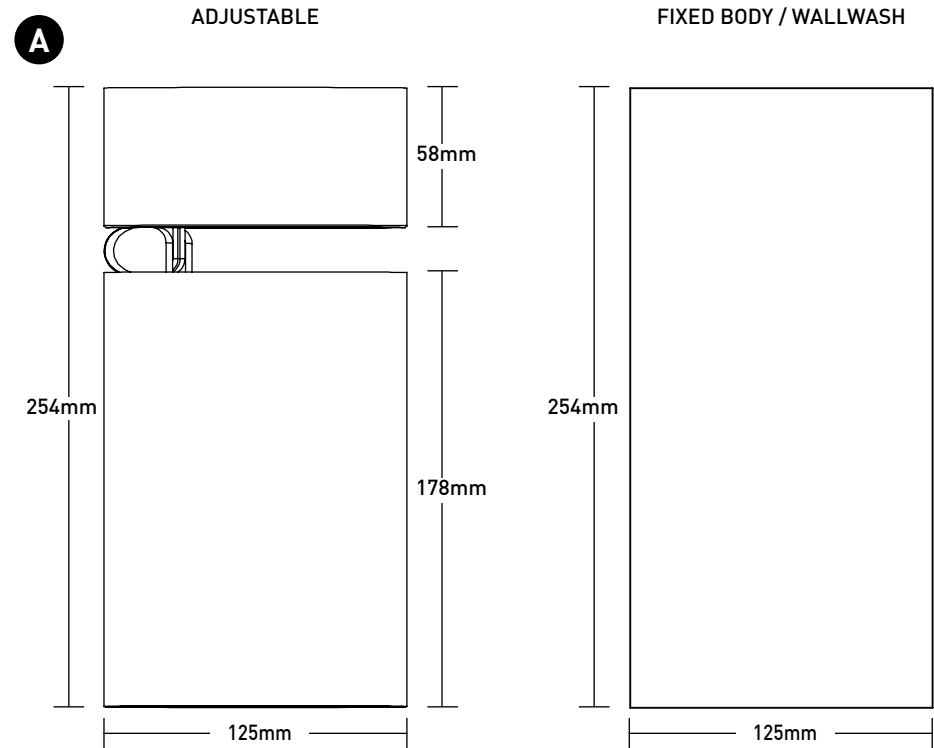

Fixture Weight - 6.0 lbs

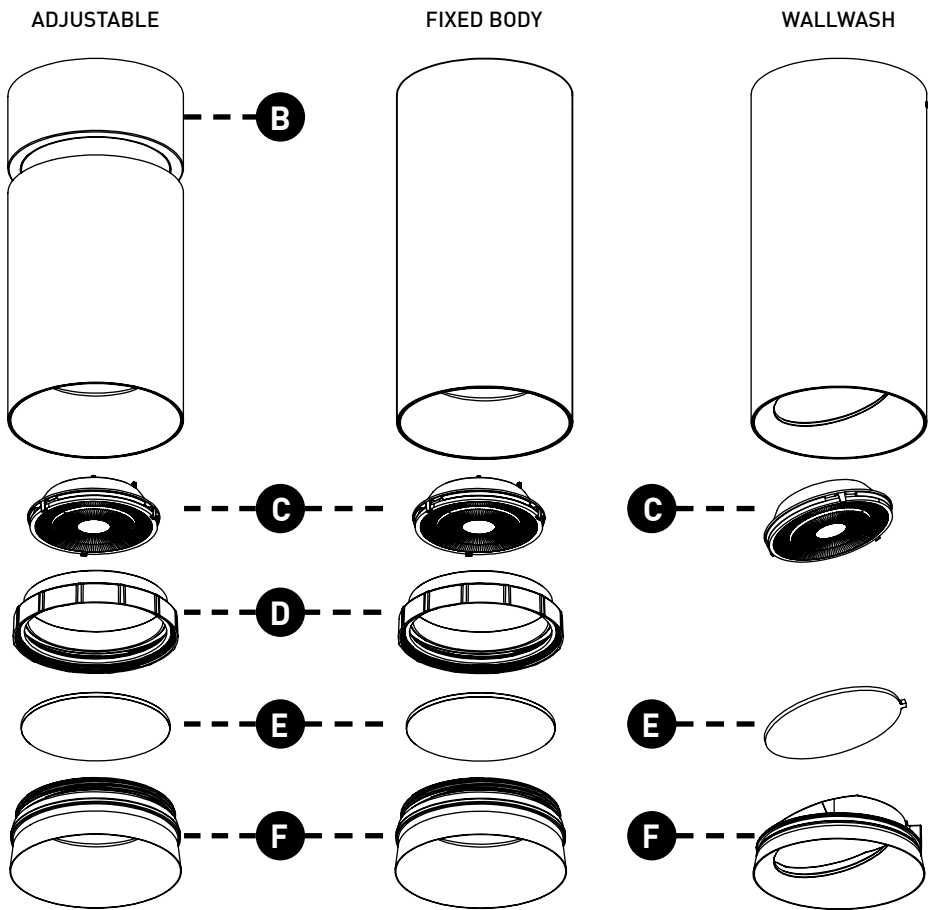

# CYLINDER 4 INTERNATIONAL SURFACE MOUNT

## MOUNTING

- G

**MOUNTING ASSEMBLY**

Surface mounted, does not require installation prior to rough-in. Mounting plate sits atop ceiling for attachment of mounting adaptor. Fixture mounts flush with minimalist transition to ceiling.
- H

**CMJB**

Ceiling mount junction box perfectly matches the cylinder profile for a continuous, integrated look where exposed ceiling mount junction box and conduit applications apply. For use with 1/2" and 3/4" EMT conduit only. Features three conduit entrances at 12, 3, and 6 o'clock plus one conduit knockout on top. Painted finishes only. Blank off plugs included.

## MOUNTING NOTES

- Fixtures are surface mount and must have access to free air. For applications involving slat ceilings or confined mounting, consult Comprehensive Install Guide for required clearances for proper air flow and servicing.

## REMOTE POWER SUPPLY

- I

**PS-RMT**

Do not install in environments where ambient temperatures exceed 35°C (95°F). Remote power supply provides additional driver options. Mounting device still required. Consult install guide for maximum allowable secondary run lengths between PS-RMT and fixture.

## DIMENSIONS / DRAWINGS

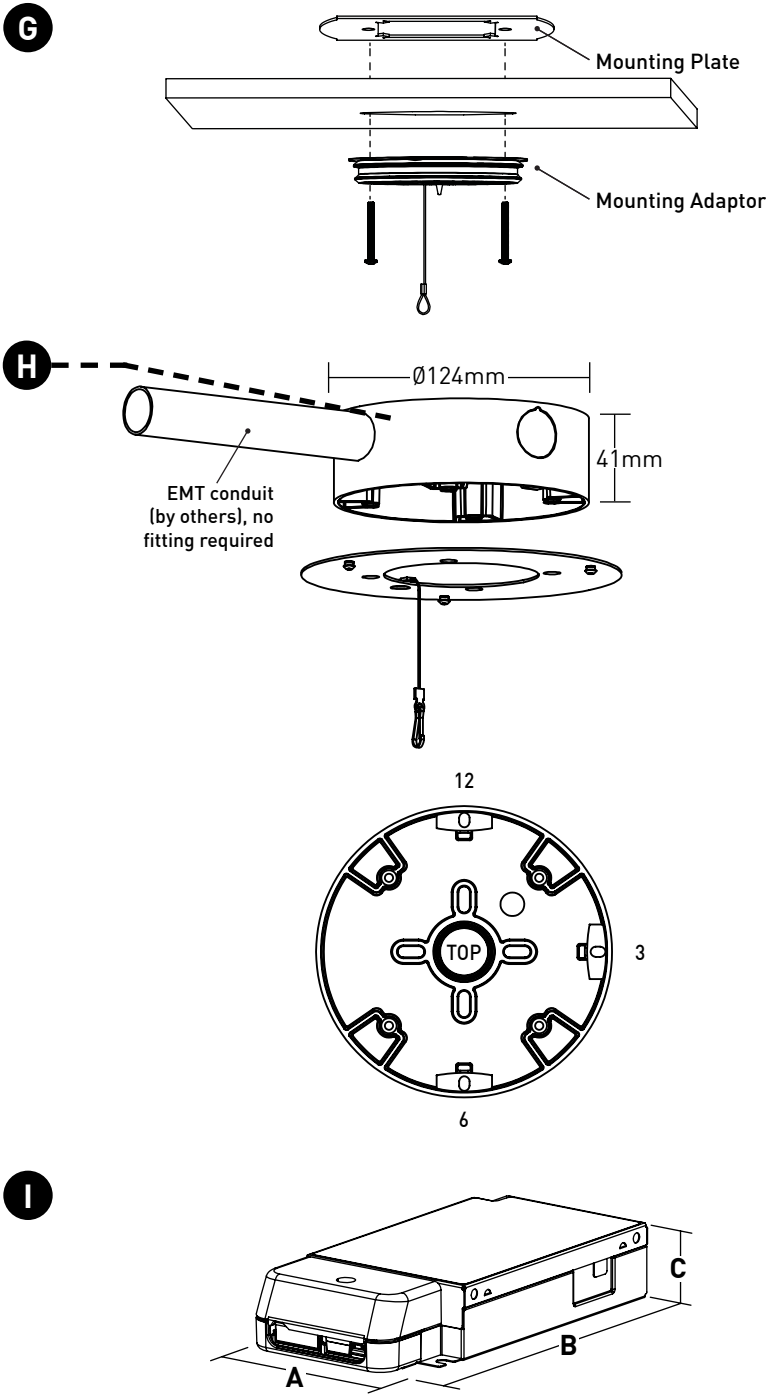

POWER SUPPLY DIMENSIONS			
Model	A	B	C
2EG (30W)	41mm	210mm	34mm
2EN (30W)			
2ED (30W)			
2EG (50W)	76mm	152mm	30mm
2EN (50W)			
2ED (50W)			
2DD			

# CYLINDER 4 INTERNATIONAL SURFACE MOUNT

## TECHNICAL

### CONSTRUCTION

**Cylinder:** Machined aluminum body; extruded aluminum internal heat-sink; painted finishes are granulated powder coat.  
**CMJB:** Die-cast aluminum body; painted finishes are granulated powder coat.  
**Remote Power Supply:** Varies. Consult factory for additional information.

### LED

2-step MacAdam ellipse LED module available in 80+, 90+ and 97+ CRI configurations in color temperatures of 2700K, 3000K, 3500K and 4000K.  
3-step MacAdam ellipse LED module available in 90+ configuration in color temperature of 2400K. Average rated lamp life of 50,000 hours. LED and driver assemblies are field-replaceable.

### WARM DIM LED

3-step MacAdam ellipse warm dim LED module available in 90+ CRI configuration. 3000K or 2700K at full brightness, warming to 1800K at full dim. Average rated lamp life of 50,000 hours. LED and driver assemblies are field-replaceable.

### TUNABLE WHITE LED

3-step MacAdam ellipse tunable white LED module available in 90+ CRI configuration. Features tuning ranges of 1800K to 4000K and 2700K to 5000K. Average rated lamp life: 50,000 hours. Driver assembly is field-replaceable.

### POWER SUPPLY PERFORMANCE AND DIMMING INFORMATION

Power Supply	2IG	2IN	2EG	2EN	2ED	2DD
Minimum °C	-10 °C	-10 °C	-20 °C	-20 °C	-20 °C	-20 °C
Maximum °C	40 °C	40 °C	40 °C	40 °C	40 °C	40 °C
Dimming %	1.0%	1.0%	0.1%	0.1%	0.1%	0.1%

Note: 2EG and 2EN drivers consult chart on page 7 to confirm appropriate dimming curve for compatibility with selected control.

### MOUNTING

Cylinder is supplied with a mounting adaptor, which integrates with mounting plate and accommodates ceiling thicknesses of 12mm to 19mm. Ceiling-mount junction box available for 13mm and 19mm conduit and features concealed internal clamps for clean fitting-free conduit exit and entry.

### WALLWASH SPACING

Recommended fixture spacing is 48" on center with 48" setback from wall plane.

### LISTING

CE listed for Dry / Damp (IP30) and Wet (IP54) locations. NOM Certified.

### WEIGHT

Adjustable - 5.4 lbs max  
Fixed / Wallwash - 6 lbs max  
Remote Driver - 1.4 lbs

### LIMITED WARRANTY

Manufacturer's 1-year warranty guarantees product(s) listed to be free from defects in material and workmanship under normal use and service. 5-year warranty on LED and power supply to operate with 70% of the original flux and remain within a range of 3 duv. Warranty period begins from the date of shipment by Seller. Consult [website](#) for full warranty terms and conditions.

### CHANGE LOG

- 08/08/2023: ADDED NEW LED AND OPTIC SYSTEM.
- 1/11/2024: ADDED 2400K OFFERING, ADDED RESIDENTIAL TW OFFERING.
- 07/11/2024: UPDATED AVAILABLE POWDERCOAT FINISHES.
- 05/07/2025: UPDATED WARM DIM OFFERINGS AND PERFORMANCE

# CYLINDER 4 INTERNATIONAL SURFACE MOUNT

## DIMMING COMPATIBILITY

### eldoLED DRIVER COMPATIBILITY

Power supply 2EG / 2EN Dimmer / Switch Control Manufacturer	Family/Model #
Busch-Jaeger	2112U-101
Jung	240-10
Leviton Lighting Controls	IP710-DLX
Lightolier Controls	ZP600FAM120
Lutron Electronics	Nova T® - NTFTV
Lutron Electronics	Diva® - DVTV
Lutron Electronics	Nova® - NFTV
Merten	5729
Pass & Seymour	CD4FB-W
The Watt Stopper	DCLV1
Sensor Switch	nIO EZ
Synergy	ISD BC
Power supply 2EG / 2EN Lighting Control Systems Manufacturer	Family/Model #
Lutron Electronics	GrafixEye® GRX-TVI w GRX3503
Lutron Electronics	Energy Savr Node™ - QSN-4T16-S
Lutron Electronics	TVM2 Module
Crestron®	GLX-DIMFLV8
Crestron®	GLXP-DIMFLV8
Crestron®	GLPAC-DIMFLV4-*
Crestron®	GLPAC-DIMFLV8-*
Crestron®	GLPP-DIMFLVEX-PM
Crestron®	GLPP-1DIMFLV2EX-PM
Crestron®	GLPP-1DIMFLV3EX-PM
Crestron®	DIN-A08
Crestron®	DIN-4DIMFLV4
Crestron®	CLS-EXP-DIMFLV
Crestron®	CLCI-1DIMFLV2EX
ABB	SD/S 2.16.1

### ANALOG DRIVERS AND DIMMERS

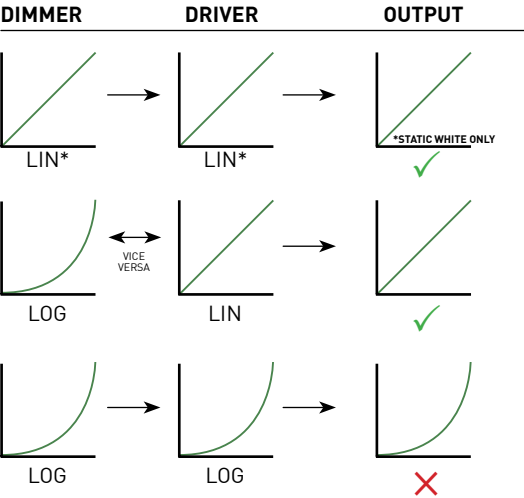

LIN = LINEAR  
LOG = LOGARITHMIC  
\*LIN-TO-LIN NOT COMPATIBLE FOR WARM-DIM