

1 SERIES INT FIXED

PROJECT NAME:	TYPE:
---------------	-------

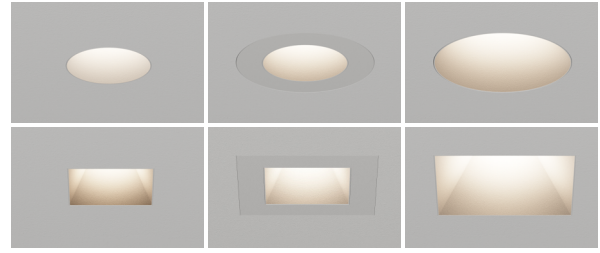

- Max output of 971Lm at 80+ CRI
- Available with trimless and zero sightline baffles, featuring 1" and 1.6" apertures
- Expanded baffles feature UGR value of <7

ORDERING INFORMATION - FIXTURE

TRIM	RATING	TYPE	BAFFLE & MOUNTING	EXTERIOR FINISH	INTERIOR FINISH	CRI	WATTAGE	CCT	OPTIC (UGR)	MEDIA	INSTALL TYPE	CEILING THICKNESS	DRIVER		
		F										1			
1RP 1" (25mm) Round	1 IP20 Dry/Damp	F Fixed	T Trimless	TRIMLESS	POWDERCOAT	80S 80+ CRI 90S 90+ CRI 95S 95+ CRI	STATIC WHITE			NL No Lens 01 Clear Film* *(Required for wet location)	EXPORT (REMOTE DRIVER) EX Export Remote EN Export NOM EB Export BIS HOUSING (TETHERED DRIVER) HX Housing Export HN Export NOM HB Housing BIS	1 13mm - 38mm	IG1 eldoLED, SOLOdrive 0.1% 0-10V, LOG, 120V-277V IN1 eldoLED, SOLOdrive 0.1% 0-10V, LIN, 120V-277V ID1 eldoLED, SOLOdrive 0.1% DALI-2, LOG, 120V-277V HUB Distributed Power System, Powers up to 6 Fixtures* *(Requires further specification on page 2)		
1SP 1" (25mm) Square	2 IP64 Wet			TG Trimless Gypsum* *(Required for "T" baffle)	WH White AG Satin Silver AU Cashmere Gold		AB Architectural Bronze BB Burnt Bronze BK Black SB Specular Black	1RP/1SP 6W, 480 Lm 11C 11W, 731 Lm 15C 15W, 971 Lm	24 2400K* *(90 CRI only) 27 2700K 30 3000K 35 3500K 40 4000K					20 20° 30 30° 40 40°	
1RE 1.6" (41mm) Round Expanded				G Zero Sightline Gypsum* *(1RP/1SP only)	POWDERCOAT		AB Architectural Bronze BB Burnt Bronze BK Black SB Specular Black	1RE/1SE 6W, 504 Lm 11C 11W, 768 Lm 15C 15W, 970 Lm							
1SE 1.6" (41mm) Square Expanded					WH White AG Satin Silver AU Cashmere Gold AB Architectural Bronze BB Burnt Bronze BK Black SB Specular Black PR Primer CF Custom Finish* *(Consult Factory)		ALUMINA *(Consult Factory) *Brushed finishes only available for round baffles 01 Brushed Obsidian* 02 Matte Obsidian 03 Brushed Dark Patinated Bronze* 04 Matte Dark Patinated Bronze 05 Brushed Aged Aluminum* 06 Matte Aged Aluminum 07 Brushed Cast Brass* 08 Matte Cast Brass 09 Brushed Light Patinated Bronze 10 Matte Light Patinated Bronze	90L 90+ CRI	WARM DIM					40 40°	
							DELIVERED LUMEN OUTPUTS REFLECT 80CRI OR WARM DIM, 3000K, 40° OPTIC, AND NO LENS.								

PART NUMBER NOTES

- Fixture ships as e.g., 1RE2FTTGAU90S15C3540NLEX1IG1
- Housing, driver, trim, and applique ship as one unit

1 SERIES INT FIXED

ACCESSORIES

CONFIGURATION - REQUIRED FOR 'HUB' DRIVER SPECIFICATION

ASSEMBLY	QTY	WATTAGE	REMOTE DRIVER
HUB			
DISTRIBUTED POWER HUB	2X 2 Fixtures	06W 6 Watts	IG1 eldoLED, SOLOdrive 0.1%, 0-10V, LOG, 120V-277V
	3X 3 Fixtures	11W 11 Watts	IN1 eldoLED, SOLOdrive 0.1%, 0-10V, LIN, 120V-277V
	4X 4 Fixtures	15W 15 Watts	ID1 eldoLED, SOLOdrive 0.1%, DALI-2, LOG, 120V-277V
	5X 5 Fixtures		
	6X 6 Fixtures		

PART NUMBER NOTES

- Configuration e.g.HUB2X15W-IG1, ordered as separate line item

COMPATIBILITY BY DRIVER TYPE AND QUANTITY

DRIVER	HUB2X			HUB3X			HUB4X			HUB5X			HUB6X		
	06W	11W	15W	06W	11W	15W	06W	11W	15W	06W	11W	15W	06W	11W	15W
IG/IN/ID	✓	✓	✓	✓	✓	✓	✓	✓		✓			✓		

ACCESSORIES

REPLACEMENT OPTICS

Interchangeable optics accessible through fixture aperture.

STATIC WHITE

WARM DIM

- ☐ **RO-17-20** 20° optic
- ☐ **RO-17-30** 30° optic
- ☐ **RO-17-40** 40° optic
- ☐ **RO-17-40-W** 40° optic

REPLACEMENT BAFFLE ASSEMBLY (INCLUDES MEDIA)

ASSEMBLY	SHAPE	RATING	TYPE	BAFFLE	EXTERIOR FINISH	INTERIOR FINISH	MEDIA
RBA			F				
REPLACEMENT BAFFLE ASSEMBLY	1RP Round 1SP Square 1RE Round 1SE Expanded Square Expanded	1 IP20 Dry/Damp 2 IP64 Wet* * (Baffle removal tool provided for aim and focus)	F Fixed	T Trimless* (Required for 1RE/1SE) G Zero Sightline* (1RP/1SP Only)	TG Trimless Gypsum TM Trimless Millwork WH White AG Satin Silver AU Cashmere Gold AB Arch. Bronze BB Burnt Bronze BK Black PR Primer CF Custom Finish* (Consult Factory) **See page 1 for Alumina finish options	WH White AG Satin Silver AU Cashmere Gold BB Burnt Bronze BK Black PR Primer CF Custom Finish* (Consult Factory) *See page 1 for Alumina finish options	NL No Lens 01 Clear Glass Lens

REPLACEMENT INSTALLATION TOOLS

One included with every six fixtures designated Wet location.

- ☐ **01S-TOOL-BAFFLE-REMOVAL** Allows for baffle removal with Wet location
- ☐ **01S-TOOL-ENGINE-INST-REMOVAL** Allows for installation of LED module
- ☐ **01S-TOOL-ENGINE-BAFFLE-COMBO** Includes both baffle removal tool and LED installation tool

HANGER BAR EXTENDER KIT

Extends hanger bars from 24.0" to 46.0" maximum.

- ☐ **FRX-HBE-46** Extender, Hanger Bar

POWDERCOAT FINISHES

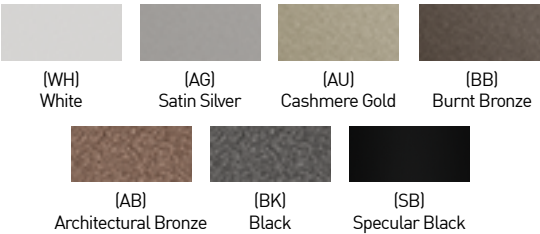

ALUMINA FINISHES BY LUCIFER LIGHTING™



1 SERIES INT FIXED

PERFORMANCE - 1RP - 3000K - NO LENS

LUMEN PACKAGE	WATTS	20° OPTIC		30° OPTIC		40° OPTIC	
		DLVD	LPW	DLVD	LPW	DLVD	LPW
80S06C	6	223	37	384	64	480	80
80S11C	11	340	31	585	53	731	66
80S15C	15	451	30	777	52	971	65
90S06C	6	193	32	332	55	415	69
90S11C	11	294	27	506	46	632	57
90S15C	15	390	26	672	45	839	56
95S06C	6	139	23	239	40	298	50
95S11C	11	211	19	363	33	454	41
95S15C	15	280	19	483	32	603	40
90L11DL (27K-18K)	11	-	-	-	-	363	33
90L11DD (30K-18K)	11	-	-	-	-	385	35
90L15DL (27K-18K)	15	-	-	-	-	481	32
90L15DD (30K-18K)	15	-	-	-	-	511	34

OUTPUT MULTIPLIER	
CCT	CCT SCALE
2400K	0.89
2700K	0.98
3000K	1.00
3500K	1.09
4000K	1.14

MEDIA LIGHT LOSS MULTIPLIER	
MEDIA	LIGHT LOSS FACTOR
NO LENS	1.00
LENS	0.93

FINISH MULTIPLIER	
CCT	CCT SCALE
WHITE	1.00
BLACK	0.98
SPECULAR BLACK	0.98

UNIFIED GLARE RATING		
20° OPTIC	30° OPTIC	40° OPTIC
<13	<13	<10

WARM DIM PERFORMANCE - NO LENS - 40° OPTIC

INCANDESCENT PROFILE - TRIMLESS

90L11DL 2700K - 1800K	Full on 100%	Dimmed to 80%	Dimmed to 70%	Dimmed to 50%	Dimmed to 20%	Dimmed to 10%	Dimmed to 2%
CCT (K)	2700K	2700K	2700K	2700K	2500K	1900K	1800K
Light Output (Lm)	363	290	254	182	73	36	7
Power (W)	11	8.8	7.7	5.5	2.2	1.1	0.2
Efficacy (LPW)	33	33	33	33	33	33	33
90L15DL 2700K - 1800K	Full on 100%	Dimmed to 80%	Dimmed to 70%	Dimmed to 50%	Dimmed to 20%	Dimmed to 10%	Dimmed to 2%
CCT (K)	2700K	2700K	2700K	2700K	2500K	1900K	1800K
Light Output (Lm)	481	385	337	241	96	48	10
Power (W)	15	12	10.5	7.5	3	1.5	0.3
Efficacy (LPW)	32	32	32	32	32	32	32

HALOGEN PROFILE - TRIMLESS

90L11DD 3000K - 1800K	Full on 100%	Dimmed to 80%	Dimmed to 70%	Dimmed to 50%	Dimmed to 20%	Dimmed to 10%	Dimmed to 2%
CCT (K)	3000K	3000K	3000K	3000K	3000K	2000K	1800K
Light Output (Lm)	385	308	270	193	77	39	8
Power (W)	11	8.8	7.7	5.5	2.2	1.1	0.2
Efficacy (LPW)	33	33	33	33	33	33	33
90L15DD 3000K - 1800K	Full on 100%	Dimmed to 80%	Dimmed to 70%	Dimmed to 50%	Dimmed to 20%	Dimmed to 10%	Dimmed to 2%
CCT (K)	3000K	3000K	3000K	3000K	3000K	2000K	1800K
Light Output (Lm)	511	409	358	256	102	51	10
Power (W)	15	12	10.5	7.5	3	1.5	0.3
Efficacy (LPW)	35	35	35	35	35	35	35

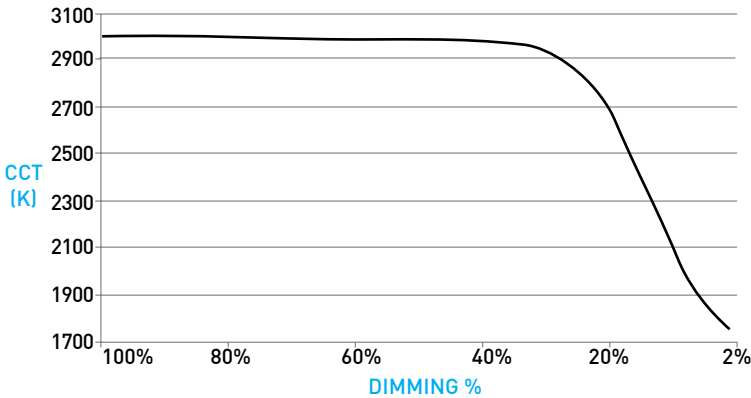
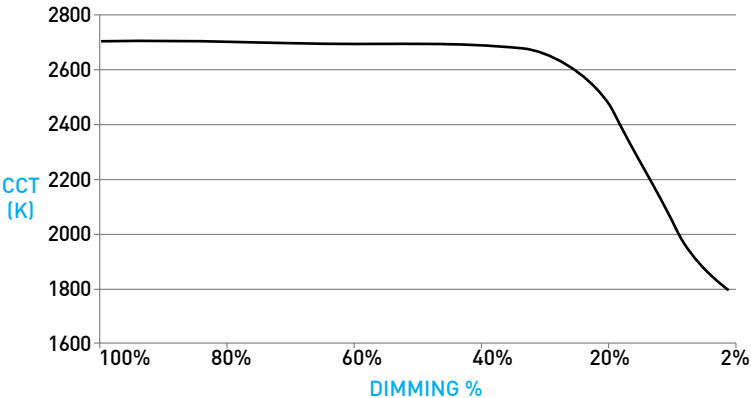

NOTE: LIN-TO-LIN 0-10V PAIRING NOT COMPATIBLE WITH WARM DIM.

1 SERIES INT FIXED

PERFORMANCE - 1RE - 3000K - NO LENS

LUMEN PACKAGE	WATTS	20° OPTIC		30° OPTIC		40° OPTIC	
		DLVD	LPW	DLVD	LPW	DLVD	LPW
80S06C	6	222	37	393	65	504	84
80S11C	11	338	31	598	54	768	70
80S15C	15	449	30	795	53	970	65
90S06C	6	192	32	340	57	436	73
90S11C	11	292	27	517	47	664	60
90S15C	15	388	26	687	46	839	56
95S06C	6	138	23	244	41	313	52
95S11C	11	210	19	372	34	477	43
95S15C	15	279	19	494	33	611	41
90L11DL (27K-18K)	11	-	-	-	-	370	34
90L11DD (30K-18K)	11	-	-	-	-	392	36
90L15DL (27K-18K)	15	-	-	-	-	490	33
90L15DD (30K-18K)	15	-	-	-	-	520	35

OUTPUT MULTIPLIER	
CCT	CCT SCALE
2400K	0.89
2700K	0.98
3000K	1.00
3500K	1.09
4000K	1.14

MEDIA LIGHT LOSS MULTIPLIER	
MEDIA	LIGHT LOSS FACTOR
NO LENS	1.00
LENS	0.93

FINISH MULTIPLIER	
CCT	CCT SCALE
WHITE	1.00
BLACK	0.98
SPECULAR BLACK	0.98

UNIFIED GLARE RATING		
20° OPTIC	30° OPTIC	40° OPTIC
<7	<7	<7

WARM DIM PERFORMANCE - NO LENS - 40° OPTIC

INCANDESCENT PROFILE - TRIMLESS

90L11DL 2700K - 1800K	Full on 100%	Dimmed to 80%	Dimmed to 70%	Dimmed to 50%	Dimmed to 20%	Dimmed to 10%	Dimmed to 2%
CCT (K)	2700K	2700K	2700K	2700K	2500K	1900K	1800K
Light Output (Lm)	370	296	259	185	74	37	7
Power (W)	11	8.8	7.7	5.5	2.2	1.1	0.2
Efficacy (LPW)	33	33	33	33	33	33	33
90L15DL 2700K - 1800K	Full on 100%	Dimmed to 80%	Dimmed to 70%	Dimmed to 50%	Dimmed to 20%	Dimmed to 10%	Dimmed to 2%
CCT (K)	2700K	2700K	2700K	2700K	2500K	1900K	1800K
Light Output (Lm)	490	392	343	245	98	49	10
Power (W)	15	12	10.5	7.5	3	1.5	0.3
Efficacy (LPW)	32	32	32	32	32	32	32

HALOGEN PROFILE - TRIMLESS

90L11DD 3000K - 1800K	Full on 100%	Dimmed to 80%	Dimmed to 70%	Dimmed to 50%	Dimmed to 20%	Dimmed to 10%	Dimmed to 2%
CCT (K)	3000K	3000K	3000K	3000K	3000K	2000K	1800K
Light Output (Lm)	392	314	274	196	78	39	8
Power (W)	11	8.8	7.7	5.5	2.2	1.1	0.2
Efficacy (LPW)	33	33	33	33	33	33	33
90L15DD 3000K - 1800K	Full on 100%	Dimmed to 80%	Dimmed to 70%	Dimmed to 50%	Dimmed to 20%	Dimmed to 10%	Dimmed to 2%
CCT (K)	3000K	3000K	3000K	3000K	3000K	2000K	1800K
Light Output (Lm)	520	416	364	260	104	52	10
Power (W)	15	12	10.5	7.5	3	1.5	0.3
Efficacy (LPW)	35	35	35	35	35	35	35

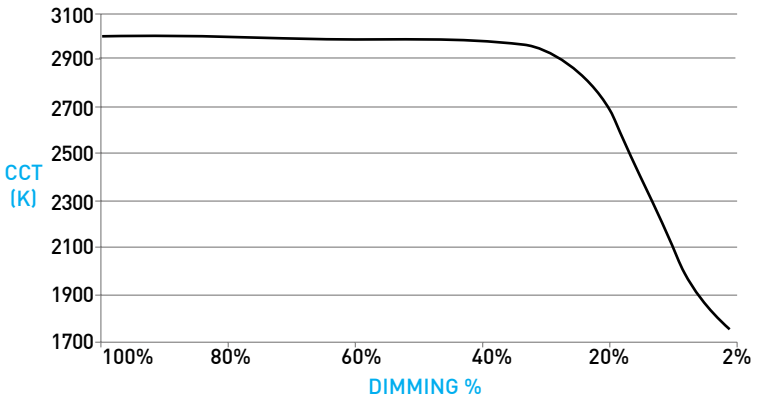
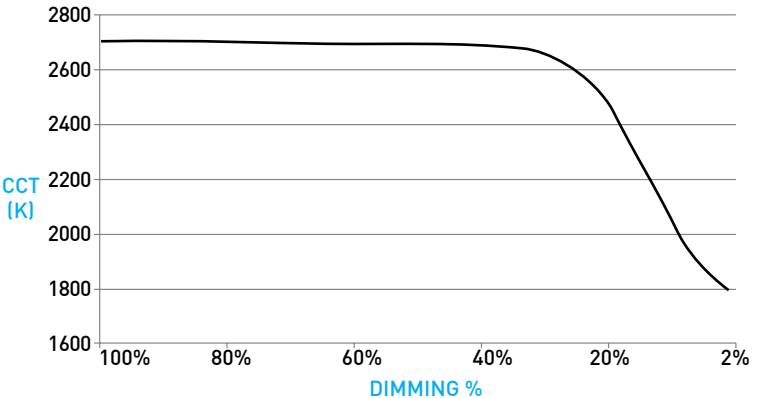

1 SERIES INT FIXED

DOWNLIGHT / HOUSING

A HIGH/LOW WATTAGE REMODEL FITTING

- For "ER" remote installation types.
- IC-rated heatsink, does not have any setback requirements from combustible and non-combustible materials.
- High wattage fitting features 54mm tall heat sink and is available for 15W packages.
- Low wattage fitting features 35mm tall heat sink and is available for 6W and 11W packages only.

B LIGHT ENGINE

Robust light engine with optimized optic pairing integrates Reflection, Refraction, and TIR offering 20°, 30°, and 40° beams.

C REMODEL MOUNTING PLATE / ROUGH-IN TRAY

Tray is supplied with optional hanger bars (uninstalled). Mounting holes align with applique, ensuring secure fixture mounting via factory supplied screws.

- Remodel:** Installs above ceiling without hanger bars, requiring Ø168mm cutout. Rectangular design (157mm x 191mm) allows for installation above ceiling after cutout
- Rough-In:** Install hanger bars using factory supplied screws, using tray opening as cutout guide after ceiling installation. Hanger bars extend to 24".

D ZERO-SIGHTLINE / TRIMLESS DRYWALL PROFILE

Installs totally flush with the ceiling with no visible trim. Applique includes screws for mounting and has 0.06" plaster stop. Not recommended for stucco applications. See page 5 for applique section view and visible baffle profiles after mud-in.

E 1" ZERO-SIGHTLINE / TRIMLESS BAFFLE

CNC-Milled removable baffle provides 45° glare cutoff. Minimizes aperture glare and conceals view into housing; includes gasket. Exterior faceplate available in powdercoat, plated, and alumina finishes; interior finish available in powdercoat and alumina finishes. Available in zero-sightline and trimless profiles.

43mm square ceiling break required for LED/driver servicing.

F 1.6" EXPANDED BAFFLE

CNC-Milled removable baffle provides 46° glare cutoff. Minimizes aperture glare and conceals view into housing; includes gasket. No exterior finish, interior finish available in powdercoat and alumina finishes. Available in trimless profile only.

G FITTING WITH REMOTE POWER SUPPLY

- Requires 168mm cutout.
- Protected wiring and connecting hardware between fitting and power supply.
- Do not install in environments where ambient temperatures exceed 40°C (104°F).
- Fixtures accommodate ceiling thicknesses between 13mm and 38mm
- Hanger bars provided in assembly for rough-in installation to structural framing; hanger bars to be removed for use as **C** Remodel Mounting Plate.

DIMENSIONS / DRAWINGS

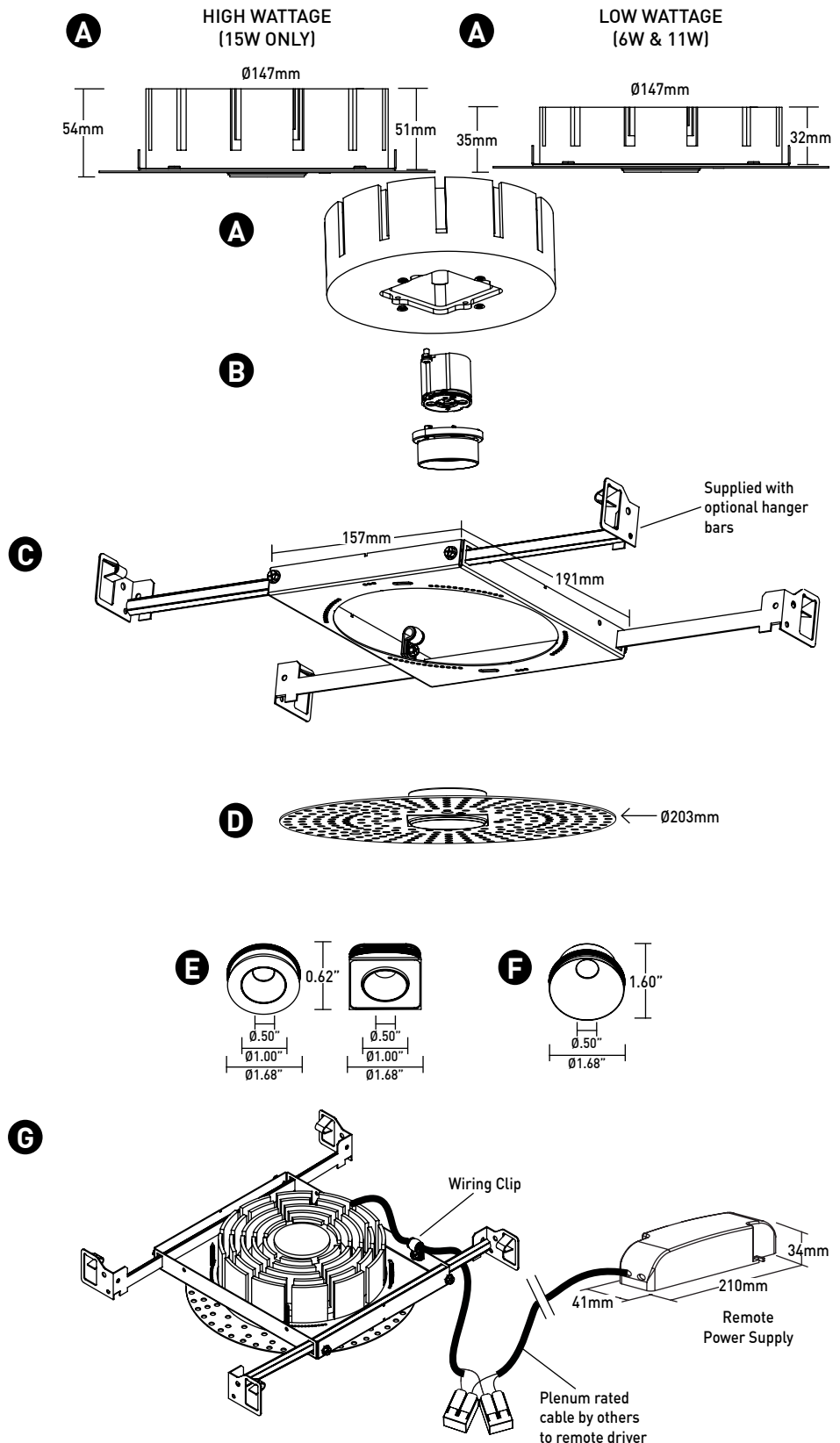

1 SERIES INT FIXED

TECHNICAL

CONSTRUCTION

Downlight: Painted finishes are granulated powder coat; Alumina finishes are anodized aluminum.

Housing: Forged aluminum heat-sink.

Appliqué: Aluminum base with 22 Gauge galvanized steel flange.

STATIC WHITE LED



2-step MacAdam ellipse LED module available in 80+, 90+ and 95+ CRI configurations in color temperatures of 2700K, 3000K, 3500K and 4000K. 3-step MacAdam ellipse LED module available in 90+ CRI configuration in color temperature of 2400K. Average rated lamp life: 50,000 hours. LED and driver assemblies are field-replaceable.

WARM DIM LED



3-step MacAdam ellipse warm dim LED module available in 90+ CRI configuration 3000K or 2700K at full brightness, warming to 1800K at full dim. Average rated lamp life of 50,000 hours. LED and driver assemblies are field-replaceable.

POWER SUPPLY PERFORMANCE AND DIMMING INFORMATION

	0-10V		DALI-2
Power Supply	IG1	IN1	ID1
Minimum °C	-20 °C	-20 °C	-20 °C
Maximum °C	40 °C	40 °C	40 °C
Dimming %	0.1%	0.1%	0.1%

Note: For IG1 and IN1 drivers consult chart on page 8 to confirm appropriate dimming curve for compatibility with selected control

MAXIMUM ALLOWABLE REMOTE DRIVER WIRING DISTANCES (SINGLE FIXTURE, SINGLE DRIVER)

DRIVER	WIRE AWG				
	12	14	16	18	20
IG1, IN1, ID1	-	-	36m	22m	14m

LISTING

CE Listed for IP20 Dry / Damp and IP64 Wet locations.

WEIGHT

32mm Remodel Housing - 1.36kg

51mm Remodel Housing - 1.81kg

Remote Driver - .64kg

LIMITED WARRANTY

Manufacturer's Limited Warranty guarantees product(s) listed to be free from defects in material and workmanship under normal use and service for 1-year. LED and power supplies are warranted to operate with 70% of original flux and remain within a range of 3 duv for a period of 5-years.

10-year Lutron Advantage limited warranty available on Lutron equipped systems. Warranty period begins from the date of shipment by Seller.

CHANGE LOG

1. 05/06/2025: ADDED WARM DIM AND DISTRIBUTED POWER PRODUCT OFFERINGS

eldoLED DRIVER COMPATIBILITY

Power supply IG1 Manufacturer	Family/Model #
Busch-Jaeger	2112U-101
Jung	240-10
Leviton Lighting Controls	IP710-DLX
Lightolier Controls	ZP600FAM120
Merten	5729
Pass & Seymour	CD4FB-W
The Watt Stopper	DCLV1
Synergy	ISD BC
Crestron®	GLX-DIMFLV8
Crestron®	GLXP-DIMFLV8
Crestron®	GLPAC-DIMFLV4-*
Crestron®	GLPAC-DIMFLV8-*
Crestron®	GLPP-DIMFLVEX-PM
Crestron®	GLPP-1DIMFLV2EX-PM
Crestron®	GLPP-1DIMFLV3EX-PM
Crestron®	DIN-A08
Crestron®	DIN-4DIMFLV4
Crestron®	CLS-EXP-DIMFLV
Crestron®	CLCI-1DIMFLV2EX
Power supply IN1	Family/Model #
Lutron Electronics	Nova T® - NTFTV
Lutron Electronics	Diva® - DDTV
Lutron Electronics	Nova® - NFTV
Lutron Electronics	GrafixEye® GRX-TVI w GRX3503
Lutron Electronics	Energy Savr Node™ - QSN-4T16-S
Lutron Electronics	TVM2 Module
Sensor Switch	nI0 EZ
ABB	SD/S 2.16.1

ANALOG DRIVERS AND DIMMERS

