

1 SERIES FIXED REMODEL

PROJECT NAME:	TYPE:
---------------	-------

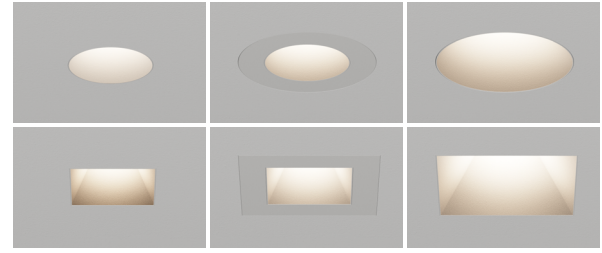

- Max output of 971lm at 80+ CRI
- Available with trimless and zero sightline baffles, featuring 1" and 1.6" apertures
- Expanded baffles feature UGR value of <7

ORDERING INFORMATION - FIXTURE

TRIM	RATING	TYPE	BAFFLE & MOUNTING	EXTERIOR FINISH	INTERIOR FINISH	CRI	WATTAGE	CCT	OPTIC (UGR)	MEDIA	INSTALL TYPE	CEILING THICKNESS	DRIVER
		F										1	
1RP 1SP 1RE 1SE	1 IP20 Dry/Damp 2 IP64 Wet	Fixed	T Trimless G Zero Sightline Gypsum* (*1RP/1SP only)	TRIMLESS TG Trimless Gypsum* (*Required for trimless gypsum) ZERO SIGHTLINE POWDERCOAT WH White AG Satin Silver AU Cashmere Gold AB Architectural Bronze BB Burnt Bronze BK Black SB Specular Black PR Primer CF Custom Finish* (*Consult Factory) ALUMINA 01 Brushed Obsidian* 02 Matte Obsidian 03 Brushed Dark Patinated Bronze* 04 Matte Dark Patinated Bronze 05 Brushed Aged Aluminum 06 Matte Aged Aluminum 07 Brushed Cast Brass 08 Matte Cast Brass 09 Brushed Light Patinated Bronze 10 Matte Light Patinated Bronze	POWDERCOAT WH White AG Satin Silver AU Cashmere Gold AB Architectural Bronze BB Burnt Bronze BK Black SB Specular Black PR Primer CF Custom Finish* (*Consult Factory) ALUMINA *Brushed finishes only available for round baffles 01 Brushed Obsidian* 02 Matte Obsidian 03 Brushed Dark Patinated Bronze* 04 Matte Dark Patinated Bronze 05 Brushed Aged Aluminum* 06 Matte Aged Aluminum 07 Brushed Cast Brass* 08 Matte Cast Brass 09 Brushed Light Patinated Bronze* 10 Matte Light Patinated Bronze FINISH IMAGES ON PAGE 2	STATIC WHITE 80S 80+ CRI 90S 90+ CRI 95S 95+ CRI	1RP/1SP 06C 6W, 415 lm 11C 11W, 632 lm 15C 15W, 839 lm 1RE/1SE 06C 6W, 436 lm 11C 11W, 664 lm 15C 15W, 839 lm DELIVERED LUMEN OUTPUTS REFLECT 90CRI, 3000K, 40° OPTIC, AND NO LENS.	24 2400K* 27 2700K 30 3000K 35 3500K 40 4000K	20 20° (<13) 30 30° (<13) 40 40° (<10)	NL No Lens 01 Clear Film* (*Required for wet location)	REMODEL RR Remote Remodel	1 0.50" - 1.50"	REMOTE PH1 Forward / Reverse Phase, 2%, 120V SG3 eldoLED, ECOdrive 1%, 0-10V, LOG, 120V-277V SN3 eldoLED, ECOdrive 1%, 0-10V, LIN, 120V-277V EG1 eldoLED, SOLOdrive 0.1% 0-10V, LOG, 120V-277V EN1 eldoLED, SOLOdrive 0.1% 0-10V, LIN, 120V-277V ED1 eldoLED, SOLOdrive 0.1% DALI-2, LOG, 120V-277V LP1 Lutron, Hi-Lume Premier Ecosystem 0.1% Fade to Black, 120V or 277V AS1 / ASR Athena Control eldoLED, SOLOdrive 0.1%, 120V-277V* *Includes Athena Node. Extended lead time, consult factory. ASR includes shunt) CS1 / CSR Casambi Control eldoLED, SOLOdrive 0.1%, 120V-277V* *Includes Casambi Node. Extended lead time, consult factory. CSR includes shunt)

PART NUMBER NOTES

- Fixture ships as e.g., 1RE2FTTGUAU90S15C3540NLRR1SG3
- Housing, driver, trim, and applique ship as one unit



1 SERIES FIXED REMODEL

ACCESSORIES

REPLACEMENT OPTICS

Interchangeable optics accessible through fixture aperture.

- RO-17-20** 20° optic
- RO-17-30** 30° optic
- RO-17-40** 40° optic

REPLACEMENT BAFFLE ASSEMBLY (INCLUDES MEDIA)

ASSEMBLY	SHAPE	RATING	TYPE	BAFFLE	EXTERIOR FINISH	INTERIOR FINISH	MEDIA
RBA			F				
REPLACEMENT BAFFLE ASSEMBLY	1RP Round 1SP Square 1RE Round 1SE Expanded	1 IP20 Dry/Damp 2 IP64 Wet* * (Suction cup provided for aim and focus)	F Fixed	T Trimless* (Required for 1RE/1SE) G Zero Sightline* (1RP/1SP Only)	TG Trimless Gypsum WH White AG Satin Silver AU Cashmere Gold AB Arch. Bronze BB Burnt Bronze BK Black PR Primer CF Custom Finish* *(Consult Factory) *See page 1 for Alumina finish options	WH White AG Satin Silver AU Cashmere Gold BB Burnt Bronze BK Black PR Primer CF Custom Finish* *(Consult Factory) *See page 1 for Alumina finish options	NL No Lens 01 Clear Glass Lens

REPLACEMENT INSTALLATION TOOLS

One included with every six fixtures designated Wet location.

- 01S-TOOL-BAFFLE-REMOVAL** Allows for removal of baffle with Wet location
- 01S-TOOL-ENGINE-INST-REMOVAL** Allows for installation of LED module
- 01S-TOOL-ENGINE-BAFFLE-COMBO** Includes both baffle removal tool and LED module installation tool.

EMERGENCY LIGHTING - REMOTE MOUNT ONLY

During disruption of main power, emergency battery inverter provides temporary 120V or 277V to fixture.

- EMB-S-25-120/277-LEDX** 25 watt max capacity, 120 or 277 VAC 60Hz, Non-Dimmable
- EMB-S-100-120-LEDX** 100 watt max capacity, 120 VAC 60Hz, 0-10V Dimmable
- EMB-S-100-277-LEDX** 100 watt max capacity, 277 VAC 60Hz, 0-10V Dimmable
- EMB-S-250-120/277-LEDX** 250 watt max capacity, 120 or 277 VAC 60Hz, 0-10V Dimmable

***SHUNT REQUIRED FOR USE WITH ATHENA AND CASAMBI CONTROLS, CONSULT FACTORY FOR DETAILS.**

POWDERCOAT FINISHES

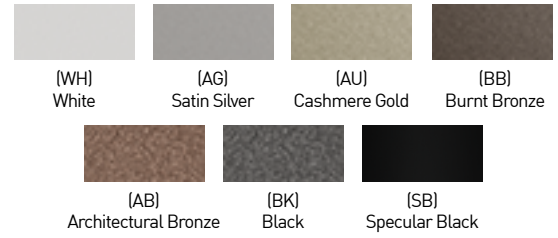

ALUMINA FINISHES BY LUCIFER LIGHTING™



1 SERIES FIXED REMODEL

1RP PERFORMANCE - 3000K - NO LENS

LUMEN PACKAGE	WATTS	20° OPTIC		30° OPTIC		40° OPTIC	
		DLVD	LPW	DLVD	LPW	DLVD	LPW
80S06C	6	223	37	384	64	480	80
80S11C	11	340	31	585	53	731	66
80S15C	15	451	30	777	52	971	65
90S06C	6	193	32	332	55	415	69
90S11C	11	294	27	506	46	632	57
90S15C	15	390	26	672	45	839	56
95S06C	6	139	23	239	40	298	50
95S11C	11	211	19	363	33	454	41
95S15C	15	280	19	483	32	603	40

UNIFIED GLARE RATING

20° OPTIC	30° OPTIC	40° OPTIC
<13	<13	<10

OUTPUT MULTIPLIER

CCT	CCT SCALE
2400K	0.89
2700K	0.98
3000K	1.00
3500K	1.09
4000K	1.14

MEDIA LIGHT LOSS MULTIPLIER

MEDIA	LIGHT LOSS FACTOR
NO LENS	1.00
LENS	0.93

1RE PERFORMANCE - 3000K - NO LENS

LUMEN PACKAGE	WATTS	20° OPTIC		30° OPTIC		40° OPTIC	
		DLVD	LPW	DLVD	LPW	DLVD	LPW
80S06C	6	222	37	393	65	504	84
80S11C	11	338	31	598	54	768	70
80S15C	15	449	30	795	53	970	65
90S06C	6	192	32	340	57	436	73
90S11C	11	292	27	517	47	664	60
90S15C	15	388	26	687	46	839	56
95S06C	6	138	23	244	41	313	52
95S11C	11	210	19	372	34	477	43
95S15C	15	279	19	494	33	611	41

UNIFIED GLARE RATING

20° OPTIC	30° OPTIC	40° OPTIC
<7	<7	<7

FINISH MULTIPLIER

CCT	CCT SCALE
WHITE	1.00
BLACK	0.98
SPECULAR BLACK	0.98

1 SERIES FIXED REMODEL

DOWNLIGHT / HOUSING

A HIGH/LOW WATTAGE REMODEL HOUSING

- For RR installation types.
- IC-rated heatsink, does not have any setback requirements from combustibles and non-combustible materials.
- High wattage housing features 2.00" tall heat sink and is available for 15W packages.
- Low wattage housing features 1.25" tall heat sink and is available for 6W and 11W packages only.

B LIGHT ENGINE

Robust light engine with optimized optic pairing integrates Reflection, Refraction, and TIR offering 20°, 30°, and 40° beams.

C REMODEL MOUNTING PLATE

Installs above ceiling, requiring $\varnothing 6.625"$ cutout. Rectangular design (6.15" x 8.00") allows for installation above ceiling after cutout. Mounting holes align with applique, ensuring secure fixture mounting via factory supplied screws.

D ZERO-SIGHTLINE / TRIMLESS DRYWALL PROFILE

Installs totally flush with the ceiling with no visible trim. Appliqué includes screws for mounting and has 0.06" plaster stop. Not recommended for stucco applications.

E 1" ZERO-SIGHTLINE / TRIMLESS BAFFLE

CNC-Milled removable baffle provides 45° glare cutoff. Minimizes aperture glare and conceals view into housing; includes gasket. Exterior faceplate available in powdercoat, plated, and alumina finishes; interior finish available in powdercoat and alumina finishes. Available in zero-sightline and trimless profiles.

Trimless baffle requires 1.7" square ceiling break for LED/driver servicing.

F 1.6" EXPANDED BAFFLE

CNC-Milled removable baffle provides 46° glare cutoff. Minimizes aperture glare and conceals view into housing; includes gasket. No exterior finish, interior finish available in powdercoat and alumina finishes. Available in trimless profile only.

DIMENSIONS / DRAWINGS

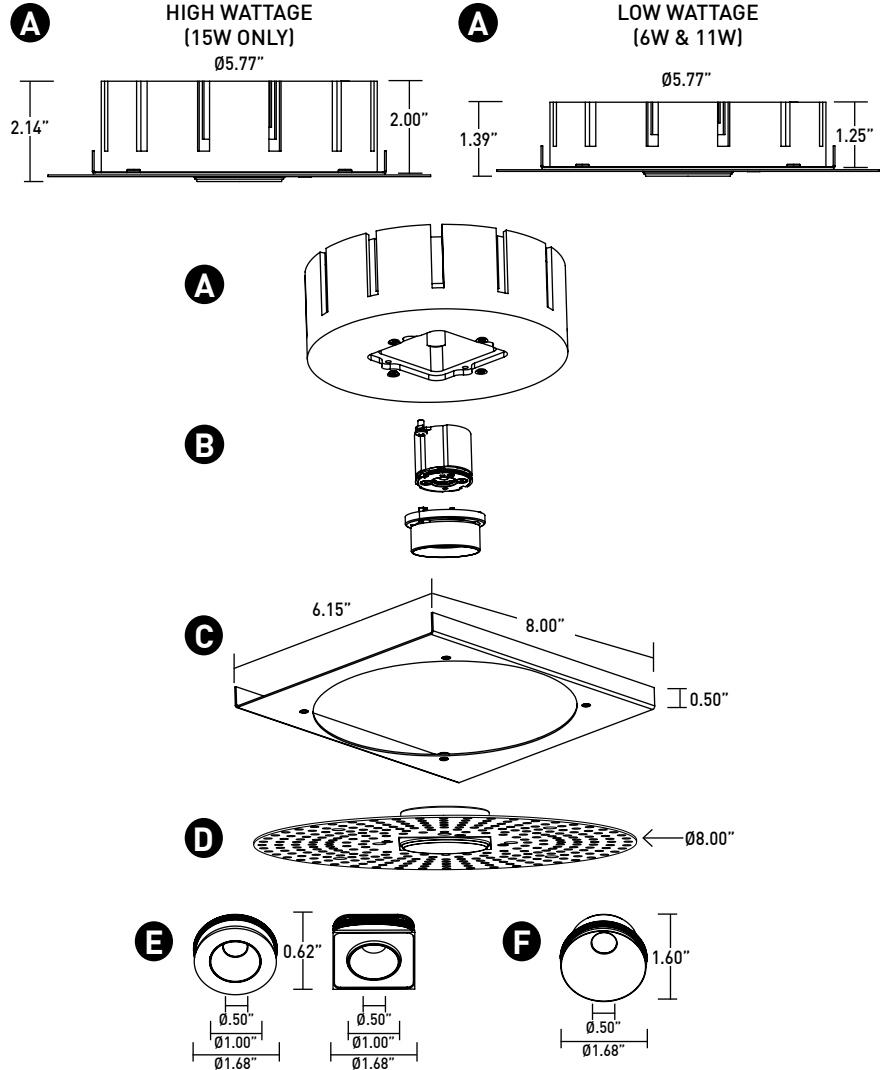

REMODEL NOTES

- Do not install Remodel fixtures in environments where ambient temperatures exceed 40°C (104°F).
- Power supply compartment and all splice connections may be serviced from room side.
- Remodel fixtures accommodate ceiling thicknesses between 0.50" and 1.50".

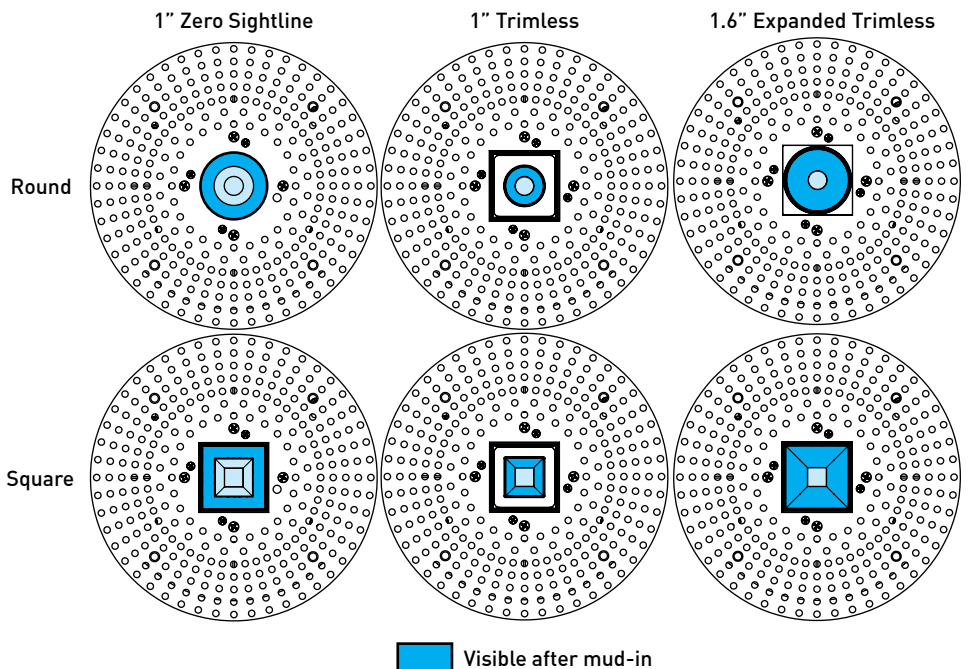

1 SERIES FIXED REMODEL

DOWNLIGHT / HOUSING

G APPLIQUÉ DETAIL

Appliqué for plaster floating directly to baffle.

H REMOTE REMODEL APPLICATIONS

- Remote power supply included with "RR" Install Type
- Requires plenum rated Class 2 cable between fixture and remote driver. Cable supplied by others.
- Remodel junction box provided for connections from remote power supply.
- See page 6 for maximum allowable wiring distances.

I ATHENA / CASAMBI CONTROL

Controls integrated Remote driver assembly. All equipment is serviceable.

Athena Model Numbers: A-WN-D01-RF-BL & DFC-OEM-DBI

Casambi Model Number: BT-S1E1-5400

J ATHENA / CASAMBI EM SHUNT

Included with drivers specified as ASR, ADR, CSR, or CDR. One required for each wireless EM fixture, requires class 2 control wiring between fixture and shunt. Features integrated test switch.

Model Number: PS-RMT-SHUNT

DIMENSIONS / DRAWINGS

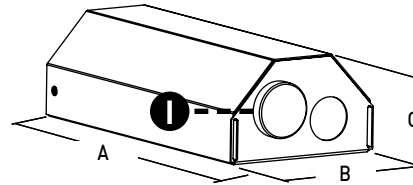
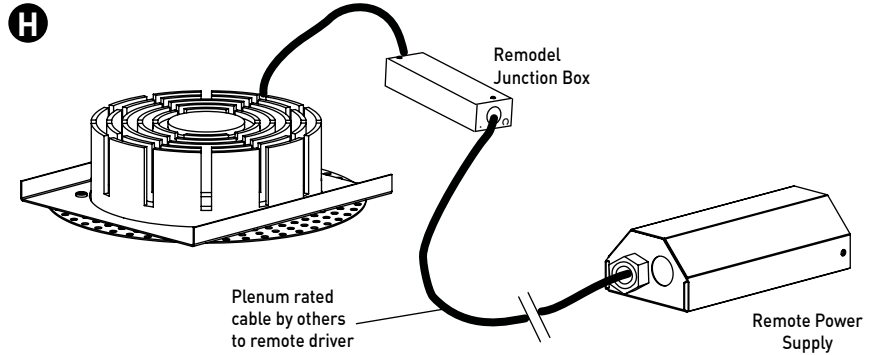
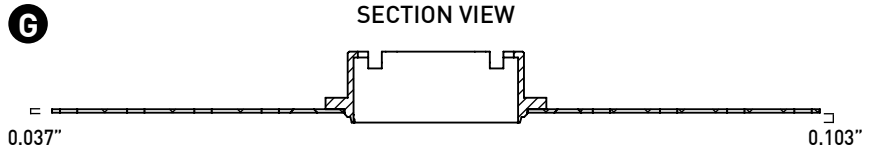

	A	B	C
PHASE / 0-10V / DALI / ECOSYSTEM	6.94"	3.35"	2.00"
ATHENA / CASAMBI	8.10"	5.00"	2.00"

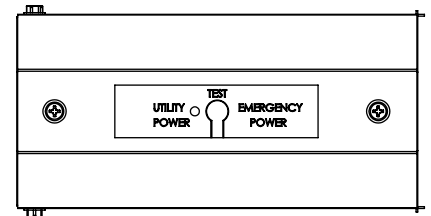
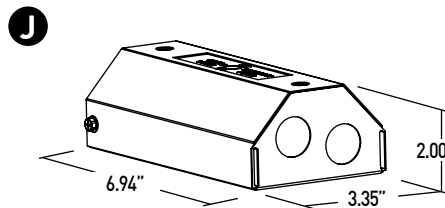

1 SERIES FIXED REMODEL

TECHNICAL

CONSTRUCTION

Downlight: Painted finishes are granulated powder coat; Alumina finishes are anodized aluminum. Plated finishes are plated.

Housing: Aluminum and 22 Gauge galvanized steel. Forged aluminum heat-sink.

Remote Power Supply: 22 Gauge galvanized steel.

Appliqué: Aluminum base with 22 Gauge galvanized steel flange.

STATIC WHITE LED

2-step MacAdam ellipse LED module available in 80+, 90+, and 95+ CRI configurations in color temperatures of 2700K, 3000K, 3500K and 4000K. 3-step MacAdam ellipse LED module available in 90+ CRI configuration in color temperature of 2400K. Average rated lamp life of 50,000 hours. LED and driver assemblies are field-replaceable.

POWER SUPPLY PERFORMANCE AND DIMMING INFORMATION

	PHASE	0-10V				ECO	DALI-2	ATHENA		CASAMBI	
Power Supply	PH1	SG3	SN3	EG1	EN1	LP1	ED1	AS1	AD1	CS1	CD1
Minimum °C	-20 °C	-20 °C	-20 °C	-20 °C	-20 °C	0 °C	-20 °C	0 °C	0 °C	-20 °C	-20 °C
Maximum °C	40 °C	40 °C	40 °C	40 °C	40 °C	40 °C	40 °C	40 °C	40 °C	40 °C	40 °C
Dimming %	2.0%	1.0%	1.0%	0.1%	0.1%	0.1%	0.1%	0.1%	0.1%	0.1%	0.1%

Note: For LP1, EG1 and EN1 drivers consult chart on page 7 to confirm appropriate dimming curve for compatibility with selected control.

MAXIMUM ALLOWABLE REMOTE DRIVER WIRING DISTANCES

DRIVER	WIRE AWG				
	12	14	16	18	20
PH1	285'	180'	113'	71'	45'
LP1	60'	40'	25'	15'	-
EG1, EN1, ED1, SG3, SN3, AS1, CS1, AD1, CD1	-	-	118'	72'	46'

LISTING

Pending listing to UL1598 standard for IP20 Dry / Damp and IP64 Wet locations. NEMA 410 Compliant.

DECLARE

LBC Red List Approved.

BUY AMERICAN ACT

Buy American Act compliant.

WEIGHT

1.25" Remodel Housing - 3 lbs

2.00" Remodel Housing - 4 lbs

Remote Driver - 1.4 lbs

LIMITED WARRANTY

Manufacturer's Limited Warranty guarantees product(s) listed to be free from defects in material and workmanship under normal use and service for 1-year. LED and power supplies are warranted to operate with 70% of original flux and remain within a range of 3 duv for a period of 5-years. 10-year Lutron Advantage limited warranty available on Lutron equipped systems. Warranty period begins from the date of shipment by Seller.



1 SERIES FIXED REMODEL

DIMMING COMPATIBILITY

LUTRON DRIVER COMPATIBILITY

Power supply LP Lutron Product Family	Part No.
PowPak Dimming Modules	RMJ-EC032-DV-B
PowPak Dimming Modules	FCJ/FCJS-ECO
Energi Savr Nodes	QSN-1ECO-S
GRAFIK Eye QS control unit Homeworks QS control unit	QSN-2ECO-S
GRAFIK Eye QS control unit Homeworks QS control unit	QSGRJ- _E (wireless) QSGR- _E
Quantum Hub	QP2- _ _ 2C
Quantum Hub	QP2- _ _ 4C
Quantum Hub	QP2- _ _ 6C
Quantum Hub	QP2- _ _ 8C
Homeworks QS power module myRoom Plus power module	LQSE-2ECO-D



eldoLED DRIVER COMPATIBILITY

Power supply EG/SG Manufacturer	Family/Model #
Busch-Jaeger	2112U-101
Jung	240-10
Leviton Lighting Controls	IP710-DLX
Lightolier Controls	ZP600FAM120
Merten	5729
Pass & Seymour	CD4FB-W
The Watt Stopper	DCLV1
Synergy	ISD BC
Crestron®	GLX-DIMFLV8
Crestron®	GLXP-DIMFLV8
Crestron®	GLPAC-DIMFLV4-*
Crestron®	GLPAC-DIMFLV8-*
Crestron®	GLPP-DIMFLVEX-PM
Crestron®	GLPP-1DIMFLV2EX-PM
Crestron®	GLPP-1DIMFLV3EX-PM
Crestron®	DIN-A08
Crestron®	DIN-4DIMFLV4
Crestron®	CLS-EXP-DIMFLV
Crestron®	CLCI-1DIMFLV2EX
Power supply EN/SN Manufacturer	Family/Model #
Lutron Electronics	Nova T® - NTFTV
Lutron Electronics	Diva® - DDTV
Lutron Electronics	Nova® - NFTV
Lutron Electronics	GrafixEye® GRX-TVI w GRX3503
Lutron Electronics	Energy Savr Node™ - QSN-4T16-S
Lutron Electronics	TVM2 Module
Sensor Switch	nIO EZ
ABB	SD/S 2.16.1

ANALOG DRIVERS AND DIMMERS

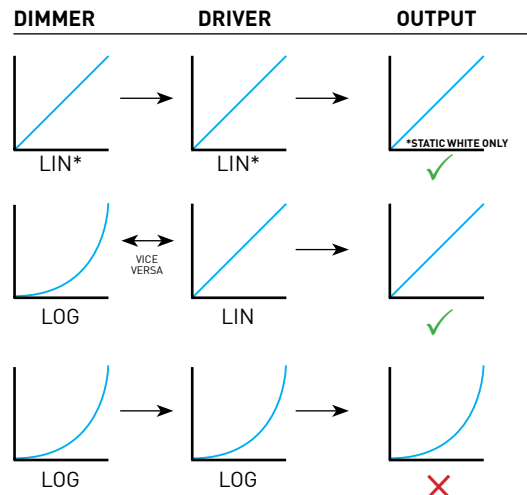

LIN = LINEAR
 LOG = LOGARITHMIC
 *LIN-TO-LIN NOT COMPATIBLE FOR WARM-DIM