

FIBER DOWNLIGHTS™

MACHINED MINIATURE FITTINGS

PROVISIONAL PRODUCT SPECIFICATION

FDL-1 - Pin-Head I

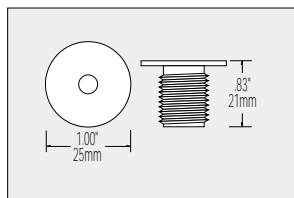

Miniature machined aluminum fitting with flange and threaded body with lock-nut for retaining fitting in position in up to 5/8" panel thickness. Unlensed. Set screw holds fiber in position. Applications: case and cabinet lighting.

FDL-2 - Pin-Head 1

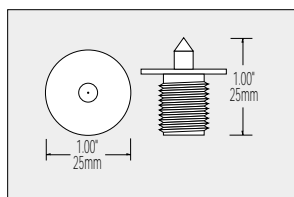

Same fitting as Model FDL-1 with tiny acrylic point. Applications: exterior signage; high star wall/ceiling; water fountains. Note: acrylic point can be ordered separately.

FDL-3 - Pin-Head II

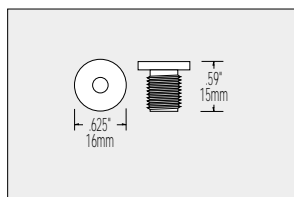

Small machine aluminum fitting with flange and threaded body with lock-nut for retaining fitting in position in up to 5/8" panel thickness. Unlensed. Set screw holds fiber in position. Applications: case and cabinet lighting.

FDL-4 - Pin-Head II

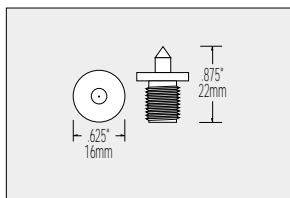

Same fitting as Model FDL-3 with small acrylic point. Applications: exterior signage; star wall/ceiling; water fountains. Specify core diameter and finish. Note: acrylic point can be ordered separately.

FDL-10 - Barrel Head

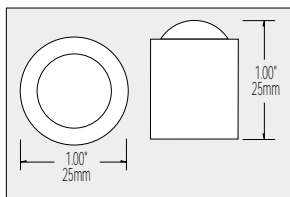

Small smoothly finished barrel fitting machined aluminum without flange. Retention of fitting in mounting medium by friction or adhesion. Lensed with optically ground glass for spot or flood beam. Internal threading provided for retaining glass fiber; set screw holds plastic fiber in position. Applications: case and cabinet lighting; stand alone sculpture with fiber; retrofit fiber light source.

FDL-11 - Bubble Head

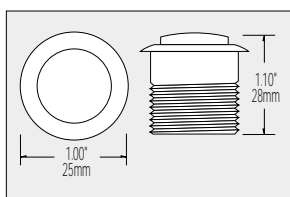

Medium sized machined aluminum fitting with flange and threaded body with lock-nut for retaining fitting in position in up to 5/8" panel thickness. Lensed with optically ground glass for spot or flood beam. Set screw holds fiber in position. Applications: case and cabinet lighting and architectural access lighting where access behind panel available during mounting.

FDL-12 - Eyeball

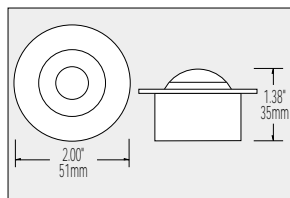

Medium sized machined eyeball downlight. Fully rotatable unit turning 45 degrees in all directions. Lensed with optically ground glass for spot or flood beam. Spherical glass holder protrudes slightly. Spring clips retain downlight in position in up to 5/8" panel thickness. Internal threading provided for retaining glass fibers; set screw holds plastic fiber in position. Applications: case and cabinet lighting; display lighting; wall and ceiling uplighting and downlighting.

FDL-13 - Top Hat I

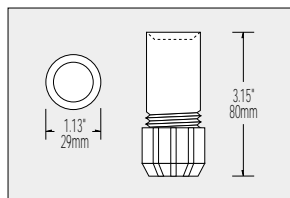

Medium sized machined flangeless fitting with threaded body and collar for locking fitting in position in up to 2" panel thickness. Compression fitting holds fiber in position. Lensed with optically ground glass for spot or flood beam. Applications: recessed wall and ceiling accent lighting where access behind panel available during mounting.

FDL-14 - Top Hat II

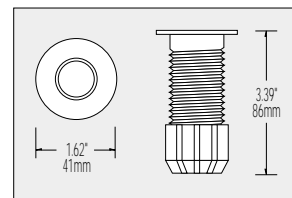

Same fitting as Model FDL-13 except fitting provided with narrow flange for flush retention against panel. Applications: recessed wall and ceiling accent lighting where access behind panel available during mounting.

FDL-15 - Top Hat III

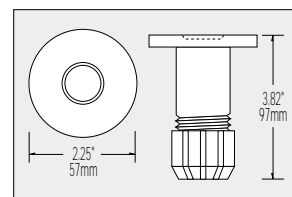

Same fitting as Model FDL-13 except fitting provided with wide flange and outside threaded escutcheon for concealing screw mounting of fitting against panel. Applications: same as Model FDL-13 except that fitting may be secured without access from behind panel.

FDL-16 - Top Hat IV

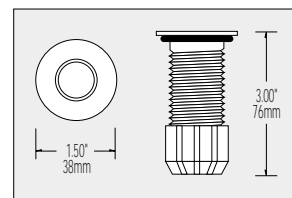

Same fitting as Model FDL-14, with wider flange, in stainless steel, sealed and gasketed for use under water to depth of five feet. Applications: spas, pools and water features.

LUCIFER
LIGHTING COMPANY

414 Live Oak Street
San Antonio, Texas 78202
Phone 210 227-7329
FAX 210 227-4967

©1998 Lucifer Lighting Company

As part of its policy of continuous research and product development, the Company reserves the right to change or withdraw specifications without prior notice.

FIBER DOWNLIGHTS™

MACHINED MINIATURE FITTINGS

GENERAL DESCRIPTION

Fiber Downlights are miniature, machined fiber optic fittings which accept glass or plastic end-emitting fiber optic cable for up/down/side lighting applications.

MOUNTING

Each fitting is machined at the factory to receive fiber optic cable of a prescribed diameter. To specify fitting model it is necessary to indicate the acceptance (core) diameter (see following tables).

MATERIAL

Machined aluminum.

PROVISIONAL PRODUCT SPECIFICATION

LAMPS AND BEAM SPREAD

There is no lamp, electrical ports or wiring in Fiber Downlights other than provision for fiber optic cable (order separately). Lamp illumination provided from remote mounted illuminator source (order separately). Beam spread can be varied by sliding the fiber forward and backward within focusing tube.

FINISH

Available in aluminum, black, bronze, polished chrome, polished brass, satin silver, and white.

Catalog No.	Description					
FDL-1 Pin-Head I	Unlensed machined miniature fitting					
	Core Diameter	S3	S8	S24	S36	S60 S120
		1/16"	1/8"	3/16"	1/4"	3/8" 1/2"
FBGE (Glass)		●	●			
FBPS (Solid Core Plastic)			●			
FBSE (Stranded Plastic)						
FDL-2 Pin-Head I	Unlensed machined miniature fitting with acrylic point					
	Core Diameter	S3	S8	S24	S36	S60 S120
		1/16"	1/8"	3/16"	1/4"	3/8" 1/2"
FBGE (Glass)		●	●			
FBPS (Solid Core Plastic)			●			
FBSE (Stranded Plastic)						
FDL-3 Pin-Head II	Unlensed machined small fitting					
	Core Diameter	S3	S8	S24	S36	S60 S120
		1/16"	1/8"	3/16"	1/4"	3/8" 1/2"
FBGE (Glass)			●	●	●	
FBPS (Solid Core Plastic)			●	●	●	
FBSE (Stranded Plastic)				●		
FDL-4 Pin-Head II	Unlensed machined small fitting with acrylic point					
	Core Diameter	S3	S8	S24	S36	S60 S120
		1/16"	1/8"	3/16"	1/4"	3/8" 1/2"
FBGE (Glass)			●	●	●	
FBPS (Solid Core Plastic)			●	●	●	
FBSE (Stranded Plastic)				●		
FDL-10	Lensed machined fitting, smooth body					
	Core Diameter	S3	S8	S24	S36	S60 S120
		1/16"	1/8"	3/16"	1/4"	3/8" 1/2"
FBGE (Glass)			●	●	●	
FBPS (Solid Core Plastic)			●	●	●	
FBSE (Stranded Plastic)				●	●	

Catalog No.	Description					
FDL-11	Lensed machined fitting, threaded body					
	Core Diameter	S8	S24	S36	S60	S/96 S120
		1/8"	3/16"	1/4"	3/8"	7/16" 1/2"
FBGE (Glass)		●	●	●		
FBPS (Solid Core Plastic)		●	●	●	●	●
FBSE (Stranded Plastic)				●	●	●
FDL-12	Eyeball machined lensed fitting					
	Core Diameter	S8	S24	S36	S60	S/96 S120
		1/8"	3/16"	1/4"	3/8"	7/16" 1/2"
FBGE (Glass)		●	●	●		
FBPS (Solid Core Plastic)		●	●	●	●	●
FBSE (Stranded Plastic)				●	●	●
FDL-13	Lensed machined flangeless fitting, threaded body					
	Core Diameter	S8	S24	S36	S60	S/96 S120
		1/8"	3/16"	1/4"	3/8"	7/16" 1/2"
FBGE (Glass)		●	●	●		
FBPS (Solid Core Plastic)		●	●	●	●	●
FBSE (Stranded Plastic)				●	●	●
FDL-14	Lensed machined flanged, large aluminum fitting, threaded body					
	Core Diameter	S8	S24	S36	S60	S/96 S120
		1/8"	3/16"	1/4"	3/8"	7/16" 1/2"
FBGE (Glass)		●	●	●		
FBPS (Solid Core Plastic)		●	●	●	●	●
FBSE (Stranded Plastic)				●	●	●
FDL-15	Lensed machined large flanged fitting, threaded body					
	Core Diameter	S8	S24	S36	S60	S/96 S120
		1/8"	3/16"	1/4"	3/8"	7/16" 1/2"
FBGE (Glass)		●	●	●		
FBPS (Solid Core Plastic)		●	●	●	●	●
FBSE (Stranded Plastic)				●	●	●
FDL-16	Lensed machined under water fitting, threaded body					
	Core Diameter	S8	S24	S36	S60	S/96 S120
		1/8"	3/16"	1/4"	3/8"	7/16" 1/2"
FBGE (Glass)		●	●	●		
FBPS (Solid Core Plastic)		●	●	●	●	●
FBSE (Stranded Plastic)				●	●	●